

CERTIFIED LAND CORNER RESTORATION

State of Wisconsin }
County of Oneida } ss.

I David F. Mc Mullen, do hereby certify that on the 17 day of September, 1981, I found evidence of the meander corner S. of Maud L. corner of on the W. line of Sec. 24 Township 37 North, Range 7 East, Fourth Principal Meridian, as described hereon; and that from this evidence I established a new monument and accessories as described hereon to perpetuate the original location of this corner:

Description of original monument and accessories and subsequent restorations:

Meander post set (November 1862 - Jos. H. Jenkins)
Bearing trees: White Pine 15"; S20°W, 19lks
White Pine 8"; S25°E, 21lks

Description of corner evidence found:

Wood post w/metal tag
Bearing trees: 18" Norway Pine; S61°W, 21.62'
20" White Pine; S41°E, 8.40'

Description of monument and accessories I established to perpetuate the location of this corner:

Set Oneida County Berntsen cast aluminum monument
Made bearing trees: 18" White Pine; S89°E, 24.30'
7" White Birch; N43°E, 2.65'

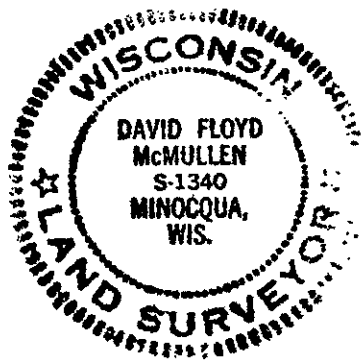

Resident witnesses.....

Dated at Minocqua Wisconsin, this 11 day of Jan 1982

Signature David F. Mc Mullen Title Registered Land Surveyor
(County Surveyor, Registered Land Surveyor, or other duly authorized official)

Surveyors Registration No. S - 1340

Office of REGISTER OF DEEDS County of Oneida

I hereby certify that the within instrument was filed in this office for record on the 17th day of September 1982, and was filed in Book No. Page No. of County Records.

Signature Lois Verage Kuehn Title REGISTER OF DEEDS

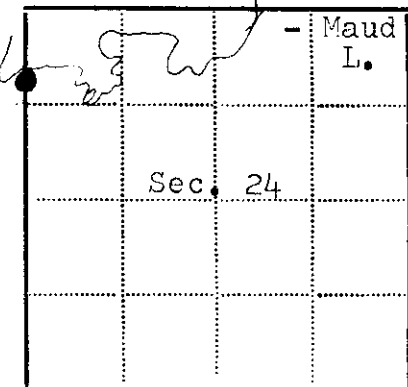

● - Corner monument restored
□ -

Township 37 North, Range 7 East, Section 24, Index No., Page No.

3707233400

0-21

U.S. PUBLIC LAND SURVEY MONUMENT RECORD

REGISTER OF DEEDS OFFICE
ONEIDA COUNTY
FILED

Note: This form is intended and designed to fulfill all requirements of the Wisconsin Administrative Code, Chapter A-E 7.08 U.S. Public Land Monument Record (3)(a)(b)(c)(d)(e)(f)(g)(h)(i). An additional sheet may be added if necessary to conform with said requirements.

NOV 14 2022

KYLE J. FRANSON
REGISTER OF DEEDS

(a) CORNER LOCATION:

Meander Corner on west line of Section 24 North:
Township 37 North East:
Range 7 East Datum: NAD
Town of Casian GNSS Method:
County of Oneida GNSS Control:

(RECORDING AREA)

SECTION 24

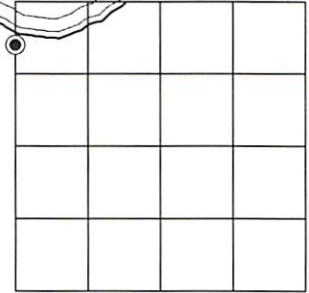

(b) HISTORY OF ORIGINAL CORNER ESTABLISHMENT

Original Surveyor:
Date of Survey: Commenced
Completed
Original B.T.'S

SEE PREVIOUS U.S.P.L.S. MONUMENT
RECORD DATED SEPTEMBER 17, 1982

(f)(g)(h) DESCRIPTION OF MONUMENT FOUND AT THIS CORNER AND IF IT WAS ACCEPTED, STATE ALL EVIDENCE (MATERIAL, TESTIMONIAL, OCCUPATIONAL, PLATS, RECORD, OTHER MONUMENTS) USED AS A BASIS FOR ESTABLISHING LOCATION. IF NOT ACCEPTED OR IF NOTHING WAS FOUND, STATE EVIDENCE USED AS BASIS FOR ESTABLISHING LOCATION. IF REESTABLISHED THROUGH LOST CORNER PROPORTIONATE METHODS, INDICATE ALL MONUMENTS, DISTANCES AND DIRECTIONS USED TO ESTABLISH. INDICATE TYPE OF MONUMENT AND SIGN POST FOUND OR SET.

This is a perpetuation of a previous U.S.P.L.S. Monument Record by David F. McMullen, RLS, dated September 17, 1982 and filed in the office of the Oneida County Register of Deeds. A complete history of the corner can be found on the previous monument record.

October 28, 2022, James D. Rein, PLS No. S-1234, we found and I accepted, the Oneida County, capped, 2.4" dia. aluminum monument set by McMullen in 1982. Three of the previous white pines and northeasterly white birch are now gone or disturbed. See below for updated references.

I accept the previous location as a true and faithful perpetuation or reestablishment of the original corner location and further perpetuate it as follows.

(c)(d)(e) PLAN VIEW OF CORNER WITH TIES TO AT LEAST 4 WITNESS MONUMENTS. IF IN DISAGREEMENT WITH PREVIOUSLY ESTABLISHED CORNER, SHOW THE DISTANCE BETWEEN THE TWO CORNERS AND ALSO INDICATE THE TIES TO THE DISPUTED CORNER.

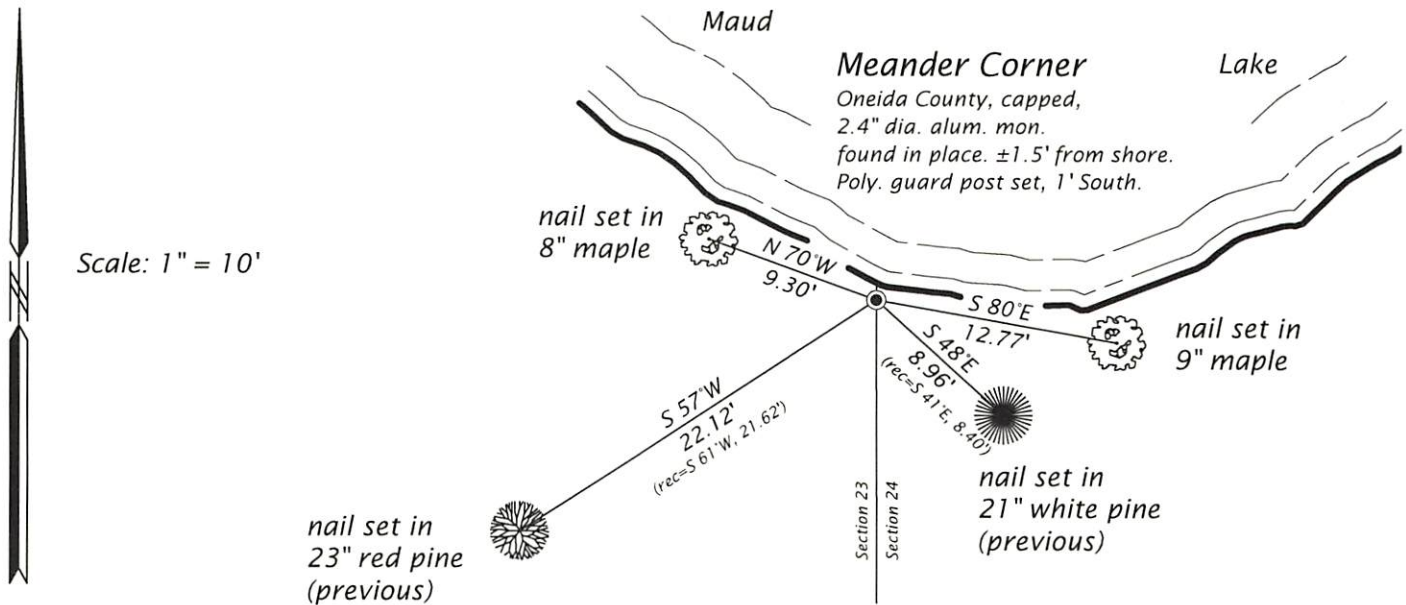

(i) I, JAMES D. REIN, PROFESSIONAL LAND SURVEYOR NO. S-1234 HEREBY CERTIFY THAT THE CORNER LOCATION ON THIS RECORD WAS DETERMINED BY ME OR UNDER MY DIRECTION AND CONTROL AND THAT THIS U.S. PUBLIC LAND SURVEY MONUMENT RECORD IS CORRECT AND COMPLETE TO THE BEST OF MY KNOWLEDGE AND BELIEF.



James D. Rein 11/04/22
SIGNATURE DATE

INDEX NO. 0 - 21

3707233400