

CERTIFIED LAND CORNER RESTORATION

Index No. J-23

State of Wisconsin }
County of Oneida } ss.

I, Philip T. Hansen, do hereby certify that on the 28th day of April, 1977, I found evidence of the Quarter corner of Section 12 & 13 Township 27, North, Range 8 East, Fourth Principal Meridian, as described hereon; and that from this evidence I established a new monument and accessories as described hereon to perpetuate the original location of this corner.

Resident witnesses:

Jim Claflin

Herb Wagoner

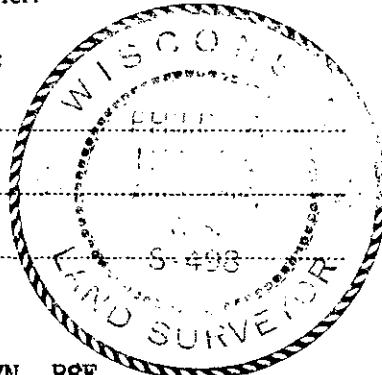

History of original corner establishment:

Original Corner established by Wm. E. Dougherty, Deputy Surveyor, in 1863, from which Birch 10" bears N39°W, 21 links and Birch 12" bears S36°W, 18 links.

Corner re-established by N. Loftus, Ripco Surveyor, in 1960. Ran a random line S 89° 00' E from the SW Section Corner 84.61 chains to close out 1.45 chains south of the SE corner.

Corrected bearing S 89° 59' E.

Set 1/4 corner at 42.30½ chains intermediate.

Marked NBTs - Red Maple 3" S40°E, 6 links.

White Birch 4" N 1° E, 19½ links.

Description of corner evidence found:

Recovered 2" iron pipe with 4" square brass cap in excellent condition and securely in ground. Cap stamped:

Monument projects 14" above ground.

Recovered OBTs - Red Maple 3" (6") S40°E, 6 links.

White Birch 4" (7") N 1° E, 19.5 links.

Scribing on both trees visible, but not legible.

T37N R8E
1/4 S+12
S+13
RIPCO

Description of monument and accessories I established to perpetuate the original location of this corner.

As the monument was recovered in excellent condition, it was left in place.

Marked NBT - Maple 8" S29°W, 20.7 links, scribed 1/4 BT.

FORM 985 Wisconsin Surveyors' Liability Co. Incorporated, Wisconsin

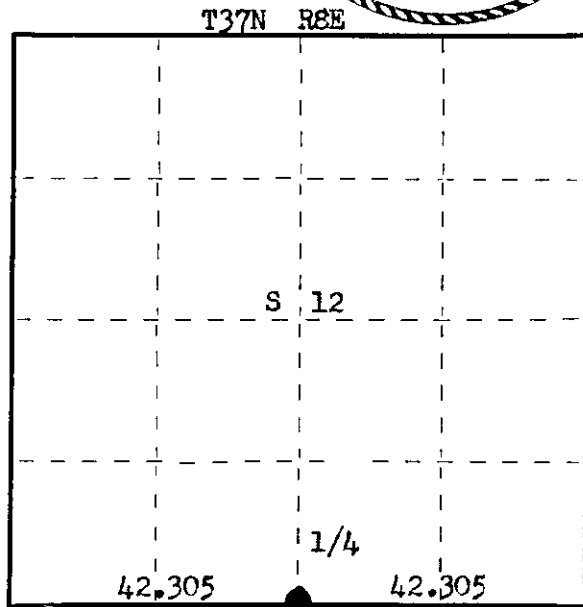

○ = Corner monument restored.

Dated at Rhineland, Wis., this 5th day of May, 1977

Signature Philip T. Hansen Title Registered Land Surveyor Registration No. S-498
(County Surveyor, Registered Land Surveyor, or other duly authorized official)

Office of Register of Deeds, County of Oneida, I hereby certify that the within instrument was filed in this office for record on the 6th day of May, 1977 at 1:20 o'clock P. M.

Louis Terage Kuehn
(Register of Deeds)

By.....Deputy

3708/20020

U.S. PUBLIC LAND SURVEY MONUMENT RECORD

Note: This form is intended and designed to fulfill all requirements of Wisconsin Administrative Code, Chapter A-E 7.08 U.S. Public Land Survey Monument Record (3)(a-i).

(a) CORNER LOCATION
 1/4 Cor. of Secs. 12 & 13
 Township 37 North
 Range 8 East of the 4th P.M.
 Town of Pine Lake
 County of Oneida

WISCRS - Oneida County
 N: 188,769.56 USft
 E: 257,339.61 USft
 Datum: NAD 83(2011) ep. 2010.00
 GNSS Method: RTN - Direct
 GNSS Control: WISCORS VRS

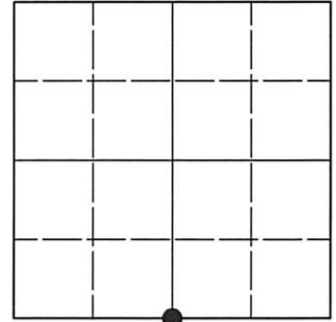

Sec. 12, T. 37 N., R. 8 E.

(b)(f)(g)(h) Description of monument found at this corner and if it was accepted, state all evidence (material, testimonial, occupational, plats, records, other monuments) used as a basis for accepting. If not accepted or if nothing was found, state evidence used as basis for establishing location. If re-established through lost corner proportionate methods, indicate all monuments, distances and directions used to establish. Indicate type of monument and sign post found or set.

This record is a perpetuation of the following land corner document(s):

May 5, 1977: Certified Land Corner Restoration by Philip T. Hansen, filed in Oneida County

A complete history of the corner can be found on the previous land corner document(s). I accept the record activity as a true and faithful perpetuation or reestablishment of the original corner location and further perpetuate it as described below.

June 23, 2023: I found and accepted the record monument, a 2.4" diam. iron pipe, firmly set, with a 4.0" sq. RIPCO brass plate projecting 16" above the ground surface. The record bearing tree at S40°E is down. I found or established accessories as indicated below. I set a white vinyl sign post bearing SE, 1.1 ft.

The coordinate value shown is the weighted mean of two or more GNSS observations at markedly different times satisfying the accuracy requirements defined and qualified in the 2022 Oneida County Fee Schedule for USPLS Corners.

REGISTER OF DEEDS OFFICE
 ONEIDA COUNTY
 FILED

JUL 06 2023

KYLE J. FRANSON
 REGISTER OF DEEDS

(c)(d)(e) Plan view of corner with ties to at least 4 witness monuments. If in disagreement with previously established corner, show the distances between the two corners and also indicate the ties to the disputed.

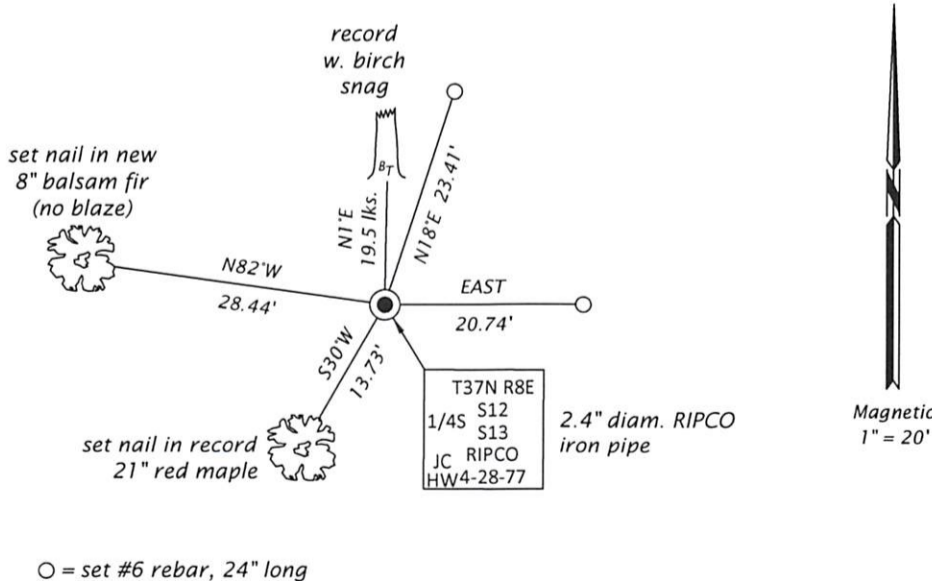

(i) I, Jeffrey W. Austin, Professional Land Surveyor No. S-1885, hereby certify that the corner location on this record was determined by me or under my direction and control and that this U.S. Public Land Survey Monument Record is correct and complete to the best of my knowledge and belief.

[Handwritten Signature]
 Signature

JULY 1, 2023
 Date