

CERTIFIED LAND CORNER RESTORATION

Index No. **D-21**

State of Wisconsin

County of **Oneida**

ss.

I **Phillip T. Hansen**

certify that on the **3rd** day of **December**, 19 **76**, I found

evidence of the **S 1/16** corner of **Section 1 & 2**

Township **37**, North, Range **9 East**, Fourth Principal Meridian,

as described hereon; and that from this evidence I established a new monument and accessories as described hereon to perpetuate the original location of this corner.

Resident witnesses:

Jln Claflin

Herb Wagoner

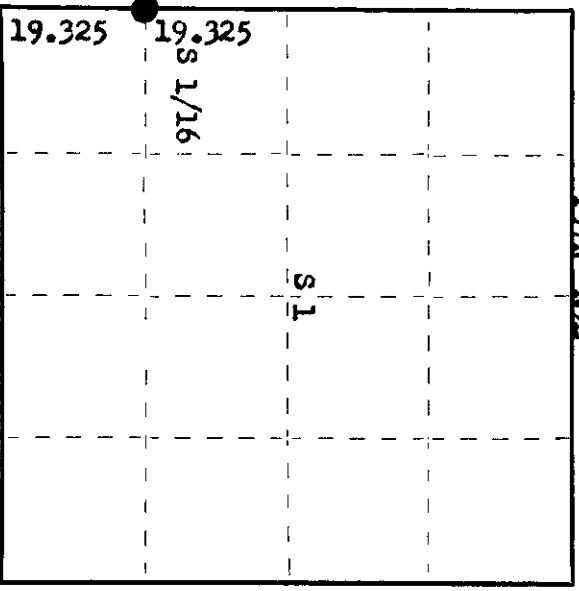
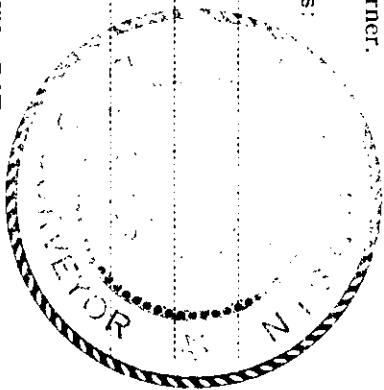

○ = Corner monument restored.

CERTIFIED LAND CORNER RESTORATION

History of original corner establishment:

Corner re-established by N. Loftus, Ripco Surveyor, in 1956. Ran random line N 4° W 73.99 chains. This coincides with Dorris chainage. Set iron pipe at 19.325 chains equidistant to 1/4 corner.

Description of corner evidence found:

Recovered 1" OD iron pipe with 2" brass cap (square). Pipe in good condition and securely in ground. Cap stamped:

Recovered OBT - Jack Pine 5" (6") S 72° W 1.35 chains, scribed 1/16 BT.

S 1/16
S2 1/16
RIPCO

Description of monument and accessories I established to perpetuate the original location of this corner.

As monument was recovered in good condition, it was left in place.

Monument projects 20" above ground.

Added T37N R9E to stamping on cap.

NBT - Jack Pine 6" N 36° E 85.0 links, scribed 1/16 BT.

All distances measured to center of trees.

Dated at **Rhinelander**, Wis., this **22nd** day of **December**, 19 **76**

Signature **Phillip T. Hansen** Title **Registered Land Surveyor** Registration No. **3-498**
(County Surveyor, Registered Land Surveyor, or other duly authorized official)

Office of Register of Deeds, County of **Oneida**, I hereby certify that the within instrument was filed in this office for record on the **1st** day of **February**, 19 **77** at **10** o'clock **A**. M.

Dorris Loftus
(Register of Deeds)

By **Angela M. Bremer** Deputy

3709021000