

CERTIFIED LAND CORNER RESTORATION

Index No. B-21

State of Wisconsin

County of Oneida } ss.

I, Philip T. Hansen, do hereby certify that on the 9th day of December, 19 76, I found evidence of the N 1/16 corner of Sections 1 and 2 Township 37, North, Range 9 East, Fourth Principal Meridian, as described hereon; and that from this evidence I established a new monument and accessories as described hereon to perpetuate the original location of this corner.

Resident witnesses:

Jim Claffin

Herb Wagoner

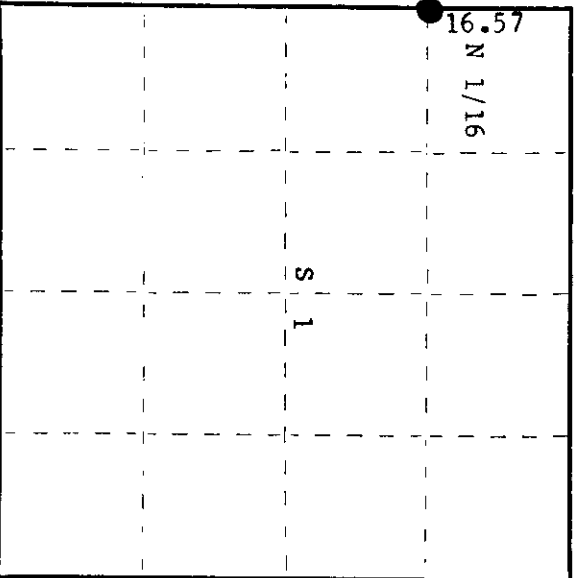
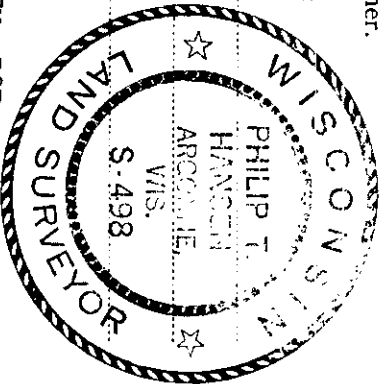

○ = Corner monument restored.

History of original corner establishment:

Corner established by N. Loftus, Ripco surveyor, in 1955. Ran random line south 2° 29' E from section corners 35, 36, 1 and 2, 16.57 chains, Dorr's chainage to set N 1/16 corner. Closed out on SW section corner 7-1/4 links east. Set iron pipe at N 1/16 corner and marked NBT's - Jack Pine 10" S15°E 1.77 chains
Red Pine 13" N18°E 1.45 chains

Description of corner evidence found:

Recovered 1" iron pipe with 2" square brass cap in good condition.
Recovered OBT's - Jack Pine 10" (18") S15°E 1.77 chains, scribing not legible.
Red Pine 13" (20") N18°E (N32°E) 1.45 chains, scribing partially legible.

Cap stamped:
Monument projects 12" above ground.

T37N R9E
N 1/16
S2 1/2 S1
RIPCO

Description of monument and accessories I established to perpetuate the original location of this corner.

Left monument in place as recovered.
Marked NBT's - Red Pine 8" N11°E 18.0 links
Red Pine 8" N86°W 30.3 links
both scribed 1/16 BT.

Dated at Rhinelander, Wis., this 22nd day of January, 19 80.

Signature Philip T. Hansen Title Registered Land Surveyor Registration No. S-498
(County Surveyor, Registered Land Surveyor, or other duly authorized official)

Office of Register of Deeds, County of Oneida
at 2:15 o'clock P. M. 11th day of February, 19 80
I hereby certify that the within instrument was filed in this office for record on the

Doris Leauge Tucker
(Register of Deeds)

By: _____ Deputy

