

CERTIFIED LAND CORNER RESTORATION

Index No. **C-14**

State of Wisconsin

County of Oneida } ss.

I Phillip T. Hansen, do hereby certify that on the 26th day of April, 1976, I found evidence of the WC 1/16 corner of Section 3

Township 37, North, Range 9 East, Fourth Principal Meridian, as described hereon; and that from this evidence I established a new monument and accessories as described hereon to perpetuate the original location of this corner.

Resident witnesses:
Glen Barker
Jim Garlin
Herb Jagoner

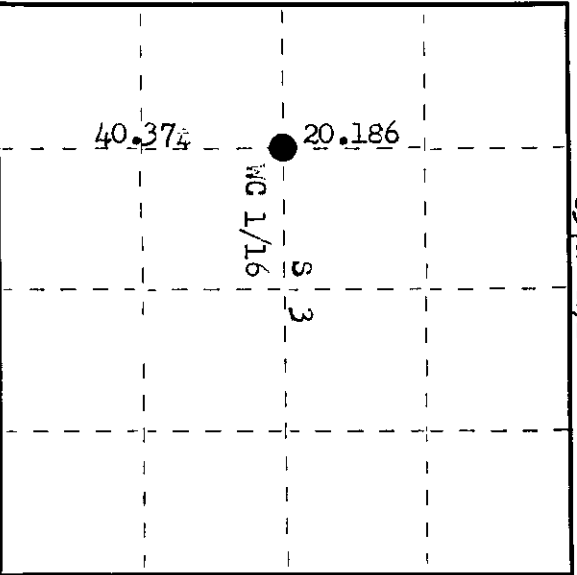
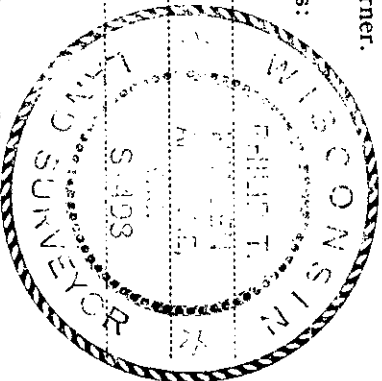

History of original corner establishment:

Corner established by Ripco Surveyor, N. Loftus, in 1958. From established W 1/16 corner between Sec. 3 and 10, ran random line bearing 553° 13' mag. 76.908 chains to pt. 55 1/2 East of W 1/16 north line. Established WC 1/16 at 40.374 chains north and 292 lks west. Set iron pipe with brass cap and marked NBTs - Red Pine 9" S 46° E 85 lks. Red Pine 6" N 58° E 51 1/4 lks.

Description of corner evidence found: Recovered 1" iron pipe with 2" squared brass cap, projecting 12" above ground. Cap stamped. Recovered OBTs, but checking out the distances and bearing it was evident that the corner had been moved. From these bearings and distances, determined correct location.

Corner sets in NW corner of an opening planted with 1' to 8' Red Pine, large red and jack pine plantation to the east.
OBTs - Red Pine 6" (12") N 63° E 51.25 lks, scribing grown over.
Red Pine 9" (12") S 46° E S 40° E 85 lks, scribing partly visible.

Description of monument and accessories I established to perpetuate the original location of this corner. Extracted the corner from its recovered location and reset it to correspond with the calls to BTs recovered. Monument now projects 12" above ground. added T37N R9E to stamping on cap.

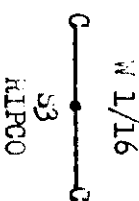

Dated at Rhineland, Wis., this 16th day of August, 1976

Signature: Phillip T. Hansen Title: Registered Land Surveyor Registration No. 5-498
(County Surveyor, Registered Land Surveyor, or other duly authorized official)

Office of Register of Deeds, County of Oneida, I hereby certify that the within instrument was filed in this office for record on the 22nd day of September, 1976 at 100 o'clock P. M.

Doris W. Savage
Register of Deeds

By: _____ Deputy

3709032030