

CERTIFIED LAND CORNER RESTORATION

Index No. **E-13**

State of Wisconsin

County of Oneida } ss.

I Phillip T. Hansen, do hereby certify that on the 7th day of January, 1977, I found evidence of the N 1/16 corner of Section 9 & 10 Township 37, North, Range 9 East, Fourth Principal Meridian,

as described hereon; and that from this evidence I established a new monument and accessories as described hereon to perpetuate the original location of this corner.

Resident witnesses:

Jim Clafin

Herb Wagoner

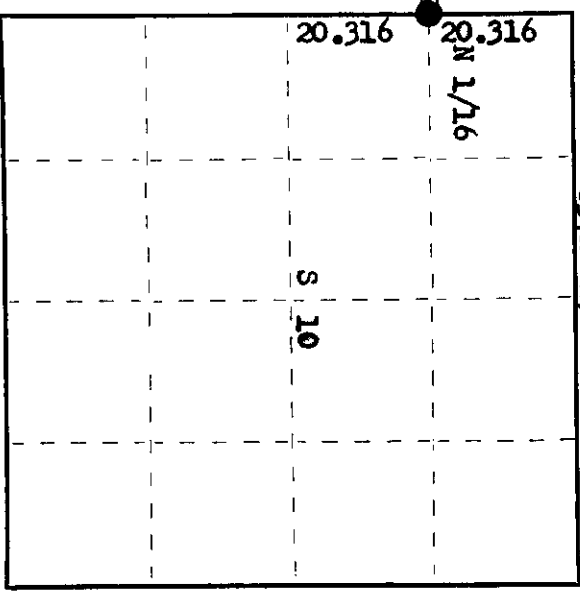
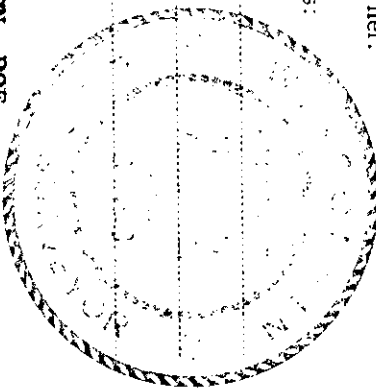

○ = Corner monument restored.

History of original corner establishment:

Corner established by N. Loftus, Ripco Surveyor, in 1958. Ran random line, bearing 181° 50' mag. from Section Corner 3, 4, 9 & 10, 81.52 chains to close out 29 1/2 links west of SW corner. Set corner at 20.316 chains and 7 links east. Marked BTs - Black Spruce 5" N 2° W 26 links and Tamarack 8" N 83° E 27 links.

Description of corner evidence found:

Recovered 1" iron pipe with 2" square brass cap stamped: **T37N R9E**
 Monument recovered in good condition and firmly in ground. **N 1/16 N 1/16**
 Recovered Black Spruce 5" (7") N 2° W 26.0 links, scribing not legible. **S9 S10**
 Tamarack 8" N 83° E 27.0 links scribed N 1/16 (now dead). **RIPCO**

Description of monument and accessories I established to perpetuate the original location of this corner.

As the monument was in good condition, it was left as found.
 Monument projects 24" above ground.
 NBT - White Spruce 6" S 23° W 82.0 links, scribed 1/16 BT.

Dated at Rhineland, Wis., this 18th day of January, 1977.

Signature Phillip T. Hansen Title Registered Land Surveyor Registration No. 54498
 County Surveyor, Registered Land Surveyor, or other duly authorized official

Office of Register of Deeds, County of Oneida I hereby certify that the within instrument was filed in this office for record on the 10th day of February, 1977 at 10:00 o'clock A. M.

Steve Neugebauer
 (Register of Deeds)

By Joseph M. Bremer Deputy

3709093000