

CERTIFIED LAND CORNER RESTORATION

Index No. **E-15**

State of Wisconsin

County of **Oneida** } ss.

I **Phillip R. Hansen** do hereby certify that on the **6th** day of **January**, 19**77**, I found evidence of the **NC 1/16** corner of **Section 10**

Township **37**, North, Range **9 East**, Fourth Principal Meridian,

as described hereon; and that from this evidence I established a new monument and accessories as described hereon to perpetuate the original location of this corner.

Resident witnesses:

Jim Claflin

Herb Wagoner

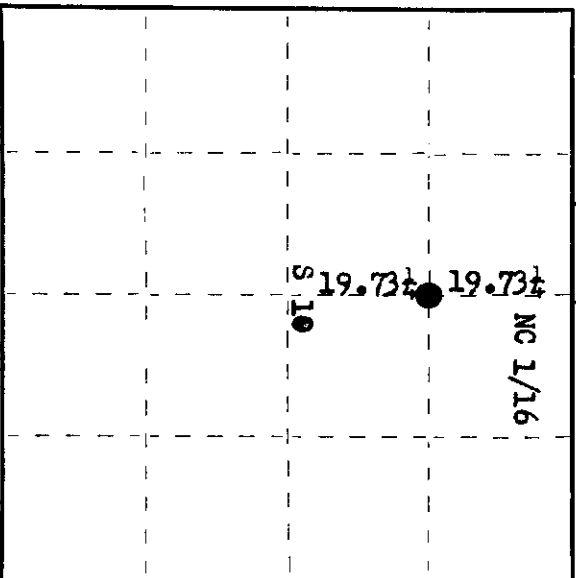
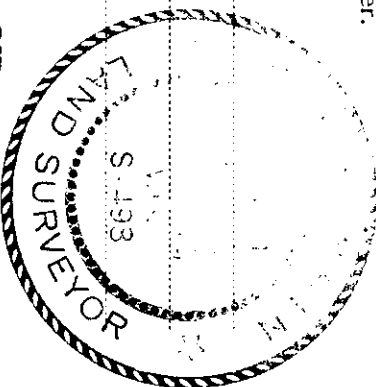

○ = Corner monument restored.

History of original corner establishment:

Corner established by N. Loftus, Ripco Surveyor, in 1958. Ran random line south (180° 50') mag. from N 1/4 corner 78.905 chains to close out 32 links east of S 1/4 corner. Established C 1/4 corner at intersection, E-W 1/4 line at 39.465 chains. Set NC 1/16 at 19.73± chains. Marked NBTs - Cedar 12" S 78° E 1.06 chains and Cedar 3" S 36° E 88 links.

Description of corner evidence found:

Recovered 1" iron pipe with 2" square brass cap stamped:
Recovered OBT - Cedar 12" (16") S 78° E 1.06 chains (1.065 chains) scribed NC 1/16 BT.
Cedar 3" (16") S 36° E 88.0 links, scribing not legible.
Monument found in good condition and firmly in ground.

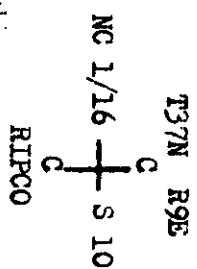

Description of monument and accessories I established to perpetuate the original location of this corner.
As monument was in good condition, it was left as found.
Monument projects 18" above ground.
NBT - Black Spruce 6" N 40° W 47.4 links, scribed 1/16 BT.

Dated at **Rhineland**, Wis., this **17th** day of **January**, 19**77**.

Signature **Phillip R. Hansen** Title **Registered Land Surveyor** Registration No. **S-498**
(County Surveyor, Registered Land Surveyor, or other duly authorized official)

Office of Register of Deeds, County of **Oneida**, I hereby certify that the within instrument was filed in this office for record on the **10th** day of **February**, 19**77** at **10** o'clock **A.** M.

James Neugebauer
(Register of Deeds)

By **James Neugebauer** Deputy

3709103020