

CERTIFIED LAND CORNER RESTORATION

Index No. **F-14**

State of Wisconsin

County of **Oneida**

} ss.

I **Philip T. Hansen**, do hereby certify that on the **7th** day of **January**, 19 **77**, I found evidence of the **NW 1/16** corner of **Section 10**

Township **37** North, Range **9 East**, Fourth Principal Meridian,

as described hereon; and that from this evidence I established a new monument and accessories as described hereon to perpetuate the original location of this corner.

Resident witnesses:

Jim Clarlin

Herb Wagoner

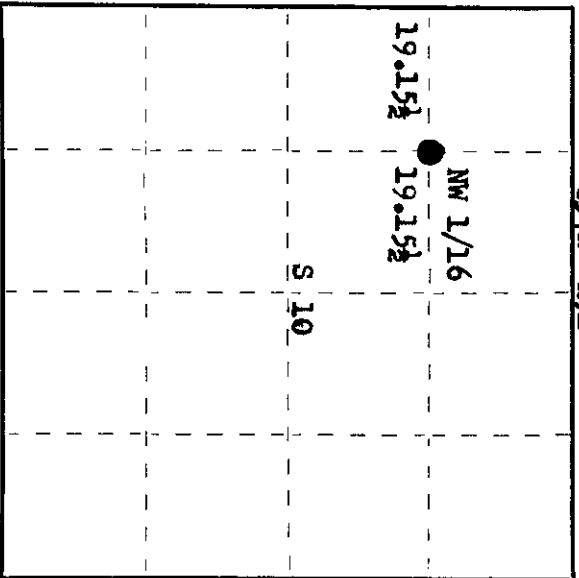
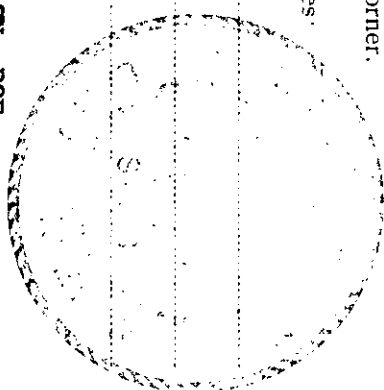

○ = Corner monument restored.

History of original corner establishment:

Corner established by N. Loftus, Ripco Surveyor, in 1958. Ran random line N 85° 44' 11" E from N 1/16, west line 38.31 chains to close out 9 links north of NW 1/16 corner. Set corner at 19.15 1/2 chains, 4 1/2 links south and marked black spruce 5" N 50° E 13 links, black spruce, S 18° W 33-3/4 links. Corrected bearing N 85° 52' 11" E. No control was run from WC 1/16 to W 1/16.

Description of corner evidence found:

- Recovered 1" iron pipe with 2" square brass cap, stamped:
- Recovered Black Spruce 5" (6") N 50° E 13 links, scribed NW 1/16 S10 BT.
- Black Spruce 4" (6") S 18° W 33.75 links (34.5 links)
- Distances measured to center of tree.

T37N R9E
NW 1/16 S10
RIPCO

Description of monument and accessories I established to perpetuate the original location of this corner.
As monument was recovered in good condition, it was left as found.
Monument projects 24" above ground level.
No additional accessories established.

Dated at **Rhineland**, Wis., this **18th** day of **January**, 19 **77**.

Signature **Philip T. Hansen** Title **Registered Land Surveyor** Registration No. **S-498**
County Surveyor, Registered Land Surveyor, or other duly authorized official

Office of Register of Deeds, County of **Oneida**, I hereby certify that the within instrument was filed in this office for record on the **10th** day of **February**, 19 **77** at **10** o'clock **A**. M.

Dana Savage Kuehn
(Register of Deeds)

By **Gayle M. Berman** Deputy

3709 10 30 30