

CERTIFIED LAND CORNER RESTORATION

Index No. L-19

State of Wisconsin } ss.

County of Oneida

I Phillip T. Hansen, do hereby certify that on the 4th day of February, 1977, I found evidence of the C 1/4 corner of Section 14, Township 37, North, Range 9 East, Fourth Principal Meridian, as described hereon; and that from this evidence I established a new monument and accessories as described hereon to perpetuate the original location of this corner.

History of original corner establishment:
Norman Loftus, Ripco Surveyor, recovered a 4 x 4 square post, very old, also 3 cedar stumps marked as BFs with no scribing discernible. Set iron pipe 2" with square brass cap. No record of any BFs established.

Resident witnesses:
Jlm Claflin
Herb Wagoner

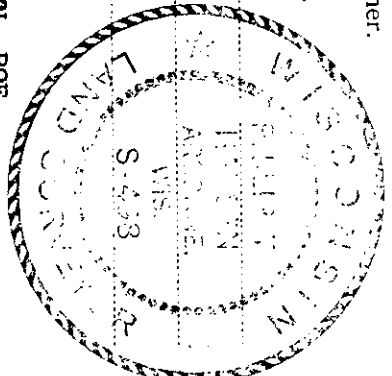

T37N R9E

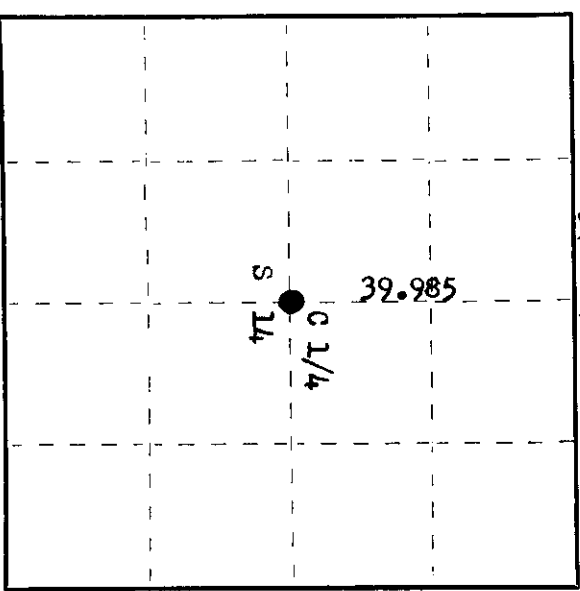

○ = Corner monument restored.

Description of corner evidence found:

Recovered a 2" iron pipe with 4" square brass cap in good condition and securely in ground. Cap stamped:
Recovered BFs - Maple 10" S76°E 36.5 links, scribed C 1/4 BF.
Maple 10" S72°W 14.0 links, scribing not legible.
Monument projects 32" above ground.
T37N R9E
C 1/4

Description of monument and accessories I established to perpetuate the original location of this corner.
As monument was recovered in good condition, it was left in place.
NBF - Cedar 6" S20 E 60.5 links, scribed C 1/4 BF.

Dated at Rhineland, Wis., this 4th day of March, 1977.

Signature Phillip T. Hansen Title Registered Land Surveyor Registration No. S-498
(County Surveyor, Registered Land Surveyor, or other duly authorized official)

Office of Register of Deeds, County of Oneida
Instrument was filed in this office for record on the 23rd day of March, 1977
at 3:00 o'clock P. M.

Terrie Wagoner Kuehn
(Register of Deeds)

By: _____ Deputy

3709142020