

CERTIFIED LAND CORNER RESTORATION

Index No. L-18

State of Wisconsin } ss.
County of Oneida

I Phillip F. Hansen, do hereby certify that on the 11th day of February, 1977, I found evidence of the WC 1/16 corner of Section 14 Township 37 North, Range 9 East, Fourth Principal Meridian,

as described hereon; and that from this evidence I established a new monument and accessories as described hereon to perpetuate the original location of this corner.

Resident witnesses:

Jim Claflin

Herb Wagoner

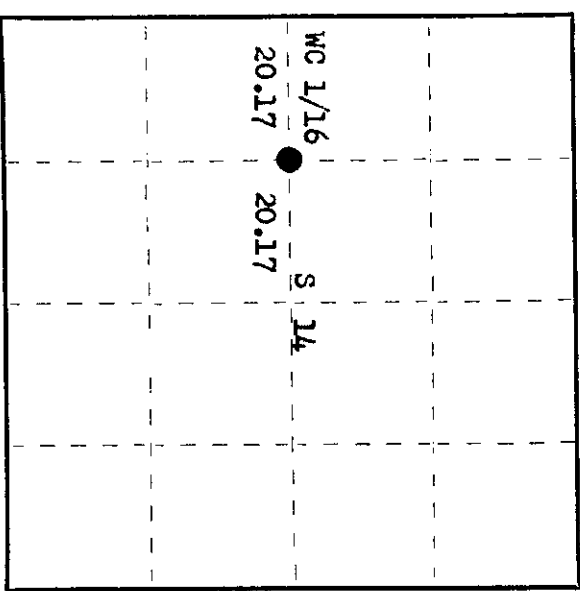
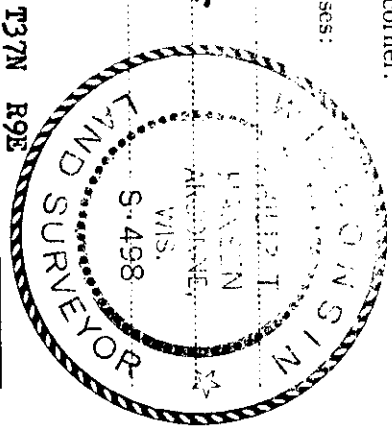

○ = Corner monument restored.

History of original corner establishment:

Corner established by N. Loftus, Ripco Surveyor, in 1955. Ran random line S 89° W from previously established C 1/4, 40.335 chains to close out 78 1/2 links south of W 1/4 corner. Set WC 1/16 at 20.1675 chains intermediate on true line 39 1/2 links north. Set iron post and marked NBTs - Balsam 7" S 15° E 36 links. Corrected line S 89° 50' E.

Description of corner evidence found:

Recovered 1 1/2" iron pipe with 2" square brass cap in good condition and securely in ground. Cap stamped:

Recovered OBT - Balsam 7" (8") S 15° E (S 10° E) 36.0 links (36.6 lks.) WC 1/16
S 14

Description of monument and accessories I established to perpetuate the original location of this corner. As the monument was securely in the ground, it was left in place.

Added T37N R9W to stamping on cap. Monument projects 30" above ground. Marked NBTs - Black Spruce 6" N 74° W 34.2 links. Red Pine 8" S 76° W 50.1 links, both scribed 1/16 BT.

Dated at Rhineland, Wis., this 17th day of March, 1977

Signature Rhineland Title Registered Land Surveyor Registration No. S-498
(County Surveyor, Registered Land Surveyor, or other duly authorized official)

Office of Register of Deeds, County of Oneida I hereby certify that the within instrument was filed in this office for record on the 23rd day of March, 1977 at 3:00 o'clock P. M.

Doris Deering Kuehn
(Register of Deeds)

By Doris Deering Kuehn Deputy

3709142030