

CERTIFIED LAND CORNER RESTORATION

Index No. K-21

State of Wisconsin

County of Oneida

} ss.

I Phillip T. Hansen, do hereby certify that on the 14th day of January, 19 77, I found evidence of the N 1/16 corner of Section 13 & 14

Township 37, North, Range 9 East, Fourth Principal Meridian,

as described hereon; and that from this evidence I established a new monument and accessories as described hereon to perpetuate the original location of this corner.

Resident witnesses:

Jim Claflin

Herb Wagoner

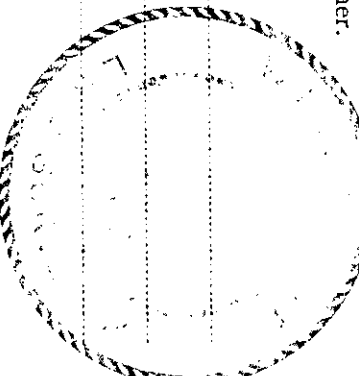

History of original corner establishment:  
Corner established by N. Loftus, Ripco Surveyor, in 1955.  
Ran a random line S 70° W from Section Corner 11, 12, 13 & 14 83.80 chains to close out 30 links west of an old hub in swamp.  
Set the N 1/16 corner at 20.95 chains and 7 1/2 links east. Set iron pipe with 2" brass cap. No record of BTs.

Description of corner evidence found:

Recovered 1 1/4" iron pipe with 2" brass cap in good condition and firmly in ground.  
Recovered OBTs - White Pine 18" S 38° W 36.2 links, scribed N 1/16 BT.  
Black Spruce N 64° W 17.5 links, scribed 1/16 BT.  
Corner sets approximately 1 chain west of Kreb's firelane.

Description of monument and accessories I established to perpetuate the original location of this corner.  
As corner recovered in good condition, added T37N R9E to stamping.  
Monument projects 30" above ground. Cap now stamped:  
No additional accessories established.

T37N R9E  
N 1/16  
S 1/4 S 1/3  
RIPCO

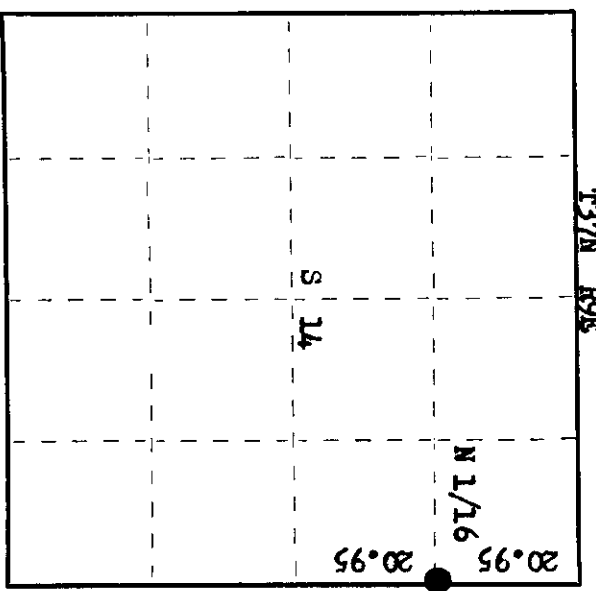

○ = Corner monument restored.

Dated at Rhineland, Wis., this 18th day of January, 19 77.

Signature: Phillip T. Hansen Title Registered Land Surveyor Registration No. S-498  
(County Surveyor, Registered Land Surveyor, or other duly authorized official)

Office of Register of Deeds, County of Oneida  
Instrument was filed in this office for record on the 24th day of February, 19 77,  
at 102 o'clock P. M.

Gene Verage Kuehn  
(Register of Deeds)

By: \_\_\_\_\_ Deputy

3709143000