

CERTIFIED LAND CORNER RESTORATION

Index No. **K-20**

State of Wisconsin } ss.
 County of Oneida

I Phillip T. Hansen, do hereby certify that on the 8th day of February, 1977, I found evidence of the NE 1/16 corner of Section 14, Township 37, North, Range 9 East, Fourth Principal Meridian, as described hereon; and that from this evidence I established a new monument and accessories as described hereon to perpetuate the original location of this corner.

Resident witnesses:
Jim Claflin
Herb Wagoner

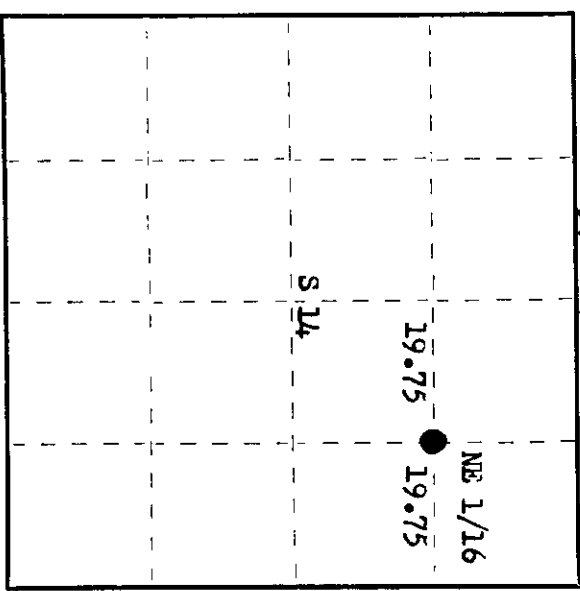
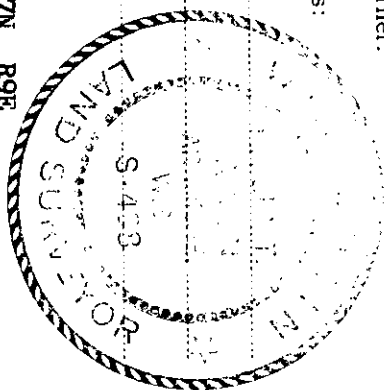

○ = Corner monument restored.

History of original corner establishment:

Corner established by N, Loftus and crew, Ripco Surveyors, in 1955. From established NW 1/16 corner ran N 87° E and at 39.50 chains closed out 1.11 chains North of N 1/16 corner on east line. Set NE 1/16 corner at 19.75 chains on true line. Set a 2" iron pipe.
 Marked BTs - Sugar 11" S60°W 27' and Balsam 5" S 50° E 12', true bearing of line N 88° 36' E.

Description of corner evidence found:

Recovered 1" iron pipe with 2" square brass cap, stamped: **NE 1/16 S14**
 This was in good condition and securely in ground. **RIPCO**
 Also recovered a 3/8" ID iron pipe along side the 1" iron pipe.
 Recovered OBT - Sugar 11" (13") S60°W 27.0 feet, scribed 1/16 BT, 43.7 links.
 Balsam 5" S 50° E 12.0 links, scribed BT., 19.4 links, (now dead).

Description of monument and accessories I established to perpetuate the original location of this corner.
 Added stamping T37N R9E to brass cap.
 Monument projects 24" above ground.
 MBT - Maple 8" N78°W 55.6 links, scribed 1/16 BT.

Dated at Rhineland, Wis., this 4th day of March, 1977.

Signature: Phillip T. Hansen Title Registered Land Surveyor Registration No. 5498
 (County Surveyor, Registered Land Surveyor, or other duly authorized official)

Office of Register of Deeds, County of Oneida
 Instrument was filed in this office for record on the 23rd day of March, 1977
 at 2:00 o'clock P. M.

Terrie Savage Kuehn
 (Register of Deeds)

By: _____ Deputy

3709 14 3010