

CERTIFIED LAND CORNER RESTORATION

Index No. N-14

State of Wisconsin

County of Oneida } ss.

I Phillip T. Hansen, do hereby certify that on the 26th day of June, 19 77, I found evidence of the W 1/16 corner of Section 15 & 22 Township 37, North, Range 9 East, Fourth Principal Meridian, as described hereon; and that from this evidence I established a new monument and accessories as described hereon to perpetuate the original location of this corner.

Resident witnesses:

Jim Clafflin

Herb Wagoner

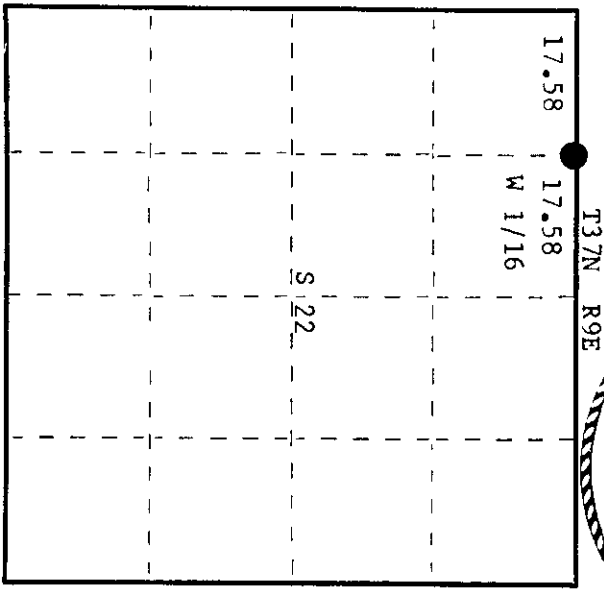
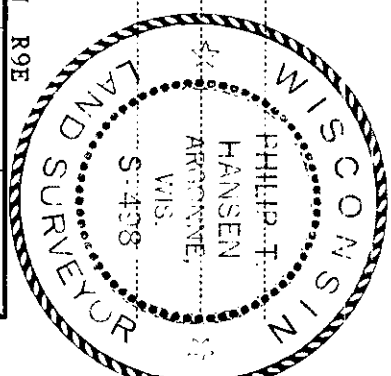

○ = Corner monument restored.

History of original corner establishment:

Original Corner established by V.M. Maine, County Surveyor. Corner recovered by N. Loftus, Ripco Surveyor, in 1957. Recovered Maine's W 1/16 post at 17.58 chains intermediate between Section Corner and N 1/4 corner. Set iron pipe and marked NBTs - Red Pine 6" S59°E, 54 links  
Red Maple 4" S67°W, 19 1/2 links

Description of corner evidence found:

Recovered a 3/4" iron pipe with 2" square brass cap in good condition securely in ground. Recovered OBTs - Red Pine 6" (8") S59°E (S54°E) 55.2 links, scribing not legible. Maple 4" (6") S67°W, 19.5 links.

Cap stamped:

A short 3/4" pipe sets next to the monument.

W 1/16 S15  
S22  
RIPCO

Description of monument and accessories I established to perpetuate the original location of this corner.  
Added stamping T37N R9E to stamping on cap.  
Monument projects 12" above ground.  
No additional accessories established.

Dated at Rhineland, Wis., this 29th day of June, 19 77

Signature: Phillip T. Hansen Title: Registered Land Surveyor Registration No. S-498  
(County Surveyor, Registered Land Surveyor, or other duly authorized official)

Office of Register of Deeds, County of Oneida  
instrument was filed in this office for record on the 8th day of July, 19 77  
at 1:30 o'clock P. M.

Doris Savage Kuel  
(Register of Deeds)

By: Joseph M. Boerner Deputy

3709150030