

CERTIFIED LAND CORNER RESTORATION

Index No. **M-6**

State of Wisconsin

County of Oneida } ss.

I Phillip T. Hansen do hereby certify that on the 22nd day of April, 1976, I found evidence of the SW 1/16 corner of Section 17 Township 37 North, Range 9 East, Fourth Principal Meridian,

as described hereon; and that from this evidence I established a new monument and accessories as described hereon to perpetuate the original location of this corner.

Resident witnesses:

Glen Barker

Jim Clarlin

Herb Wagoner

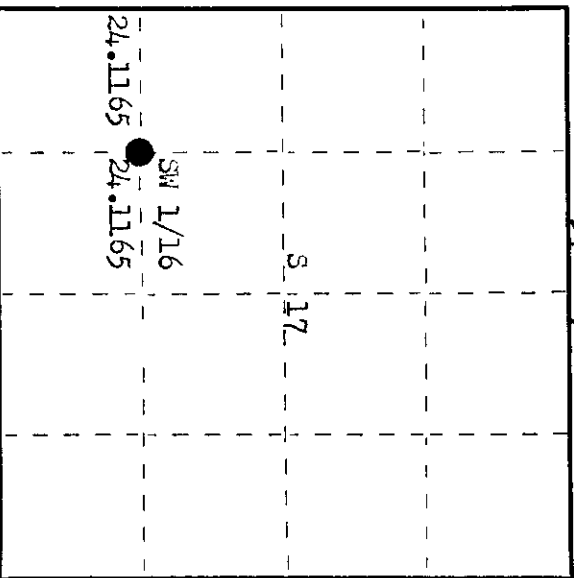
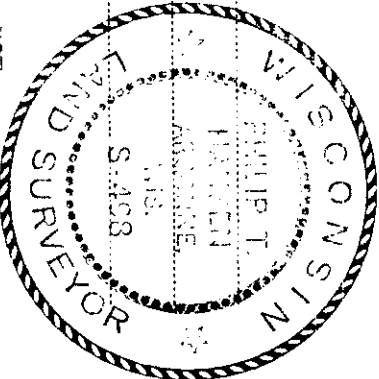

○ = Corner monument restored.

History of original corner establishment: Corner established by Ripco Surveyor, Drivas, in 1960. Ran random line east from south 1/16, bearing N 87° 05' 57" W, 48.23 chains to JO 1/16 Corner. Set SW 1/16 at 24.1165 chains. Marked NBTs - Oak 10" N 50° " 34-3/4 lks, and Oak 6" N 70° " 44 1/2 lks.

Description of corner evidence found: Recovered 1" iron pipe with aluminum cap stamped. Recovered R.Oak 6" N 70° " 44.5 lks, now a cut off stump. R.Oak 10" (14") N 50° " 34.75 lks, scribbing grown over SW 1/16 Ripco Pipe was loose in ground.

Description of monument and accessories I established to perpetuate the original location of this corner. Extracted pipe from ground, installed crossbar and reset in same location. Pipe projects 18" above ground. Added T37N R9E stamping to cap. NBTs - R.Oak 8" N 16° " 43.3 lks, scribed 1/16 BT. Pipe and BTs painted blue.

Dated at Raineland, Wis. this 13th day of July, 1976

Signature Phillip T. Hansen Title Registered Land Surveyor Registration No. 5498
(County Surveyor, Registered Land Surveyor, or other duly authorized official)

Office of Register of Deeds, County of Oneida at 100 o'clock M. day of July 1976
I hereby certify that the within instrument was filed in this office for record on the 23rd day of July, 1976

Doris Verage Kuehn
(Register of Deeds)

By Doris Verage Kuehn Deputy

3709171030