

005
19 OCT 83

U. S. PUBLIC LAND SURVEY MONUMENT RECORD

INSTRUCTIONS:

This record shall show the location of the corner and shall include all of the following nine elements (a through i).

- (a) Identify the corner by reference to the U.S. public land survey system.

● = Corner monument restored.

NORTH 1/4 CORNER
SECTION 30,
TOWNSHIP 37 NORTH,
RANGE 9 EAST,
ONEIDA COUNTY, WISC.

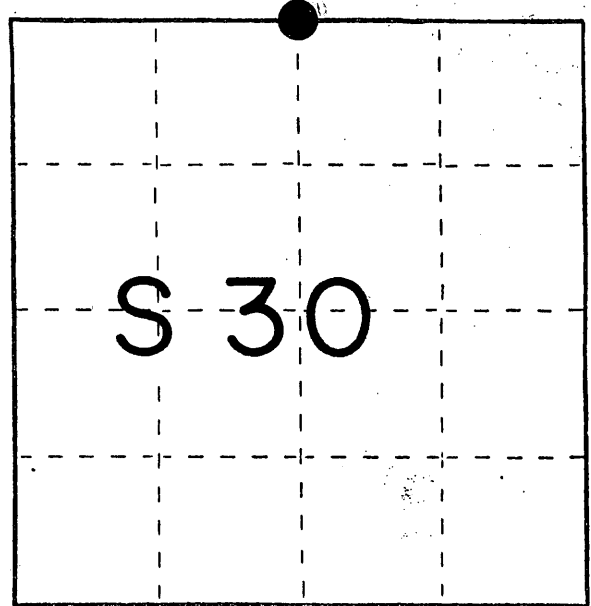

Compared with all record data and accepted as correct.

Robert H. Nival 18 JAN 84
Oneida County Surveyor date

- (b) Describe any record evidence, monument evidence, occupational evidence, testimonial evidence or any other material evidence you considered, and whether the monument was found or placed.

Original corner by Wm. Daugherty in 1865. East between 19 & 30, 42.00 set post. BT's Y Pine 14" N59W 17 lks, Y Pine 14" S29W 8 lks. DH Vaughan at corner March 1909. He found original stumps and set post in fence corner. We check his distance south to C $\frac{1}{2}$. J.C. Kirby at corner in 1966. He found an iron pipe. W.E. Bandow at corner in August 1978. J. Kasson found 1 $\frac{1}{2}$ " iron pipe at corner in Oct., 1982. He made 3 BT's Oak 10" N13W 9.30', N. Pine 13" S17E 10.06', Maple 9" N89W 43.59'. Dist. are to PK nails in face blaze. I found 1 $\frac{1}{2}$ " iron pipe and Kasson's BT's. Made one new BT. Maple 5" N84E 12.52' to 6" spike in approximate center of tree.

- (c) In the plan view drawing below, provide reference ties to at least 4 witness monuments, or, if the location is within a municipality, to at least 2 witness monuments. (Witness monuments shall be made of concrete, natural stone, iron or other equally durable material.) Describe witness monuments.

- (d) Show a plan view drawing depicting the relevant monuments and reference ties which is sufficient in detail to enable accurate relocation of the corner monument if the corner monument is disturbed. Indicate north.

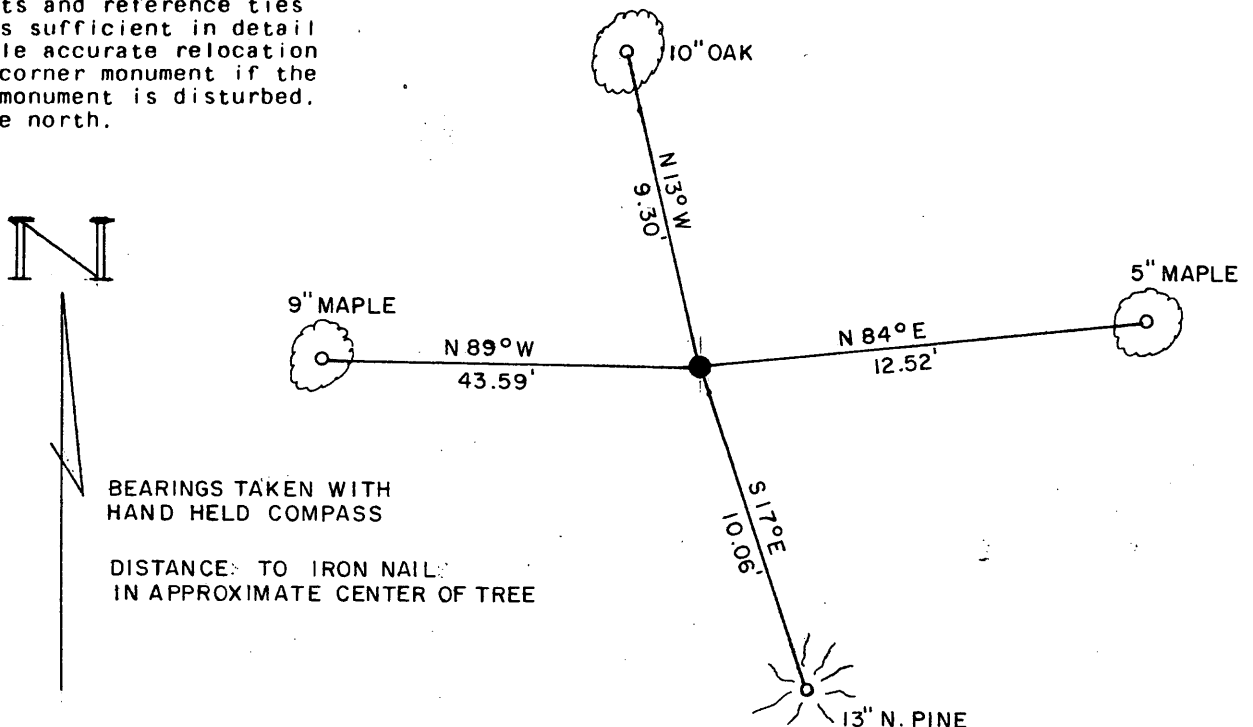

R-3

3709190020

(e) Describe any material discrepancy between the location of the corner as restored or reestablished and the location of that corner as previously restored or reestablished by distance and direction. Show the discrepancy on the plan view drawing under (d), above. Show the distances between the corner as previously restored or reestablished and (1) the corner as restored or reestablished, and (2) to at least 2 of the witness monuments shown on the drawing in (d), above.

NONE

(f) Was the corner restored through acceptance of (1) an obliterated evidence location, or, (2) a found perpetuated location?

Found perpetuated location.

(g&h) Was the corner reestablished through lost corner proportionate methods? If so, show the method, including the directions and distances to other public land survey corners used as evidence or used for proportioning in determining the corner location?

No.

REGISTERS OFFICE }
Oneida County, Wis. }

Received for Record the 18th day of
January A.D. 1984 at
10 o'clock a M. and recorded in
Vol. _____ on page _____
Loris Terge Kuehn
Register



(1) I, William E. Bandow
(type or print name) certify that the corner location shown
on this record was determined by me or under my direction and
control and that this U.S. Public Land Survey Monument Record is
correct and complete to the best of my knowledge and belief.
William E. Bandow 10-18-83
Signature Date

US PUBLIC LAND SURVEY MONUMENT RECORD

Per Wis. Admin. Code § A-E 7.08, a U.S. public land survey monument record shall be prepared and filed with the county survey records as part of any land survey within 60 days of setting or accepting the corner, which includes or requires the perpetuation, restoration, or use of a U.S. public land survey corner and when any of the situations in Wis. Admin. Code § A-E 7.08(1)(a), (b) or (c) arise.

3(a) Corner Identification:

Set Oneida County aluminum monument
South 1/4 corner
Section 19
Township 37 North
Range 9 East
4th Principal Meridian
Town of Pine Lake
Oneida Co., WI

Observed Coordinates:

N: 177751.77
E: 262648.98
Datum: NAD83(2011)
GNSS Control: WISCRS NETWORK
GNSS Method: RTK-Direct
Verification Method: 2

The coordinate value has been verified by at least one of the following methods: 1) comparison to a previously GNSS determined published value; 2) The value is the average of two or more GNSS observations at markedly different times; 3) one or more distances were measured to the corner from temporary GNSS observed offset locations.

**CORNER ID:
3709190020**

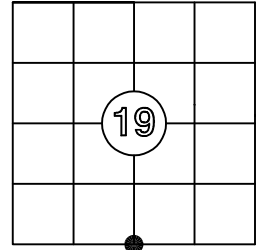

History of Original Corner Establishment

Corner Set: Wood Post
Original Surveyor: Wm. Daugherty
Date of Survey: August, 1863
Yellow pine, 14" N 59° W, 17 links
Yellow pine, 14" S 29° W, 8 links

3(b)((c)(d)(f)(g)(h)

This is a continuation of a previous USPLSS Monument Record by Surveyor William Badow (1983). See previous record for additional history on this corner.

- 10/18/1983 - Bill Badow, S-1182, found a 1 1/2" iron pipe and made one new witness.
- 4/24/2002 - Devon Vanden Heuvel, S-1795, found a 1 1/2" iron pipe.
- 11/2/2006 - David Renaud, S-2142, found a 2" iron pipe.
- 12/2/2025 - I, Anthony Jones, S-2508, found a 1 1/2" (2" outside diameter) iron pipe as described and used by others, in good condition. I set a 2 1/2" by 30" aluminum Oneida County monument over the top of the iron pipe, 3" above grade, stamped to indicate the location. I found all four of Badow's witness trees in good condition. I added another in case the maple, N 89° W, 43.59' is no longer viable, due to vegetative cover.

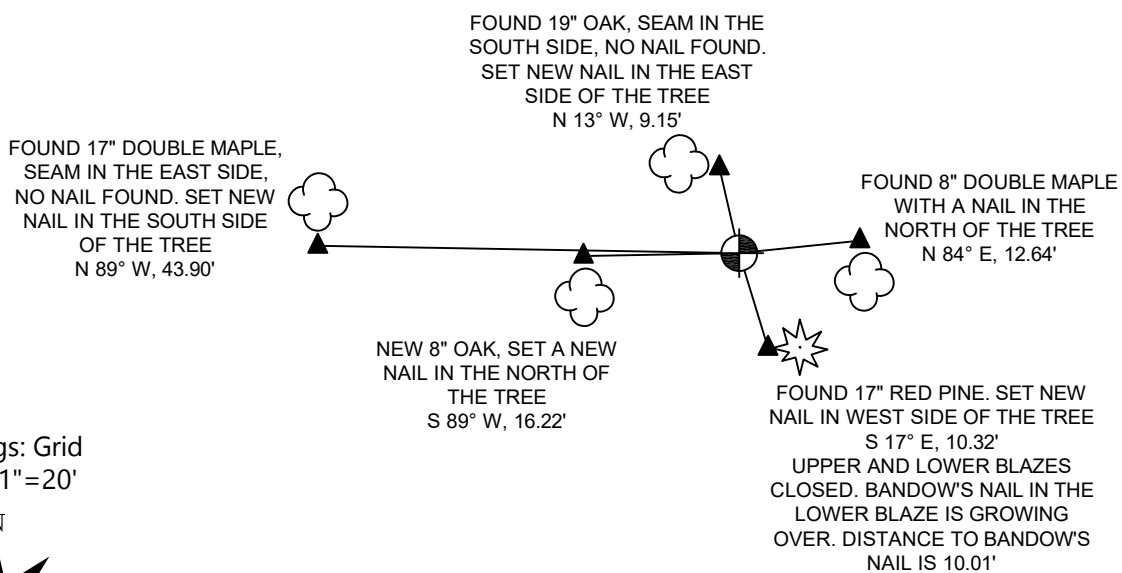

Bearings: Grid
Scale: 1"=20'

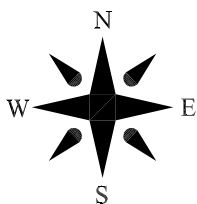

3(i)

I, Anthony R. Jones, Wisconsin Professional Land Surveyor No S-2508, hereby certify that the corner location shown on this record was determined by me, or under my direction or control, and that this U.S. Public Land Survey Monument Record is correct and complete to the best of my knowledge and belief.

