



CERTIFIED LAND CORNER RESTORATION

State of Wisconsin }
County of Oneida } ss.

I Michael J. Romportl, do hereby certify that on the 12th day of October, 1981, I found evidence of the Northeast corner of Section 29 Township 37 North Range 9 East, Fourth Principal Meridian, as described hereon; and that from this evidence I established a new monument and accessories as described hereon to perpetuate the original location of this corner:

Description of original monument and accessories and subsequent restorations:

- Wm. E. Daugherty Aug. 1863 set org. cor to sec. 20,21,28,29 B.T.s
- Hemlock 20 S33W 10 lks., circa 1851 lks.
- B. W. Dorr 1891 recovered corner
- D.H. Vaughan 1904 recovered cor., fd. post he set 5 years ago. org. B.T.s are burned also the stumps of the one he made are there but marks gone. dist. to flowage south 27.65ch., he was back at cor. in 1905 fd. post set from org. B.T.s made new ones W. Pine Stump 10 61.4E 61.75lks, dist north to N cor Sec. 20 37.54ch, dist. west to W cor. 29 39.66ch.
- W.C. Hall 1932 checked dist from N 1/2 cor S. 29 to N.E. cor agreed with D.H.V. fd. his B.T. & iron bar in ring of stones. \* continued on back

Description of corner evidence found:

- Wm. William Immich's 2" iron pipe and B.T.s dist. & bearings agreed

Description of monument and accessories I established to perpetuate the location of this corner:

- iron pipe in good condition made the following B.T.
- 9" Maple N 24° 11' 54.73" scribed bt

COMPARED WITH ALL RECORD DATA & ACCEPTED AS CORRECT.

Robert H. Nisbet
ONEIDA CO. SURVEYOR EMPLD. 1983

REGISTER OF DEEDS OFFICE ONEIDA COUNTY, WIS.
FILED MAY 11 1983
At 4:13 O'Clock P.M.
DORIS VERAGE KUEHN REGISTER OF DEEDS

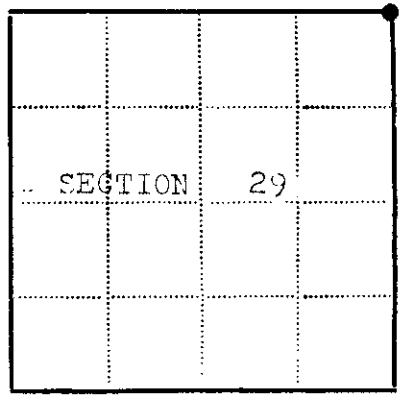
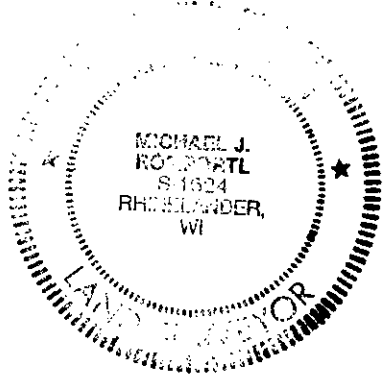

Corner monument restored
-

N.E. cor. Resident witnesses

Dated at Rhinelander Wisconsin, this 30th day of November 1981

Signature Michael J. Romportl Title Reg. Land Surveyor (County Surveyor, Registered Land Surveyor, or other duly authorized official)

Surveyors Registration No. 1624

Office of County of

I hereby certify that the within instrument was filed in this office for record on the day of 19 and was filed in Book No. Page No. of County Records.

Signature Title

Township Range Section Index No. Page No.

3709200000

R-9

- Kieth Hall 1944 made reference to sec. cor. being 1317.0' north of flowage established sec. line for Pine Lake Welfare Club survey
- J.C. Kirby 1965 recovered cor. dist. east to 1/16 1411'
- William Immich recovered cor. fr. rock pipe measured dist east to 1/16 agreed with Kirby, measured dist. north to E<sup>1</sup> cor. Sec. 20 2435.5' set a 2" x 30" iron pipe at cor., fd. 3.T.s 3" W. Birch S 17° W 13.75' 10" maple S 75 E 21.90' with scribing

# U.S. PUBLIC LAND SURVEY MONUMENT RECORD

**Note:** This form is intended and designed to fulfill all requirements of Wisconsin Administrative Code, Chapter A-E 7.08 U.S. Public Land Survey Monument Record (3) (a) (b) (c) (d) (e) (f) (g) (h) (i). An additional sheet may be added if necessary to conform with said requirements.

(a) Corner location: Township 37 North  
 Range 9 East/West

Town/City/Village Pine Lake  
 County Oneida

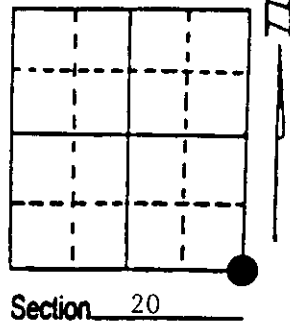

(b) (f) (g) (h) Description of monument found at this corner and if it was accepted, state all evidence (material, testimonial, occupational, plats, records, other monuments) used as a basis for accepting. If not accepted or if nothing was found, state evidence used as basis for establishing location. If reestablished through lost corner proportionate methods, indicate all monuments, distances and directions used to establish. Indicate type of monument found or set and sign post.

- 1863 - Wm. Daugherty established this corner, set post and BTs:  
 20" Hemlock, S53°W, 10 Links (6.6')      8" Birch, N51°E, 61 Links (40.26')
- 5/1993 - Milo E. Stefan found 2" iron pipe in mound of stone with Birch BTs dead.  
 (See Romportl Certificate 11/31/1981.)  
 We replaced 2" iron pipe with an aluminum county monument, made new BTs and set plastic sign post.

(c) (d) (e) Plan view of corner with ties to at least 4 witness monuments. If in disagreement with previously established corner, show the distances between the two corners and also indicate the ties to the disputed corner.

- 1) 2" x 30" aluminum monument.
- 2) 10" Red Maple, N63°E, 22.07'.
- 3) 8" Red Maple, S13°W, 37.91'.
- 4) 3" Red Oak, S53°W, 19.48'.
- 5) 12" Red Maple, N22°W, 54.72'.
- 6) Plastic sign post, East, 1.0'.

Distances from nail in side of BTs.  
 BTs stump blaze scribed "BT".

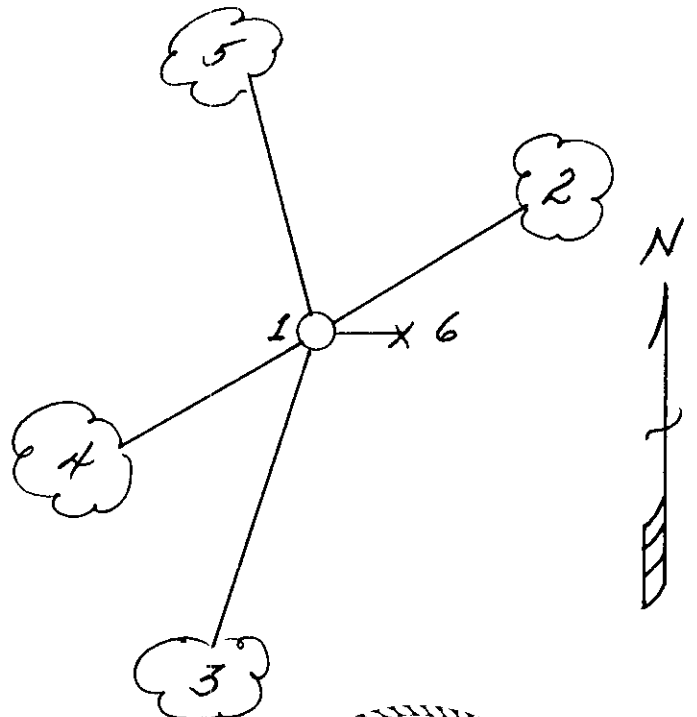

(i) I, Milo E. Stefan  
 (type or print name) certify that the corner location on this record was determined by me or under my direction and control and that this U.S. Public Land Survey Monument Record is correct and complete to the best of my knowledge and belief.

Milo E. Stefan      June 27, 1993  
 Signature      Date



Index No. R-9

Stamp 3709200000