

CERTIFIED LAND CORNER RESTORATION

Index No. **Q-12**

State of Wisconsin } ss.
County of Oneida

I Philip T. Hansen do hereby certify that on the 26th day of August 19 77, I found evidence of the SE 1/16 corner of Section 21 Township 37 North, Range 9 East, Fourth Principal Meridian, as described hereon; and that from this evidence I established a new monument and accessories as described hereon to perpetuate the original location of this corner.

Resident witnesses:
Jir Clafin
Herb Wagner

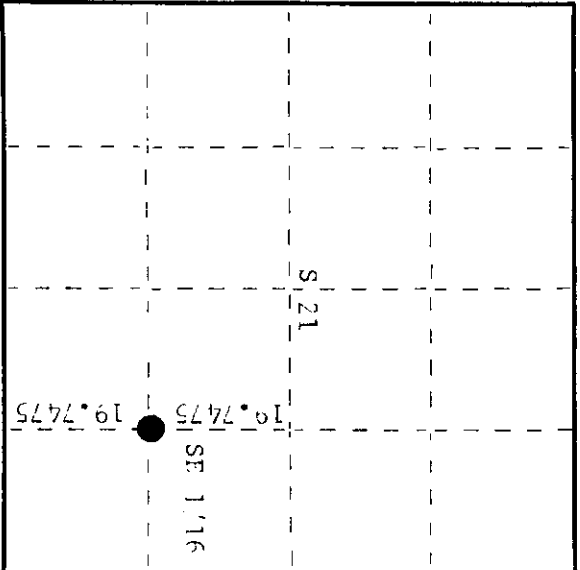
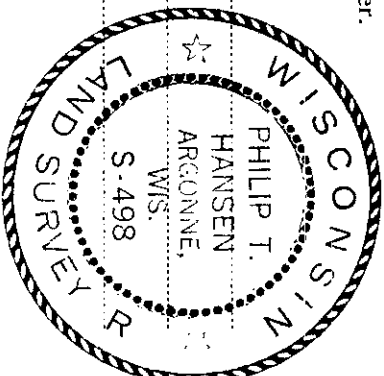

○ = Corner monument restored.

History of original corner establishment:

Corner established by Gaddard and crew, Ripco surveyors. Ran random line south from FC 1/16 corner 30.495 chains to close out of 0.5 links west of E 1/16 corner. Set SE 1/16 on corrected bearing S 0° 35' W at 19.7475 chains intermediate. Marked RBTs - Maple 50 S28°E, 12 links; Maple 40 S74°E, 251 links.

Description of corner evidence found:

Recovered 3/4" iron pipe with 2" brass cap projecting 2" above ground, stamped: Recovered CRTs - Maple 50 (60) S28°E, 12.0 links, scribing green over. Maple 40 (50) S74°E, 251 links, scribing green over.

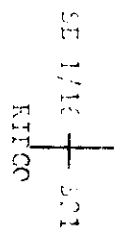

Description of monument and accessories I established to perpetuate the original location of this corner. Monument left in place as recovered. No additional accessories established.

Dated at Rhinelander, Wis., this 9th day of September, 1977.

Signature *Philip T. Hansen* Title: Registered Land Surveyor Registration No. S-498
County Surveyor, Registered Land Surveyor, or other duly authorized official
Office of Register of Deeds, County of Oneida
Instrument was filed in this office for record on the 15th day of September, 1977 at 2:00 o'clock P.M.

James W. Berger
(Register of Deeds)

By: Deputy

3709211010