

CERTIFIED LAND CORNER RESTORATION

Index No. Q-21

State of Wisconsin

County of Oneida } ss.

I, Phillip T. Hansen, do hereby certify that on the 10th day of June, 1980, I found evidence of the S. 1/16 corner of Sections 23 & 24 Township 37, North, Range 9 East, Fourth Principal Meridian, as described hereon; and that from this evidence I established a new monument and accessories as described hereon to perpetuate the original location of this corner.

History of original corner establishment:  
Corner established by N. Loftus, Ripco surveyor, in 1958. Ran south from 1/4 corner between sections 23 and 24 to section corner 23, 24, 25, 26 for a distance of 43.47 chains at bearing S 0° 04' E. Set S 1/16 21.735 chains intermediate.  
Marked NBT's -  
B.Spruce 7" N40°W 15 links  
B.Spruce 7" N75°E 9.5 links

Resident witnesses:  
Jim Clafin  
Herb Wagoner

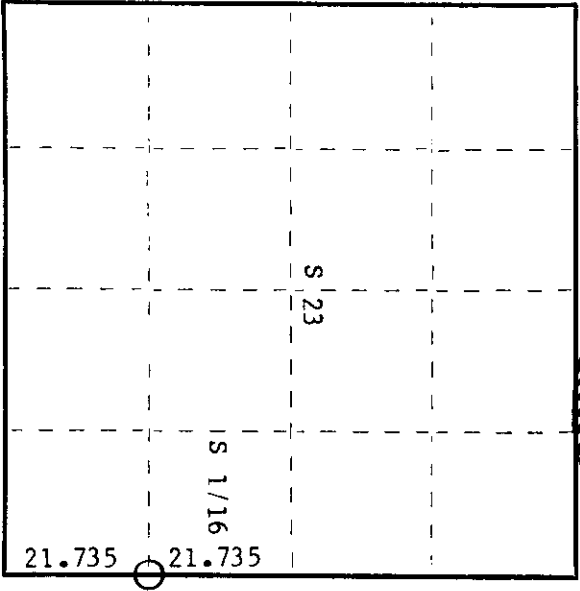
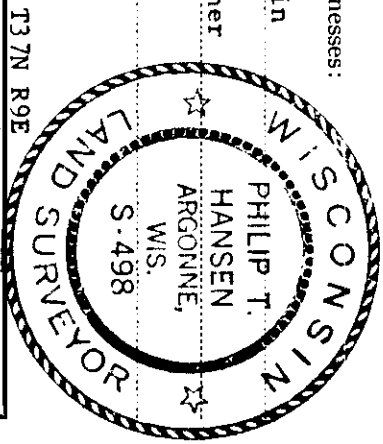

○ = Corner monument restored.

Description of corner evidence found:

Recovered 3/4" iron pipe with 2" brass cap, stamped:  
Monument projects 30" above ground.

Recovered OBT's -

B.Spruce 7" (8") N40°W 15 links,  
scribing partially legible.

B.Spruce 7" (8") N75°E (N83°E) 9.5 links (10.2 links),  
scribing partially legible.

S 1/16  
S23 | S24  
RIPCO

Description of monument and accessories I established to perpetuate the original location of this corner.  
Monument left as recovered.

Dated at Rhinelander, Wis., this 22nd day of July, 1980.

Signature [Signature] Title Registered Land Surveyor Registration No. S-498  
(County Surveyor, Registered Land Surveyor, or other duly authorized official)

Office of Register of Deeds, County of Oneida  
at 10:15 o'clock P.M. I hereby certify that the within instrument was filed in this office for record on the 30th day of July, 1980.

By [Signature] Deputy  
(Register of Deeds)

3709231000