

CERTIFIED LAND CORNER RESTORATION

Index No. **P-18**

State of Wisconsin

County of Oneida } ss.

I Phillip T. Hansen, do hereby certify that on the 22nd day of February, 1977, I found evidence of the WC 1/16 corner of Section 23 Township 37 North, Range 9 East Fourth Principal Meridian, as described hereon; and that from this evidence I established a new monument and accessories as described hereon to perpetuate the original location of this corner.

Resident witnesses:
Jim Claflin
Herb Wagoner

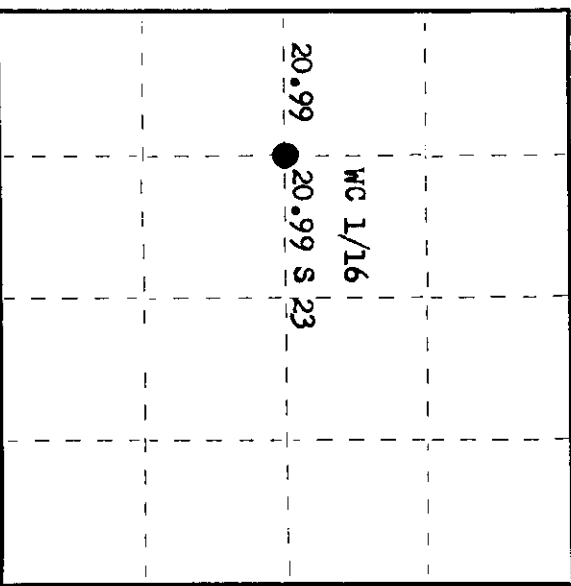
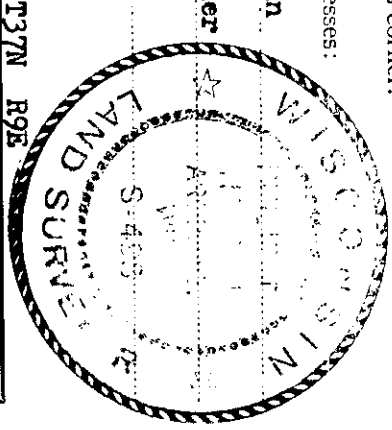

History of original corner establishment:

Corner established by N. Loftus, Ripco Surveyor, in 1955. Ran random line N89°W from recovered C 1/4 corner, 41.98 chains to close out 87 links North of W 1/4 corner. Set WC 1/16 corner at 20.99 chains intermediate, and 43 1/2 links south. True bearing of line S89°49'W.

Description of corner evidence found:

Recovered 1" iron pipe with 2" square brass cap, stamped:
This pipe was in good condition. There is also an old squared cedar post setting beside the iron pipe.
Recovered OBTs - White Spruce 12" N64°E 10.1 links, scribing not legible.
Red Pine 12" S6°S 11.2 links, scribed 1/16 BT.
Red Pine 14" N86°W 23.6 links, scribed 1/8S BT. (now stump)

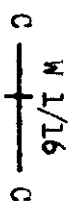

Description of monument and accessories I established to perpetuate the original location of this corner.
As monument was recovered in good condition, it was left in place.
Monument projects 28" above ground.
Added stamping T37N R9E to stamping on brass cap.

Dated at Rhineland Wis., this 29th day of March, 1977.

Signature Phillip T. Hansen Title Registered Land Surveyor Registration No. S-498
(County Surveyor, Registered Land Surveyor, or other duly authorized official)

Office of Register of Deeds, County of Oneida
Instrument was filed in this office for record on the 1st day of April, 1977
at 1:25 o'clock P. M.

Richard A. Ketchum
(Register of Deeds)

By Phillip T. Hansen Deputy

3709 23 2030