

CERTIFIED LAND CORNER RESTORATION

Index No. **0-25**

State of Wisconsin

County of Oneida

ss.

I Phillip T. Hansen, do hereby certify that on the 22nd day of July, 1977, I found evidence of the N 1/16 corner of Section 24 & 19 Township 37 North, Range 9 & 10 East, Fourth Principal Meridian, as described hereon; and that from this evidence I established a new monument and accessories as described hereon to perpetuate the original location of this corner.

Resident witnesses:
Jim Claflin
Herb Magoner

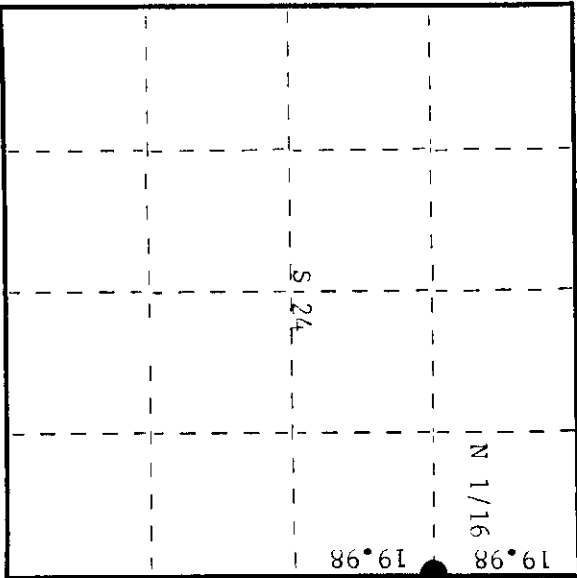
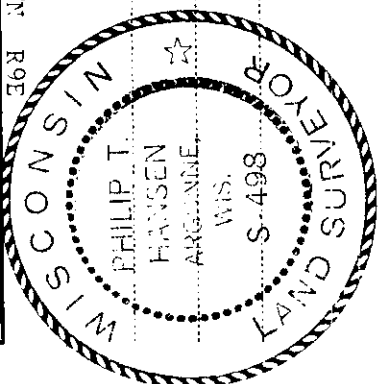

○ = Corner monument restored.

History of original corner establishment:

Corner established by N. Loftus, Ripco Surveyor, in 1956. Ran random line south from Section Corner 13, 1/2, 19 & 24, bearing S 2° 25' E at 39.96 chains. Closed out 2 links east of old 1/2 post, origin unknown.
Set N 1/16 corner, 1 link west at 19.98 chains intermediate.

Description of corner evidence found:

Recovered 1/2" reinforcing rod, 15", in log in road bed, badly bent.
Recovered 3/4" iron pipe with 2" square brass cap fir witness corner, 7-3/4 links west.
Cap stamped: T37-R0 - T37-R10, Section 24-19, N 1/16 - Corner 7-3/4 L WE.
Recovered CRT - tamarack 7" S35°E, 21.5 links, scribed N 1/16 S17 37-19 BT.

Description of monument and accessories I established to perpetuate the original location of this corner.

Replaced reinforcing rod with 1" x 18" iron pipe, 2" below the surface of road.
Set new witness corner, 1/2" iron pipe with 2" brass cap, stamped:
35 links east of iron pipe in road.
CRT - tamarack 5" S35°E, 21.5 links
tamarack 7" N28°E, 53.1 links, scribed 1/16 PT.
Monument projects 20" above ground.

S408
R0E R10E
T37N
N 1/16 S24 S19 .C.
W 35 lks

Dated at Rhineland, Wis., this 29th day of July, 1977.

Signature *Phillip T. Hansen* Title Registered Land Surveyor Registration No. S-408
County Surveyor, Registered Land Surveyor, or other duly authorized official

Office of Register of Deeds, County of Oneida
Instrument was filed in this office for record on the 13th day of August, 1977
at 10:00 clock A.M.

Doris Vernate Kuehn
(Register of Deeds)

By _____ Deputy

3709243000