

This form is intended to fulfill the requirements of Chapter A-E 7.08 (3)(a) thru (i) U.S. Public Land Survey Monument Location Record, Wisconsin Administrative Code. Use the reverse side of form for continuation.

U.S. PUBLIC LAND SURVEY MONUMENT LOCATION RECORD

Recorders Data

USPLS CORNER: MC & WITNESS CORNER SECTION: 36 TOWNSHIP: 37 NORTH RANGE: 09 EAST

NAME OF WATERWAY FOR M.C. CORNER : THIRD LAKE SECTION LINE: NORTH

(CITY)(VILLAGE)(TOWN) OF: PINE LAKE COUNTY OF: ONEIDA

Description of monument found or placed and all other evidence used as the basis for monument location; including monuments and related measurements required if the corner location was reestablished by lost corner proportionate methods. Also indicate name of original surveyor, original survey date and the corner monument, bearing trees, witness or other reference monuments established; including measured bearing and distance ties, from available records.

THIS RECOVERY REFERENCES THE NE CORNER OF SECTION 36, TOWNSHIP 37 NORTH RANGE 09 EAST AS FOLLOWS:

Found and accepted an undisturbed 2" dia. iron pipe monument with standard BLM brass cap 12" up as stamped during BLM Resurvey in 1953 as an MC Witness corner to NE section corner in lake 33' East. Also found a tall 1/2" dia. marker pipe nearby which I pulled and left flat on grade nearby. The witness corner pipe monument falls 1' West of lake shoreline this date.

No original GLO corner evidence searched for as this corner location was reestablished by the 1953 BLM Resurvey as noted below:

In July 1953, Hugh B. Crawford/BLM accepted the location of section corner from local BTs marked by D.H. Vaughan, Oneida County Surveyor in 1912; a 12" Hemlock with old blaze S73.25°W(S55.5°W) 63 links, I could not find, and a 12" Pw with old blaze N77°W(N75°W) 52 links, now a badly rotted low root crown. Crawford also noted an iron pipe found flat in mud near the section corner location. As the section corner fell into the lake bed, Crawford noted a standard 2.5" OD by 30" long BLM capped iron pipe monument was set as a witness corner S88°17'W(Solar) 50 links(33') and marked new BTs that I found OK as noted this date and used for new ties listed below; all per BLM Field Notes filed as L-1034 in Oneida County survey records.

This recovery completed June 21, 2001; there were no direct witnesses.

Plan view map of monument location with bearing and distance ties to a minimum of four(4) described witness or reference monuments of concrete, natural stone, iron, live bearing trees or equivalent material. If applicable, also show a minimum of two(2) bearing and distance ties to any other monument found and not accepted; including the bearing and distance from the accepted monument.

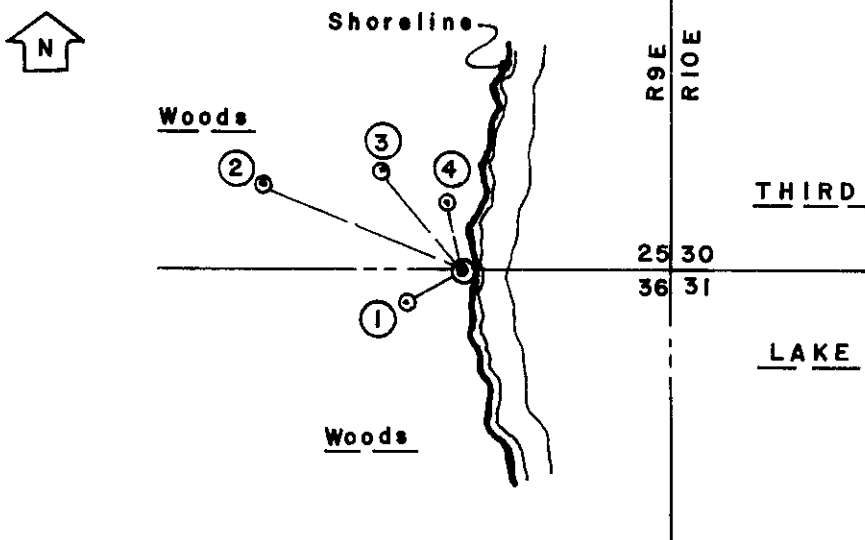

WITNESS MONUMENT TIES:

- ① 1953 BLM BT 12" Hemlock with blazing shut but plain S60°W (S54.5°W) 10.46'(10.6').
- ② New BT 11" Hemlock N67°W at 33.95'.
- ③ New BT 15" Hemlock N40°W at 20.44'.
- ④ 1953 BLM BT 20" Hemlock with blazing shut but plain N14°W (N21.5°W) 10.53' (10.6') now to PK/ nail & washer in left face.

Standard white poly 'T' corner marker post set 10" West of witness corner monument found.

SCALE: 1"=30'

Unless otherwise indicated, all bearing tree ties are to a .25" dia. by 2.5" long PK nail with a 1.25" dia. steel washer driven into unblazed right face and a .25" dia. by 2.5" long PK nail with a 2" dia. steel washer stamped BT is also driven into unblazed face of bearing tree at DBH; the basis for measured bearings is by compass to nearest degree and all tie distances are measured horizontal by steel tape corrected to nearest 1/100th feet at standard temperature of 68° F.

RLS SEAL:

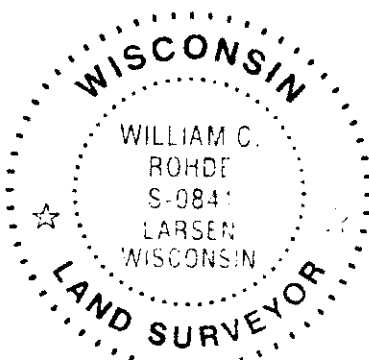

LAND SURVEYOR CERTIFICATE:

I, William C. Rohde, hereby certify that I am duly licensed as a Professional Land Surveyor in the State of Wisconsin; that this USPLS monument location was determined by me and/or under my direct supervision and control; and that this U.S. Public Land Survey Monument Location Record is true and correct to the best of my knowledge and belief.

Signed *William C. Rohde*
William C. Rohde RLS 841

Date Signed: March 25, 2002

		T 37 N	
		36	
		R 09 E	

SECTION LOCATION MAP
INDEX NO. *V 21 21*