

CERTIFIED LAND CORNER RESTORATION

Index No. V-17
V-16

00100
370927000

State of Wisconsin }
County of Oneida } ss.

I Philip T. Hansen, do hereby certify that on the 15th day of February, 1977, I found evidence of the E 1/16 corner of Section 27 and 34 Township 37, North, Range 9 East, Fourth Principal Meridian, as described hereon; and that from this evidence I established a new monument and accessories as described hereon to perpetuate the original location of this corner.

Resident witnesses:

Jim Claflin

Herb Wagoner

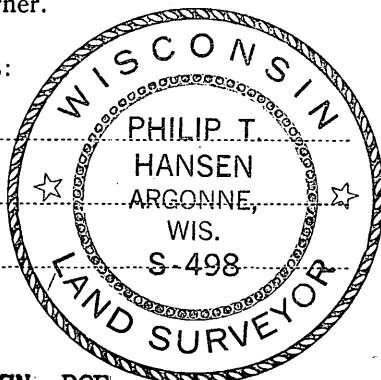

T37N R9E

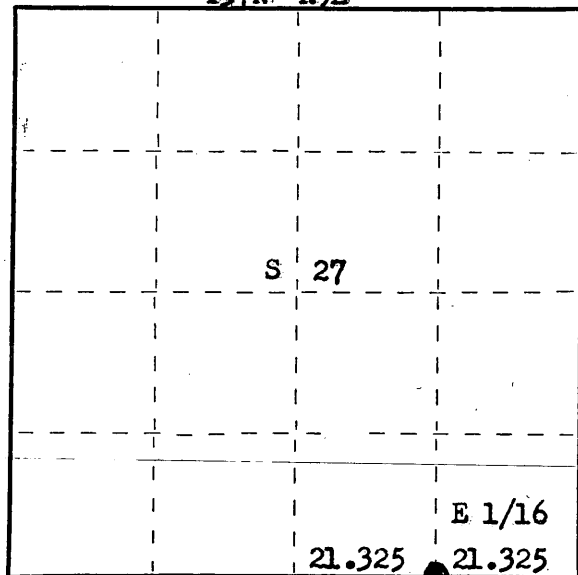

○ = Corner monument restored.

History of original corner establishment:

Corner established by N. Loftus, Ripco Surveyor, in 1961. Ran random line west from established corner, Sec. 26, 27, 34, 35 to S 1/4 corner distance 42.1437. Established E 1/16 at 21.1325 chains.
Marked NBTs - Maple 4" S 53° W 16-3/4 links and Maple 5" N 58° E 26-3/4 links.

Description of corner evidence found:

Recovered 1" iron pipe with an alloy cap. This cap was incorrectly stamped with NE 1/16 S34 RIPC0.

Recovered OBT - Maple 4" (5") S 53° W (S 48° W) 16.75 links.
Maple 5" (6") N 58° E 26.75 links, scribing not legible.

Description of monument and accessories I established to perpetuate the original location of this corner.

Removed incorrectly stamped monument and replaced it with a 1" iron pipe with 2" brass cap stamped:

Monument projects 28" above ground.

S498
T37N R9E
E 1/16 $\frac{S+27}{S+34}$
1975

Dated at Rhineland, Wis., this 17th day of March, 1977.

Signature Philip T. Hansen Title Registered Land Surveyor Registration No. S-498
(County Surveyor, Registered Land Surveyor, or other duly authorized official)

Office of Register of Deeds, County of Oneida, I hereby certify that the within instrument was filed in this office for record on the 23rd day of March, 1977 at 3:00 o'clock P. M.

Doris Verage Kuehn
(Register of Deeds)

By _____ Deputy