

CERTIFIED LAND CORNER RESTORATION

Index No. U-16

State of Wisconsin

County of Oneida } ss.

I Phillip T. Hansen, do hereby certify that on the 14th day of February, 1977, I found evidence of the SE 1/16 corner of Section 27

Township 37, North, Range 9 East, Fourth Principal Meridian,

as described hereon; and that from this evidence I established a new monument and accessories as described hereon to perpetuate the original location of this corner.

Resident witnesses:

Jlm Claflin

Herb Wagoner

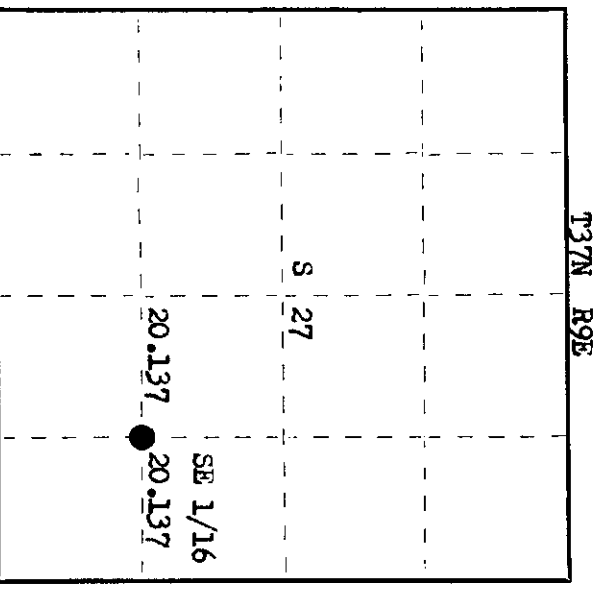
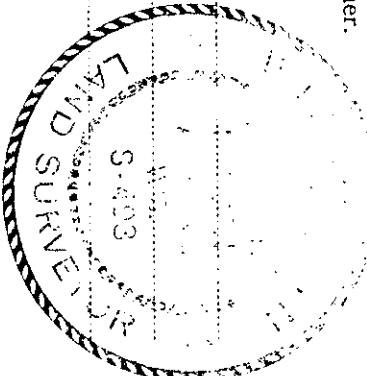

History of original corner establishment:

Corner established by N. Loftus, Ripco Surveyor, in 1962. From C-S 1/16 corner, set by Genlot Engineers, R. Brandow, Registered Land Surveyor, ran random line N 85° E 40.274 chains to close out 37.8 links south of the S 1/16 on east line. Set SE 1/16 corner at 20.137 chains intermediate and 18.9 links north. Set iron pipe and marked NBTs - Maple 5" S 48° E 26 links and Maple 6" N 4° 30' W 52 links.

Description of corner evidence found:

Recovered 1" iron pipe with round alloy cap, not stamped. Monument in good condition, projecting 30" above ground. Recovered Maple 5" (6") S 48° E 26.0 links, scribed SE 1/16 BT. Maple 6" N 4° 30' N 52 links, scribed SE 1/16 BT.

Description of monument and accessories I established to perpetuate the original location of this corner. As monument was recovered in good condition, it was left in place. Stamped cap:

T37N R9E
SE 1/16 S 1/27
CPI-1977

Dated at Rhineland, Wis., this 17th day of March, 1977.

Signature [Signature] Title Registered Land Surveyor Registration No. 5498
(County Surveyor, Registered Land Surveyor, or other duly authorized official)

Office of Register of Deeds, County of Oneida
Instrument was filed in this office for record on the 23rd day of March, 1977 at 3:00 o'clock P. M.

[Signature]
(Register of Deeds)

By [Signature] Deputy

3709271010