

CERTIFIED LAND CORNER RESTORATION

Index No. V-12

State of Wisconsin }
County of Oneida } ss.

History of original corner establishment:
No records of any previous survey on file.

I, Phillip T. Hansen, do hereby certify that on the 27th day of July, 1977, I found evidence of the E 1/16 corner of Section 28 & 33 Township 37 North, Range 9 East, Fourth Principal Meridian, as described hereon; and that from this evidence I established a new monument and accessories as described hereon to perpetuate the original location of this corner.

Description of corner evidence found:
Recovered 3/4" iron pine driven into ground. There was a fresh blazed line running west from this corner. Origin unknown.
No evidence of any PTs were recovered.

Resident witnesses:
Jim Clafflin
Herb Wagoner

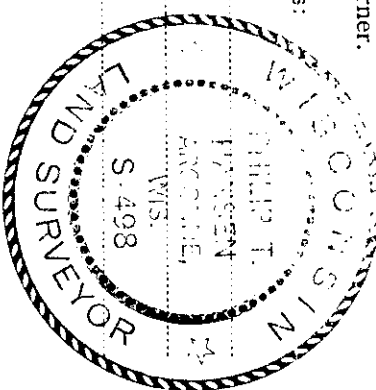

T37N R9E
E 1/16

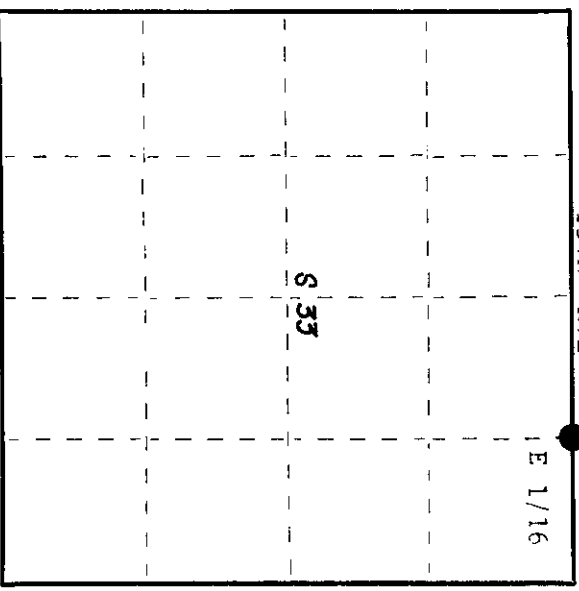

○ = Corner monument restored.

Description of monument and accessories I established to perpetuate the original location of this corner.

Replaced iron pipe with 1 1/2" iron pipe with 2" brass cap, stamped:
Monument projects 30" above ground.
Marked NBTs - Red Pine 8" N7 1/2° W, 22.2 links
Maple 7" S88° E, 47.3 links
Both scribed 1/16 BT.

S498
T37N R9E
E 1/16 S 28
S 33
CFI-1977

Dated at Rhineland, Wis., this 29th day of July, 1977.

Signature Phillip T. Hansen Title Registered Land Surveyor Registration No. S-498
County Surveyor, Registered Land Surveyor, or other duly authorized official

Office of Register of Deeds, County of Oneida
at 9:00 o'clock 5:14 M. day of August, 1977
I hereby certify that the within

Doris Verage Kuehn
(Register of Deeds)

By: Deputy

3709280010