

This form is intended to fulfill requirements of Chapter A-E 7.08 (3)(a) thru (i) U.S. Public Land Survey Monument Location Record, Wisconsin Administrative Code. Use reverse side for geodetic location data and/or other continuation purposes.

U.S. PUBLIC LAND SURVEY MONUMENT LOCATION RECORD

Recorders Data

USPLS CORNER: NW SECTION CORNER SECTION: 33 TOWNSHIP: 37 NORTH RANGE: 9 EAST

NAME OF WATERWAY FOR M.C. CORNER: N/A SECTION LINE: N/A

(CITY)(VILLAGE)(TOWN) OF: RHINELANDER COUNTY OF: ONEIDA

Description of monument found or placed and all other evidence used as the basis for monument location; including monuments and related measurements required if the corner location was reestablished by lost corner proportionate methods. Also indicate name of original surveyor, original survey date and the corner monument, bearing trees, witness or other reference monuments established; including measured bearing and distance ties, from available records.

Found and accepted top center of older 1.25" dia. iron pipe monument with uncapped top driven flush with existing blacktop roadway surface at this corner location.

In 1863, William Daugherty/GLO set a wood post as the original corner and marked OBTs, a 12" Aspen S34°W 6 links and an 8" Bw S79°E 15 links, all of which are now obliterated.

Following Plats of Survey are referenced to iron pipe monument found at this corner, as filed in Oneida County records:

B-914	William Bandow	RLS 1182	1976
C-615	William Bandow	RLS 1182	1989
C-915	William Bandow	RLS 1182	1992
B-2643	Todd Loftus	RLS 1523	1993
B-3540	Devon Vanden Heuvel	RLS 1795	1996
C-1350	William Bandow	RLS 1182	1997

This recovery completed April 28, 1999 and witnessed by Yvonne M. Stoehr, nearby owner at 1718 Menominee Drive, and two(2) Rhinelander Telephone Company employees visiting phone system sub-station SE of corner location.

No standard 'T' marker post set as adjacent areas lawned. No witness monuments set on right line to prevent conflicts.

Plan view map of monument location with bearing and distance ties to a minimum of four(4) described witness or reference monuments of concrete, natural stone, iron, live bearing trees or equivalent material. If applicable, also show a minimum of two(2) bearing and distance ties to any other monument found and not accepted; including the bearing and distance from the accepted monument.

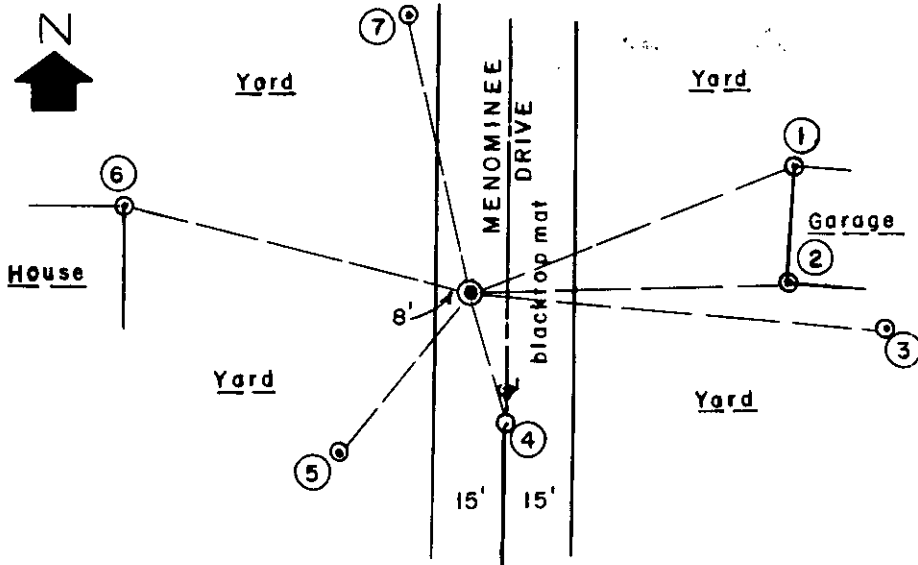

WITNESS MONUMENT TIES:

- ① NW corner of garage foundation at grade, N69°E 73.15'.
- ② SW corner of garage foundation at grade, N89°E 66.18'.
- ③ Old BT 18" Pw, upper blaze shut & lower blaze open with scribing, S85°E 86.35'.
- ④ Center of Manhole S17°E 22.58'.
- ⑤ Center of Manhole S40°W 43.52'.
- ⑥ NE corner of house foundation at grade, N75°W 74.45'.
- ⑦ Hydrant stem N12°W 59.55'.

SCALE: 1" = 40'

Unless otherwise indicated, all bearing tree ties are to a .25" dia. by 2.5" long PK nail with a 1.25" dia. steel washer driven into unblazed right face and a .25" dia. by 2.5" long PK nail is also driven into unblazed face of bearing tree at DBH; the basis for measured bearings is by magnetic compass to nearest degree and all tie distances are measured horizontal by steel tape corrected to nearest 1/100th feet at standard temperature of 68 degrees Fahrenheit.

RLS SEAL:

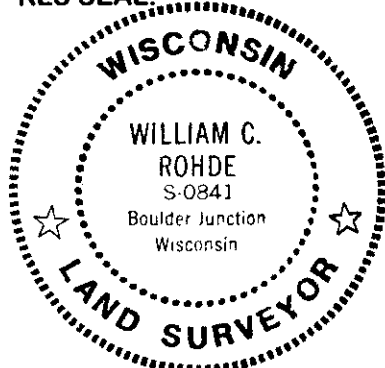

LAND SURVEYOR CERTIFICATE:

I, William C. Rohde, hereby certify that I am duly licensed as a Professional Land Surveyor in the State of Wisconsin; that this USPLS monument location was determined by me and/or under my direct supervision and control; and that this U.S. Public Land Survey Monument Location Record is true and correct to the best of my knowledge and belief.

Signed: *William C. Rohde*
William C. Rohde RLS 841

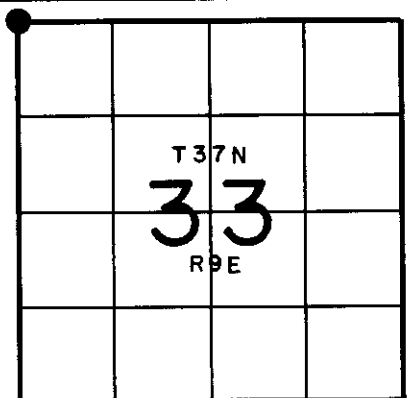

SECTION LOCATION MAP

INDEX NO. V 9
3709 2900 00

U.S. PUBLIC LAND SURVEY MONUMENT RECORD

Note: This form is intended and designed to fulfill all requirements of the Wisconsin Administrative Code, Chapter A-E 7.08 U.S. Public Land Monument Record (3)(a)(b)(c)(d)(e)(f)(g)(h)(i).
An additional sheet may be added if necessary to conform with said requirements.

(a) CORNER LOCATION: Oneida County Corner I.D. No.:

Southeast Corner, Sec. 29
Township 37 North
Range 09 East
City of Rhinelander
County of Oneida

3709290000

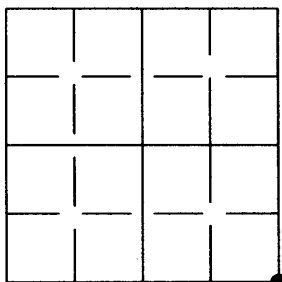

SECTION 29

REGISTER OF DEEDS OFFICE
ONEIDA COUNTY

FILED

APR 03 2012

AT _____ O'CLOCK _____ M
THOMAS H. LEIGHTON
REGISTER OF DEEDS

(f)(g)(h) DESCRIPTION OF MONUMENT FOUND AT THIS CORNER AND IF IT WAS ACCEPTED, STATE ALL EVIDENCE (MATERIAL, TESTIMONIAL, OCCUPATIONS, PLATS, RECORDS, OTHER MONUMENTS) USED AS A BASIS FOR ESTABLISHING LOCATION. IF NOT ACCEPTED OR IF NOTHING WAS FOUND, STATE EVIDENCE USED AS BASIS FOR ESTABLISHING LOCATION. IF REESTABLISHED THROUGH LOST CORNER PROPORTIONATE METHODS, INDICATE ALL MONUMENTS, DISTANCES AND DIRECTIONS USED TO ESTABLISH. INDICATE TYPE OF MONUMENT AND SIGN POST FOUND OR SET.

See U.S. Public Land Survey Monument Record by William Rhode R.L.S. No. S-841, dated May 8th, 1999 for previous information on this corner and ties to existing building corners, manholes and fire hydrant.

3/19/2012- Anthony R. Jones found a 2" (o.d.) iron pipe below the surface of Menominee Drive. Previous ties per Rohde are in and conform to HIS monument record locations. Upper and lower blazes on 18" Pw have both grown over. Distance is to nail in the south face of the tree and bearing is to the nail/washer at mean breast height on west face of tree. I added a new ties as shown below.

(c)(d)(e) PLAN VIEW OF CORNER WITH TIES TO AT LEAST 4 WITNESS MONUMENTS. IF IN DISAGREEMENT WITH PREVIOUSLY ESTABLISHED CORNER, SHOW THE DISTANCE BETWEEN THE TWO CORNERS AND ALSO INDICATE THE TIES TO THE DISPUTED CORNER.

NORTH BASED ON THE BEARING FROM THE SOUTHEAST SECTION CORNER OF SECTION 29 TO THE NE CORNER OF THAT PARCEL SHOWN ON ONEIDA COUNTY LAND INFORMATION MAP No. B956, CALCULATED TO BEAR: S 04°08'02" W.

- 1: FD 2" IRON PIPE PER USPLSS MONUMENT RECORD BY ROHDE, MAY 8, 1999
- 2: FD 1 1/4" IRON PIPE PER ONEIDA COUNTY L.I.O MAP No. B956, S 04°08'02" W, 261.59' (261.41')
- 3: FD BEARING TREE, 18" Pw N 89°45'38" E, 86.32'
- 4: FD 1 1/4" IRON PIPE S 84°39'10" E, 33.25'
- 5: FD 1 1/4" IRON PIPE S 35°41'01" E, 61.72'
- 6: SET 1" BY 18" IRON ROD S 35°40'46" E, 74.39'

All pipe monument measurements are outside diameter.
Measurement to tree taken to spike in side of tree.
Bearing taken to spike/washer in center of tree.

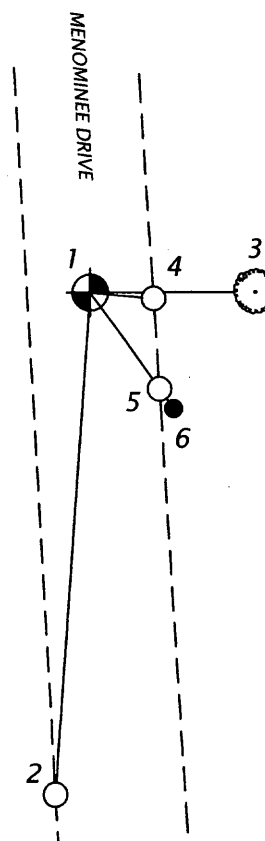
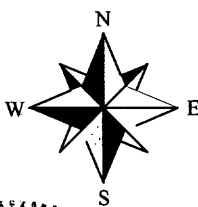
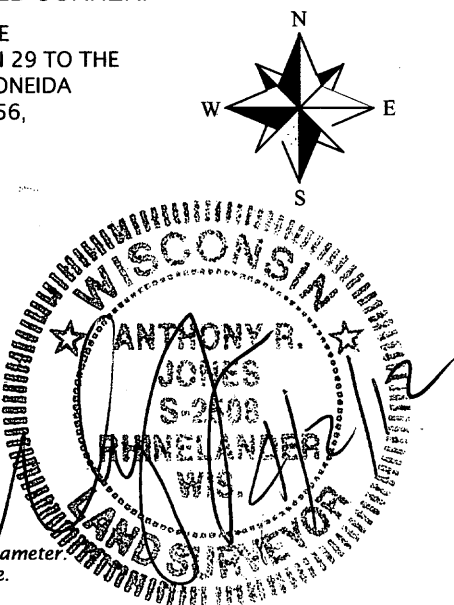

(i) I, ANTHONY R. JONES, REGISTERED LAND SURVEYOR NO. S-2508 HEREBY CERTIFY THAT THE CORNER LOCATION ON THIS RECORD WAS DETERMINED BY ME OR UNDER MY DIRECTION AND CONTROL AND THAT THIS U.S. PUBLIC LAND SURVEY MONUMENT RECORD IS CORRECT AND COMPLETE TO THE BEST OF MY KNOWLEDGE AND BELIEF.

SIGNATURE

DATE

4/2/2012