

CERTIFIED LAND CORNER RESTORATION

Index No. W-11

State of Wisconsin

County of Oneida

} ss.

I Phillip T. Hansen, do hereby certify that on the 22nd day of July, 1977, I found evidence of the NC 1/16 corner of Section 33

Township 37, North, Range 9 East, Fourth Principal Meridian,

as described hereon; and that from this evidence I established a new monument and accessories as described hereon to perpetuate the original location of this corner.

Resident witnesses:

Jim Clafflin

Herb Wagoner

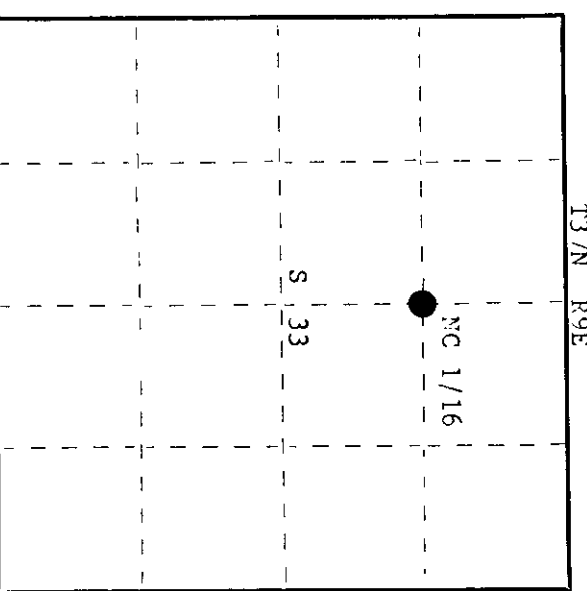
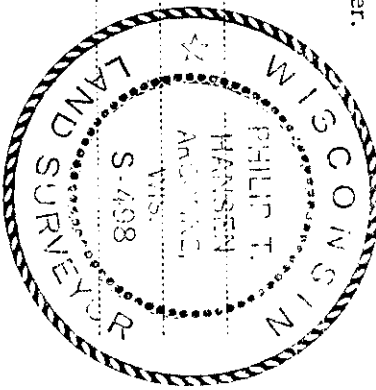

○ = Corner monument restored.

History of original corner establishment:

No record of any previous survey.

Description of corner evidence found:

Evidence of recent survey, traverse lines are still cleared and visible.
Recovered 1" iron pipe driven into muck.
Recovered OBTs - Black Spruce 4" S15°W, 19.4 links, scribed BT.
Black Spruce 4" N24°W, 18.6 links, blazed, but not scribed.

Description of monument and accessories I established to perpetuate the original location of this corner.

Set a 1 1/2" iron pipe with 2" brass cap in place of iron pipe, cap stamped:
Monument projects 10" above ground.
Scribed Black Spruce N24°W -- 1/16 BT.

S498
T37N R9E
NC 1/16 S 33
CPI-1977

Dated at Rhineland, Wis., this 29th day of July, 1977.

Signature Phillip T. Hansen Title Registered Land Surveyor Registration No. S-498
(County Surveyor, Registered Land Surveyor, or other duly authorized official)

Office of Register of Deeds, County of Oneida
Instrument was filed in this office for record on the 5th day of August at 9:00 o'clock A. M. I hereby certify that the within

Doris Stange Kuehn
(Register of Deeds)

By: _____ Deputy

3709333020