

CERTIFIED LAND CORNER RESTORATION

Index No. W-16

State of Wisconsin } ss.
County of Oneida

I Phillip T. Hansen, do hereby certify that on the 16th day of February, 1977, I found evidence of the NE 1/16 corner of Section 34, Township 37, North, Range 9 East, Fourth Principal Meridian, as described hereon; and that from this evidence I established a new monument and accessories as described hereon to perpetuate the original location of this corner.

Resident witnesses:
Jim Claflin
Herb Wagoner

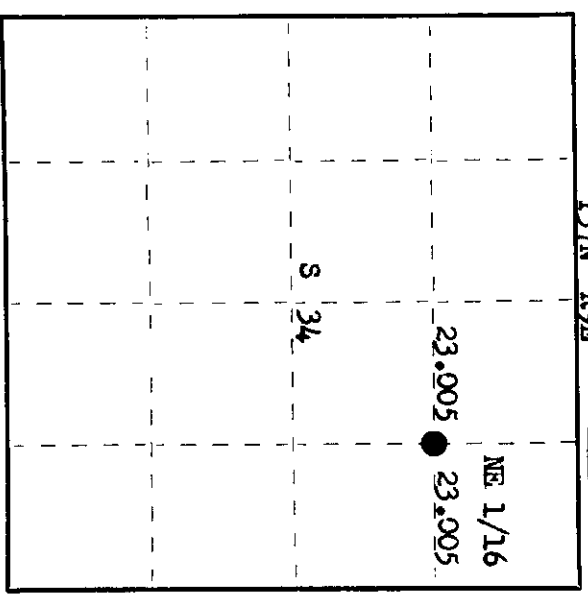
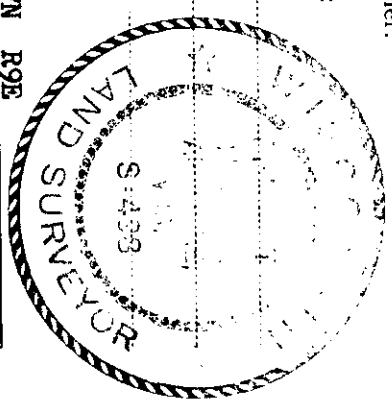

○ = Corner monument restored.

History of original corner establishment:

Corner established by N. Loftus, Ripco Surveyor, in 1961. From established EC 1/16 he ran a random line 353° 07' mag. 46.01 chains to close out .302 chains west of E 1/16. Set NE 1/16 at 23.005 chains intermediate and .151 chains East. Set iron pipe and marked MBTs - Red Pine 12" N 10° E 68½ links and White Pine 11½" S 18° W 33-3/4 links. Corrected bearing N 6° 30' 30" west.

Description of corner evidence found:

Recovered 1" iron pipe with cap missing. There was also a 4" square stake setting beside iron pipe.
Recovered MBTs - Red Pine 12" (16") N 10° E 68.5 links, scribed 1/16 BT.
White Pine 11" (14") S 18° W 33.75 links, scribed 1/16 BT.

Description of monument and accessories I established to perpetuate the original location of this corner.
Replaced iron pipe with 1" iron pipe with 2" brass cap, stamped:
Monument projects 24" above ground.

T37N R9E
NE 1/16 S 34
S498-1975

Dated at Rhineland, Wis., this 18th day of March, 1977.

Signature Phillip T. Hansen Title Registered Land Surveyor Registration No. S-498
(County Surveyor, Registered Land Surveyor, or other duly authorized official)

Office of Register of Deeds, County of Oneida
Instrument was filed in this office for record on the 23rd day of March, 1977
at 3:00 o'clock P. M.

Lois George Kuehn
(Register of Deeds)

By: _____ Deputy

3709343010