

CERTIFIED LAND CORNER RESTORATION

Index No. **E-6**

State of Wisconsin

County of Oneida } ss.

History of original corner establishment:
Corner established by N. Loftus, Ripco Surveyor, in 1959. No record of notes of survey.

I Philip T. Hansen, do hereby certify that on the 6th day of June, 1977, I found evidence of the W 1/16 corner of Section 5 & 8 Township 37, North, Range 10 East, Fourth Principal Meridian, as described hereon; and that from this evidence I established a new monument and accessories as described hereon to perpetuate the original location of this corner.

Resident witnesses:

Jim Clafflin

Herb Wagoner

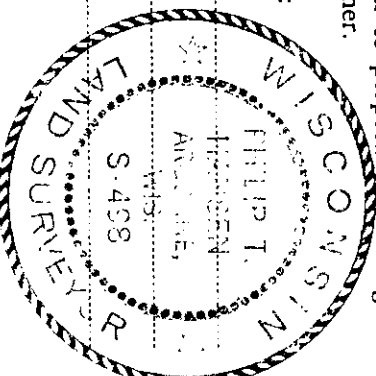

T37N R10E

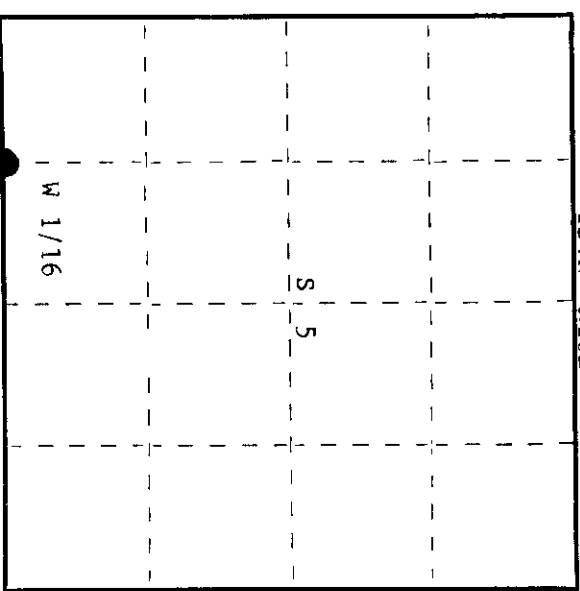

○ = Corner monument restored.

371005 6030

Description of corner evidence found:
Recovered 1" OD iron pipe with 2" square brass cap.
Iron pipe bent over and badly rusted.
Recovered OBT - Balsam 10" N44°E, 29.3 links, scribed 1/16 BT.

Description of monument and accessories I established to perpetuate the original location of this corner.
Replaced old iron pipe with 1 1/2" iron pipe with 2" brass cap, stamped:
Monument projects 16" above ground.
Marked NBTs - Maple 5" N74°E, 20.8 links, scribed 1/16 BT.
Maple 5" S24°E, 58.2 links, scribed 1/16 BT.

S498
T37N R10E
W 1/16 S 5
CPI-1977

Dated at Oneida, Wis., this 7th day of June, 1977.

Signature Philip T. Hansen Title Registered Land Surveyor Registration No. S-498
(County Surveyor, Registered Land Surveyor, or other duly authorized official)

Office of Register of Deeds, County of Oneida, I hereby certify that the within instrument was filed in this office for record on the 23rd day of June, 1977 at 12:40 o'clock P. M.

Dana Verage Kuehn
(Register of Deeds)

By Dana Verage Kuehn Deputy