

CERTIFIED LAND CORNER RESTORATION

Index No. **C-6**

State of Wisconsin

County of Oneida } ss.

I, Phillip T. Hansen, do hereby certify that on the 2nd day of June, 19 77, I found evidence of the WC 1/16 corner of Section 5 Township 37, North, Range 10 East, Fourth Principal Meridian, as described hereon; and that from this evidence I established a new monument and accessories as described hereon to perpetuate the original location of this corner.

Resident witnesses:
Jim Claffin
Herb Wagoner

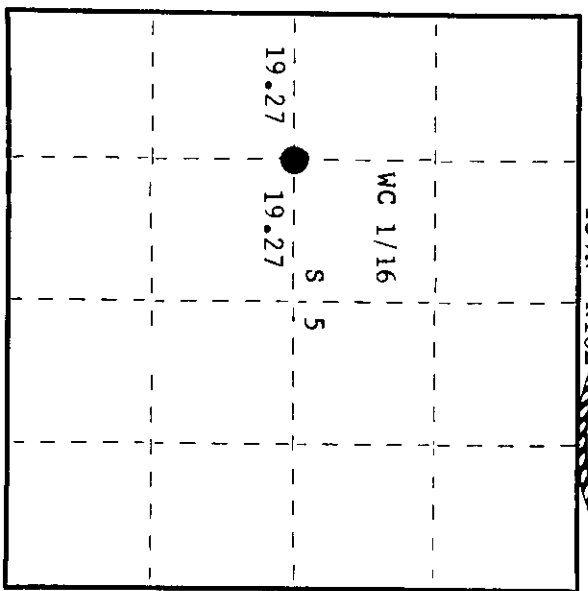
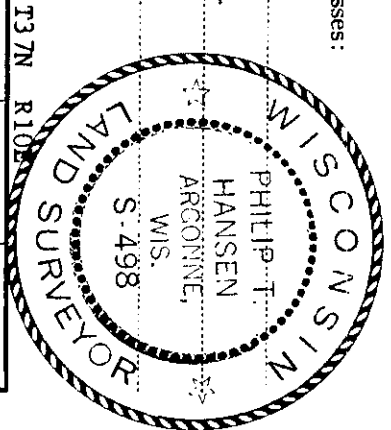

○ = Corner monument restored.

History of original corner establishment:

Corner established by N. Loftus, Ripco Surveyor, in 1959. Ran random line bearing 91° East from W 1/4 corner 76.28 chains to close out 75 links south of E 1/4. Established C 1/4 corner at 38.54 chains. Set W.C 1/16 at 19.27 chains equidistant. Marked NBTs - Black Spruce 3" S9°W, 32 links and Black Spruce 3" N46°W, 21½ links.

Description of corner evidence found:

Recovered 1" OD Iron pipe with 2" square brass cap in excellent condition. Cap stamped: Recovered OBTs - Black Spruce 3" S9°W (S10°W) 32.0 links (31.5 links), now dead. Black Spruce 3" (6") N46°W (N42°W) 21.5 links, scribed 1/16 BT.

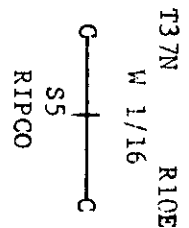

Description of monument and accessories I established to perpetuate the original location of this corner. As the monument was found in excellent condition, it was left in place. Monument projects 14" above ground. Marked NBT - Black Spruce 6" S20°E, 55.1 links, scribed 1/16 BT.

Dated at Rhineland, Wis., this 7th day of June, 19 77.

Signature Phillip T. Hansen Title Registered Land Surveyor Registration No. S-498
 (County Surveyor, Registered Land Surveyor, or other duly authorized official)
 Office of Register of Deeds, County of Oneida at 9:30 o'clock A. M. I hereby certify that the within instrument was filed in this office for record on the 30th day of June, 19 77.

By Steven Savage Tuelke (Register of Deeds)
Joseph M. Bommer Deputy

371005 2030