

CERTIFIED LAND CORNER RESTORATION

Index No. **D-5**

State of Wisconsin

County of Oneida } ss.

I Philip T. Hansen, do hereby certify that on the 3rd day of June, 19 77, I found evidence of the S. 1/16 corner of Section 5. & 6 Township 37, North, Range 10 East, Fourth Principal Meridian, as described hereon; and that from this evidence I established a new monument and accessories as described hereon to perpetuate the original location of this corner.

Resident witnesses:

Jim Clafin
Herb Wagoner

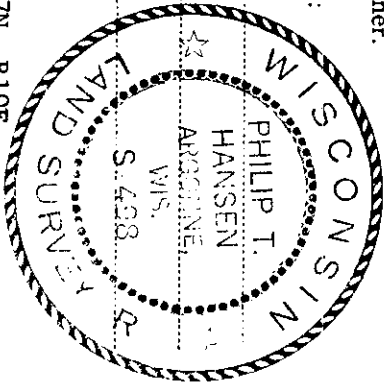

T37N R10E

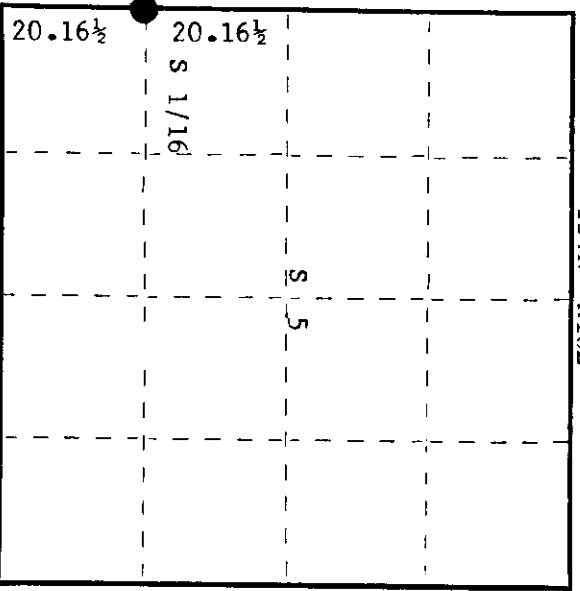

O = Corner monument restored.

History of original corner establishment:

Corner established by N. Loftus, Ripco Surveyor, in 1959. Ran random line 357° 30' 40.33 chains to close out 84 links west of B.F. Dorr's old 1/4 corner. Set S 1/16 corner at 20.16 1/2 chains 42 links east. Marked NBTs - Black Spruce 6" S69°W, 14 links. Black Spruce 4" N22°E, 2 links, bearing N 1° 19' W.

Description of corner evidence found:

Recovered 1" OD iron pipe with 2" brass cap in excellent condition. Cap stamped: Recovered Black Spruce 4" (5") N22°E (N9°E), 2 links scribed 1/16 BT. Black Spruce 6" (7") S69°W (S84°W) 14 lks., scribed 1/16 BT.

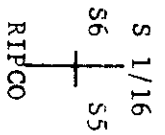

Description of monument and accessories I established to perpetuate the original location of this corner. Added stamping T37N R10E to brass cap. Monument projects 20" above ground.

Dated at Rhineland, Wis., this 7th day of June, 19 77.

Signature Philip T. Hansen Title Registered Land Surveyor Registration No. S-428
(County Surveyor, Registered Land Surveyor, or other duly authorized official)
Office of Register of Deeds, County of Oneida
at 12:40 o'clock P. M. 33rd day of June, 19 77

By Dorcas Verage Buckner Deputy
(Register of Deeds)

By _____ Deputy

3710061000