

CERTIFIED LAND CORNER RESTORATION

Index No. 1-5

State of Wisconsin } ss.  
 County of Oneida }

I, Philip T. Hansen, do hereby certify that on the 24th day of June, 1977, I found

evidence of the Section corner of Sec. 7, 8, 17 & 18 Township 37 North, Range 10 East, Fourth Principal Meridian,

as described hereon; and that from this evidence I established a new monument and accessories as described hereon to perpetuate the original location of this corner.

Resident witnesses:

Jim Clafflin  
 Herb Wagoner

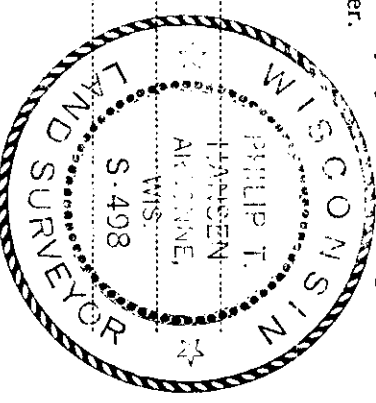

History of original corner establishment:  
 Original Corner established by Wm. E. Dougherty, from which White Pine 10" bears S38°E, 12 links, and White Pine 15" bears N13°W, 28 links.  
 Corner recovered and remonumented by Hall in 1933.  
 N. Loftus tied into this corner when surveying Section 8 & 17.

Description of corner evidence found:  
 Recovered 6 x 6" concrete monument, projecting 8" above ground, has brass cap, stamped:  
 No records or evidence of any BT recovered.

Original Cor.  
 Hall S7 S8 1933  
 S18 S17  
 T37N R10E  
 Oneida County

Description of monument and accessories I established to perpetuate the original location of this corner.  
 As monument was in excellent condition, it was left as recovered.

NBTs - Black Spruce 7" N78°E, 55.0 links  
 Black Spruce 7" S59°E, 54.0 links  
 Black Spruce 7" S28°E, 57.7 links, all scribed SC BT.

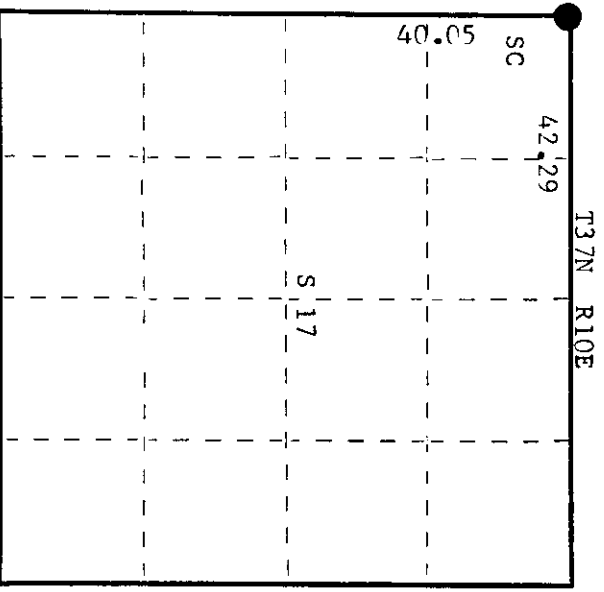

○ = Corner monument restored.

Dated at Rhinelander, Wis., this 12th day of July, 1977

Signature: *Philip T. Hansen* Title: Registered Land Surveyor Registration No. S-498  
 County Surveyor, Registered Land Surveyor, or other duly authorized official

Office of Register of Deeds, County of Oneida  
 Instrument was filed in this office for record on the 5th day of August, 1977  
 at 9:00 o'clock A.M.

Signature: *Doris Vergage Kuehn*  
 (Register of Deeds)

By: \_\_\_\_\_ Deputy

000070000