

CERTIFIED LAND CORNER RESTORATION

Index No. H-3

State of Wisconsin

County of Oneida } ss.

I, Phillip T. Hansen, do hereby certify that on the 10th day of June, 1977, I found evidence of the SC 1/16 corner of Section 7 Township 37, North, Range 10 East, Fourth Principal Meridian,

as described hereon; and that from this evidence I established a new monument and accessories as described hereon to perpetuate the original location of this corner.

Resident witnesses:

Jim Clafflin

Herb Wagoner

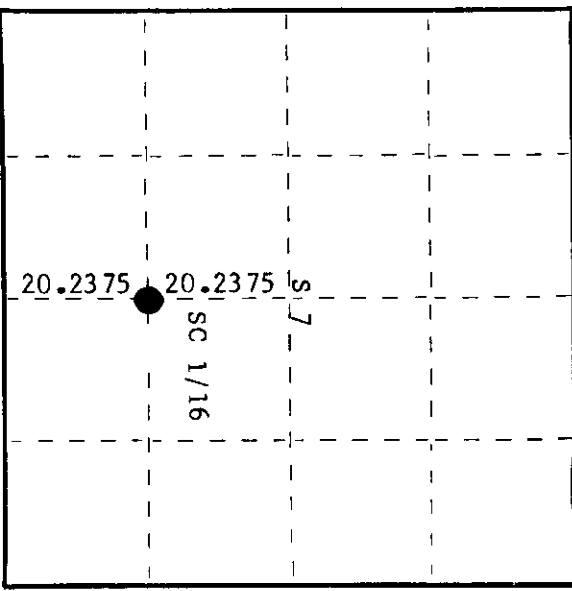
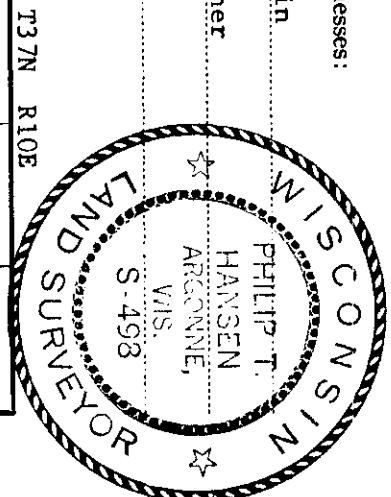

○ = Corner monument restored.

History of original corner establishment:

Corner established by N. Loftus, Ripco Surveyor, in 1958. Ran random line S 1° 25' E from center 1/4 corner, 40.495 chains to S 1/4 corner. Set SC 1/16 at 20.2475 chains intermediate. Set iron pipe and marked NBT - Black Spruce 4" N7°E, 56½ links.

Description of corner evidence found:

Recovered 1" iron pipe with 2" brass cap, stamped: Monument found in excellent condition. Recovered OBT - Black Spruce 4" (6") N7°E, 56.5 links, scribing not legible.

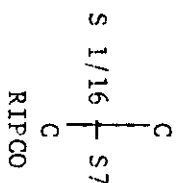

Description of monument and accessories I established to perpetuate the original location of this corner. Monument left in place. Added stamping T37N R10E to cap. Monument projects 22" above ground. NBT - Red Pine 6" N82°E, 31.3 links, scribed 1/16 BT. Monument sets 2 chains east of Cross Country road.

Dated at Rhinelander, Wis., this 15th day of June, 1977.

Signature Phillip T. Hansen Title Registered Land Surveyor Registration No. S-498  
(County Surveyor, Registered Land Surveyor, or other duly authorized official)

Office of Register of Deeds, County of Oneida, I hereby certify that the within instrument was filed in this office for record on the 30th day of June, 1977 at 9:20 o'clock A. M.

Steen Savage Tschorn  
(Register of Deeds)

By Joseph M. Brown Deputy

3710071020