

CERTIFIED LAND CORNER RESTORATION

Index No. **G-2**

State of Wisconsin

County of Oneida } ss.

I, Phillip T. Hansen, 3rd day of June, 19 77, I found evidence of the WC 1/16 corner of Section 7 Township 37, North, Range 10 East, Fourth Principal Meridian, as described hereon; and that from this evidence I established a new monument and accessories as described hereon to perpetuate the original location of this corner.

History of original corner establishment:  
Corner established by N. Loftus, Ripco Surveyor, set WC 1/16 at 21.83 1/2 chains, S85° 26' E of W 1/4 corner.  
Marked NBTs - Red Pine 9" N54°E, 76 links  
Red Pine 6" S32°W, 1.05 1/2 chains.

Description of corner evidence found:  
Recovered 1" OD iron pipe with 2" square brass cap in good condition and firmly in ground.  
Recovered OBT - Red Pine 6" (12") S32°W, 105.5 links, scribing not legible.  
Red Pine 9" (12") N57°E, 76.0 (76.3) links.  
Cap stamped:

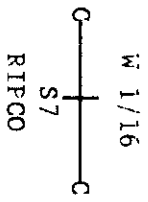

Resident witnesses:

Jim Claflin

Herb Wagoner

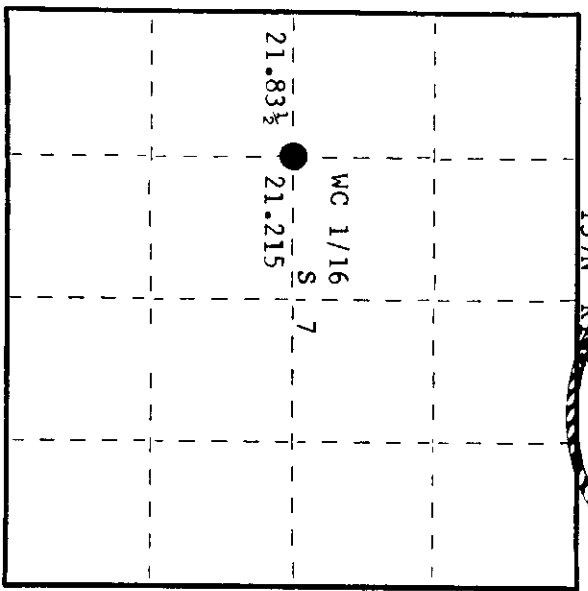
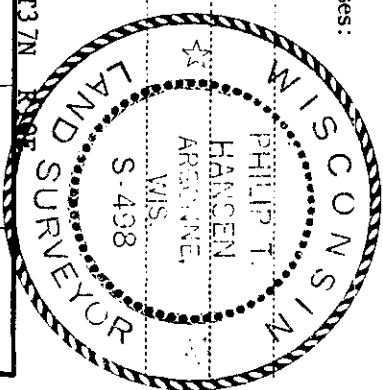

Description of monument and accessories I established to perpetuate the original location of this corner.  
Added stamping T37N R10E to cap.  
Monument projects 18" above ground.

Dated at Rhineland, Wis., this 7th day of June, 19 77.

Signature Phillip T. Hansen Title Registered Land Surveyor Registration No. S-498  
(County Surveyor, Registered Land Surveyor, or other duly authorized official)

Office of Register of Deeds, County of Oneida. I hereby certify that the within instrument was filed in this office for record on the 23rd day of June, 19 77, at 12:40 o'clock P. M.

Doreen Venegeres  
(Register of Deeds)

○ = Corner monument restored.

By: \_\_\_\_\_ Deputy

3710072030