

CERTIFIED LAND CORNER RESTORATION

Index No. **E-3**

State of Wisconsin

County of Oneida } ss.

I Phillip T. Hansen, do hereby certify that on the 10th day of June, 1977, I found evidence of the NC 1/16 corner of Section 7 Township 37N, Range 10 East, Fourth Principal Meridian, as described hereon; and that from this evidence I established a new monument and accessories as described hereon to perpetuate the original location of this corner.

Resident witnesses:

Jim Claflin

Herb Wagoner

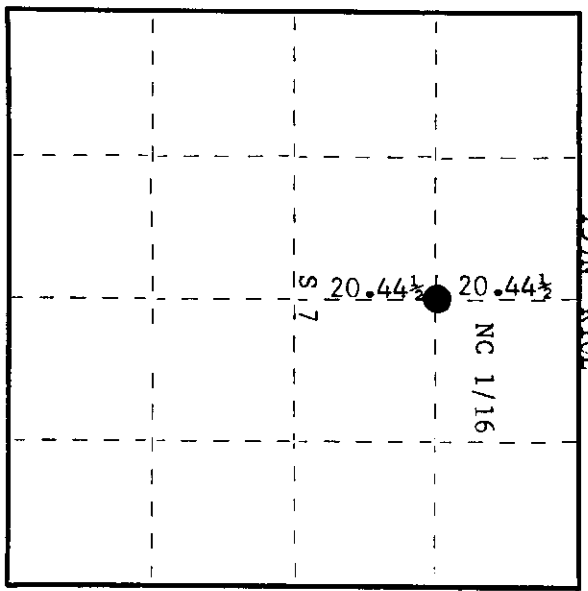
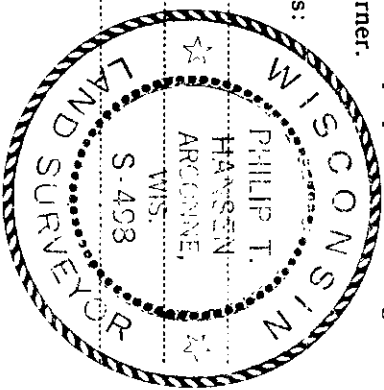

○ = Corner monument restored.

History of original corner establishment:

Corner established by N. Loftus, Ripco Surveyor, in 1958. Ran random line bearing 178° 28' 40.89 chains to close out 8 1/2 links east of center 1/4 corner. Set NC 1/16 at 20.44 1/2 chains intermediate. Marked NBT - Black Spruce 7" S84°W, 55 1/2 links.

Description of corner evidence found:

Recovered 1" iron pipe with 2" brass cap, stamped: Monument recovered in excellent condition. Recovered Black Spruce 7" (12") S84°W, 55.5 links, scribbling grown over.

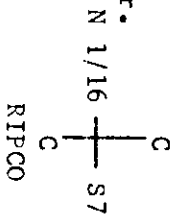

Description of monument and accessories I established to perpetuate the original location of this corner.

Monument left in place. Added stamping T37N R10E to cap. Monument projects 30" above ground. NBT - White Birch 8" N36°E, 89.6 links, scribed 1/16 BT. Corner sets 1.50 chains west of tributary of Jennie Weber Creek.

Dated at Rhineland, Wis., this 15th day of June, 1977.

Signature: *Phillip T. Hansen* Title: Registered Land Surveyor Registration No. S-498
(County Surveyor, Registered Land Surveyor, or other duly authorized official)

Office of Register of Deeds, County of Oneida. I hereby certify that the within instrument was filed in this office for record on the 23rd day of June, 1977 at 12:40 o'clock P.M.

Signature: *Lorna Savage Tucker*
(Register of Deeds)

By: Deputy

3710073020