

CERTIFIED LAND CORNER RESTORATION

Index No. J-6

State of Wisconsin

County of Oneida } ss.

I Phillip T. Hansen, do hereby

certify that on the 24th day

of June, 1977, I found

evidence of the N 1/16

corner of Section 8 & 17

Township 37, North, Range

10 East, Fourth Principal Meridian,

as described hereon; and that from this evidence

I established a new monument and accessories

as described hereon to perpetuate the original

location of this corner.

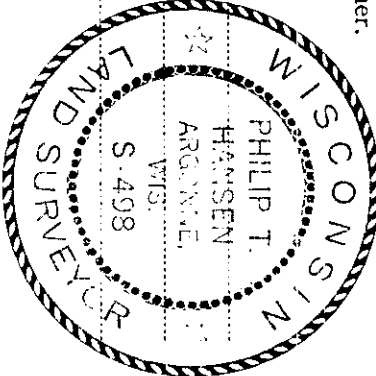

Resident witnesses:

Jim Claflin

Herb Magoner

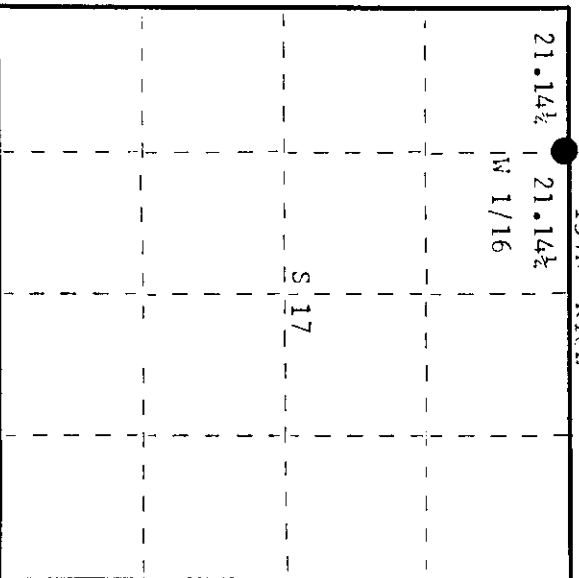

History of original corner establishment:

Corner established by N. Loftus, Ripco Surveyor. Set W 1/16 at 21.14 1/2 chains intermediate between N 1/4 and Section Corner. Bearing N 89° 35' W.

Description of corner evidence found:

Recovered 2" iron pipe with 4" square brass cap in excellent condition. Monument sets on the south side of cross country road. Cap stamped: Monument projects 20" above ground. No evidence of any BTs.

T37N R10E
S 17
W 1/16
P1PCC

Description of monument and accessories I established to perpetuate the original location of this corner.

Marked NBTs - Maple 7" N20°E, 99.0 links, scribed 1/16 BT. Maple 6" S77°E, 71.2 links, scribed 1/16 BT.

Dated at Rhineland, Wis., this 12th day of July, 1977

Signature [Signature] Title Registered Land Surveyor Registration No. S-498
(County Surveyor, Registered Land Surveyor, or other duly authorized official)

Office of Register of Deeds, County of Oneida. I hereby certify that the within instrument was filed in this office for record on the 13th day of September, 1977 at 11:02 o'clock A.M.

[Signature]
(Register of Deeds)

By [Signature] Deputy