

CERTIFIED LAND CORNER RESTORATION

Index No. E-6

State of Wisconsin } ss.
County of Oneida

I, Phillip T. Hansen, do hereby certify that on the 12th day of May, 1980, I found evidence of the NW 1/16 corner of Section 8, Township 37, North, Range 10 East, Fourth Principal Meridian, as described hereon; and that from this evidence I established a new monument and accessories as described hereon to perpetuate the original location of this corner.

Resident witnesses:

Jim Clafflin

Herb Wagoner

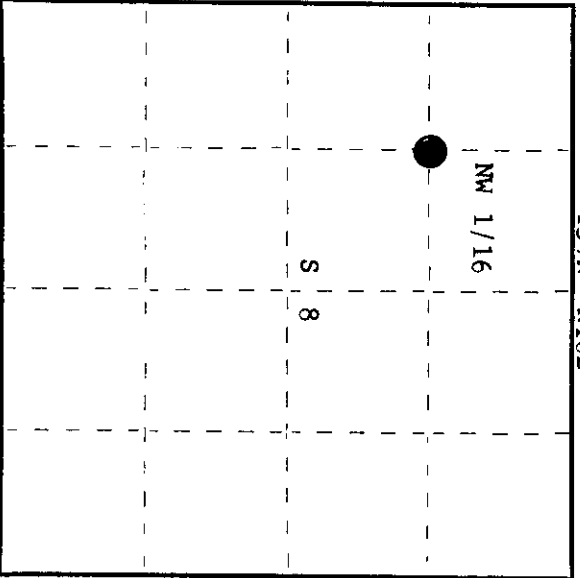
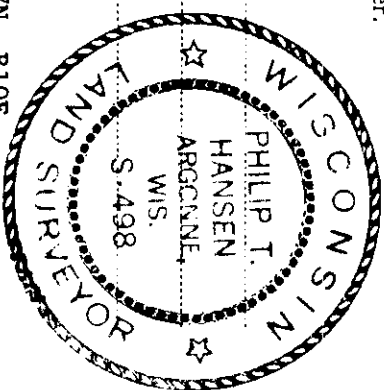

○ = Corner monument restored.

History of original corner establishment:
No records of any previous surveys.

Corner established by N. Loftus, Ripco surveyor, in 1954. From previously established N 1/16 on west line, ran east, bearing 90° 37.585 chains to close out 0.23 chains north at NW 1/16. Corrected bearing S 89° 39' E. Set NW 1/16 at intersection of true lines. Distance to the W 1/16 on north line is 20.64-3/4 chains.
No records of any BT's set.

Description of corner evidence found:

- Recovered Ripco's 3/4" iron pipe with 2" brass cap in excellent condition.
- Recovered OBT's - Balsam 7" S60°E 41.6 links.
- B. Spruce 7" S48°W 30.5 links (now dead and down).

Description of monument and accessories I established to perpetuate the original location of this corner.

Left monument in place as recovered.
Monument projects 24" above ground. Cap stamped:

- Marked NBT's - Ripco
- B. Spruce 7" S24°W 34.1 links NW 1/16
- Tamarack 5" S69°E 68.8 links S8
- both scribed 1/16 BT.

Dated at Rhineland, Wis., this 10th day of July, 1980

Signature Phillip T. Hansen Title Registered Land Surveyor Registration No. S-498
(County Surveyor, Registered Land Surveyor, or other duly authorized official)

Office of Register of Deeds, County of Oneida, I hereby certify that the within instrument was filed in this office for record on the 21st day of July, 1980 at 3:35 o'clock P. M.

Dorrie Weage Fureka
(Register of Deeds)

By Dorrie Weage Fureka Deputy

3710083030