

CERTIFIED LAND CORNER RESTORATION

State of Wisconsin } ss.

County of Oneida }

I, Phillip T. Hansen, do hereby certify that on the 14th day of May, 1980, I found evidence of the 1/4 corner of Sections 17 & 20 Township 37, North, Range 10 East, Fourth Principal Meridian, as described hereon; and that from this evidence I established a new monument and accessories as described hereon to perpetuate the original location of this corner.

Resident witnesses:

Jim Clafin

Herb Wagoner

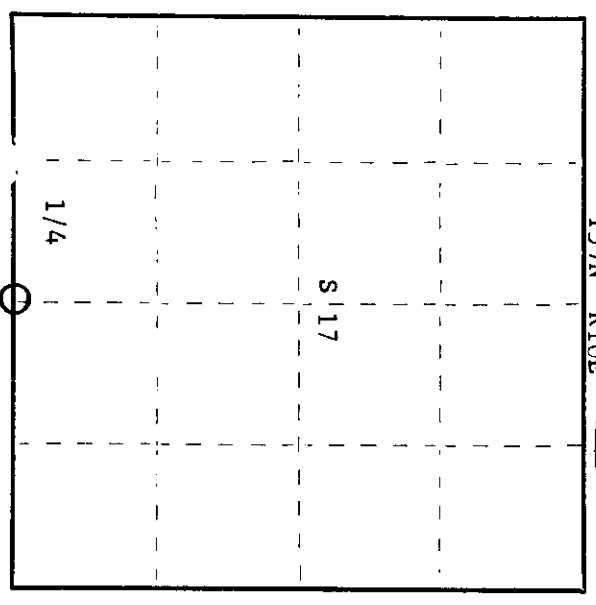
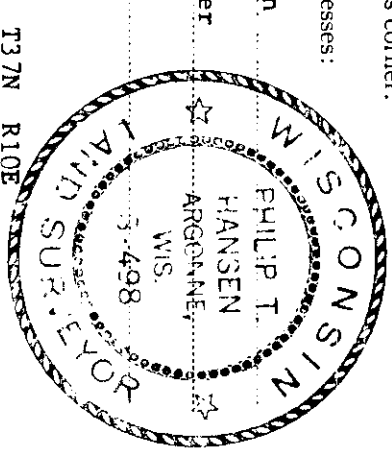

○ = Corner monument restored.

History of original corner establishment:

Original corner established by Wm. E. Dougherty, surveyor, in 1863 from which White Pine 10" bears N17°E 828 links.

N. Loftus, Ripco surveyor, recovered corner in 1958.

Marked NBT's -
B. Spruce 4" N69°W 8-1/2 feet.
B. Spruce 3" N90°E 6-1/4 feet.

Description of corner evidence found:

Recovered 2" iron pipe with 3" brass cap, stamped:
Monument projects 12" above ground.

Recovered OBT's -
B. Spruce 3" (6") N90°E 6.25 feet.
B. Spruce 4" (5") N69°W 8.50 feet.
scribed 1/4 S17 BT.
T37N R10E
S 17
1/4
S 20
RIPCO

Description of monument and accessories I established to perpetuate the original location of this corner.

Monument left as recovered.

Marked NBT's -
B. Spruce 6" N50°E 12.65 feet.
B. Spruce 6" S44°W 11.20 feet.
scribed 1/4 B.T.

Dated at Rhineland, Wis., this 22nd day of July, 1980.

Signature Phillip T. Hansen, Title Registered Land Surveyor, Registration No. S-498
(County Surveyor, Registered Land Surveyor, or other duly authorized official)

Office of Register of Deeds, County of Oneida, I hereby certify that the within instrument was filed in this office for record on the 30th day of July, 1980 at 10:15 o'clock P.M.

Donna Seeger Tucker
(Register of Deeds)

By: _____ Deputy

US PUBLIC LAND SURVEY MONUMENT RECORD

Per Wis. Admin. Code § A-E 7.08, a U.S. public land survey monument record shall be prepared and filed with the county survey records as part of any land survey within 60 days of setting or accepting the corner, which includes or requires the perpetuation, restoration, or use of a U.S. public land survey corner and when any of the situations in Wis. Admin. Code § A-E 7.08(1)(a), (b) or (c) arise.

3(a) Corner Identification:
 Found 2" iron pipe with
 3" square brass cap
 South 1/4 corner
 Section 17
 Township 37 North
 Range 10 East
 4th Principal Meridian
 Town of Stella
 Oneida Co., WI

Observed Coordinates:
 N: 182695.25
 E: 299500.12
 Datum: NAD83 (2011)
 GNSS Control: WISCRS Network
 GNSS Method: RTK-Direct
 Verification Method: 2

CORNER ID:
3710170020

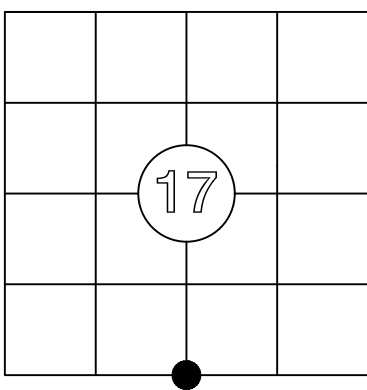

History of Original Corner Establishment

Corner Set: Wood Post
 Original Surveyor: Wm. Daugherty
 Date of Survey: August, 1863
 White pine, 10" N 17° E, 82.8 links
 No other tree near

The coordinate value has been verified by at least one of the following methods: 1) comparison to a previously GNSS determined published value; 2) The value is the average of two or more GNSS observations at markedly different times; 3) one or more distances were measured to the corner from temporary GNSS observed offset locations.

3(b)((c)(d)(f)(g)(h))

This is a continuation of a previous USPLSS Monument Record by Surveyor Philip Hansen (1980). See previous record for additional history on this corner.

- 7/30/1980 - Philip Hansen, S-498, finds a 2" iron pipe with a 3" square brass tablet, set by Norm Loftus (Ripco) in 1958, in good condition, 12" above grade, stamped to identify the corner.
- 6/28/1995 - Kip Soder, S-1731, finds a 2" brass tablet by Loftus (Ripco).
- 11/3/1997 - Kip Soder, S-1731, finds a 2" brass tablet by Loftus (Ripco).
- 2/8/2007 - Russ Brown, S-2148, finds a 1 1/2" iron pipe with brass cap.
- 12/22/2025 - I, Anthony Jones, S-2508, found an 3" square brass tablet on a 2" iron pipe, 12" above grade, as set by Loftus (1958) and recovered by Hansen and others. I set new nails in the witness trees as noted below.

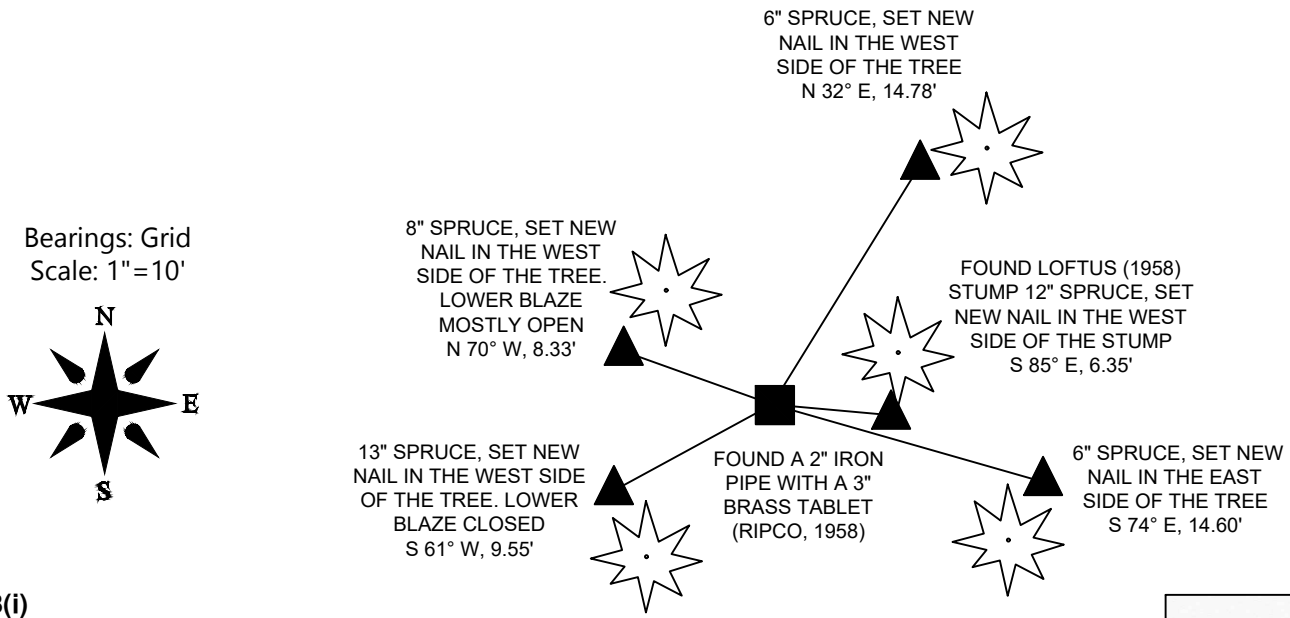

3(i)
 I, Anthony R. Jones, Wisconsin Professional Land Surveyor No. S-2508, hereby certify that the corner location shown on this record was determined by me, or under my direction or control, and that this U.S. Public Land Survey Monument Record is correct and complete to the best of my knowledge and belief.

