

U.S. PUBLIC LAND SURVEY MONUMENT RECORD

Note: This form is intended and designed to fulfill all requirements of Wisconsin Administrative Code, Chapter A-E 5.02, U.S. Public Land Survey Monument Record (3) (a) (b) (c) (d) (e) (f) (g) (h) (i). An additional sheet may be added if necessary to conform with said requirements.

(a) Corner location: Township 37 North
 Range 10 East/West

Town/City/Village of STELLA

County OF ONEIDA

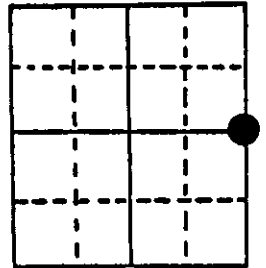

Section 26

(b) (f) (g) (h) Description of monument found at this corner and if it was accepted, state all evidence (material, testimonial, occupational, plats, records, other monuments) used as a basis for accepting. If not accepted or if nothing was found, state evidence used as basis for establishing location. If reestablished through lost corner proportionate methods, indicate all monuments, distances and directions used to establish.

- 1863 William E. Daughterty set original corner.
- 1929 Harry C. Hall found no evidence of orig. cor. Mr. Hall proportioned corner while subdividing Sec. 26. He set a 1 1/2" x 48" iron pipe and made two bearing trees; W Birch 5 S 28 E 36.0' ; W Birch 8 N 74 W 89.8'

At this corner I found the 1 1/2" iron pipe. The distances to the north and west checked reasonably well with Halls so I accepted the pipe for the location of the corner. I did not find Halls B.T.s.

(c) (d) (e) Plan view of corner with ties to at least 4 witness monuments. If in disagreement with previously established corner, show the distances between the two corners and also indicate the ties to the disputed corner.

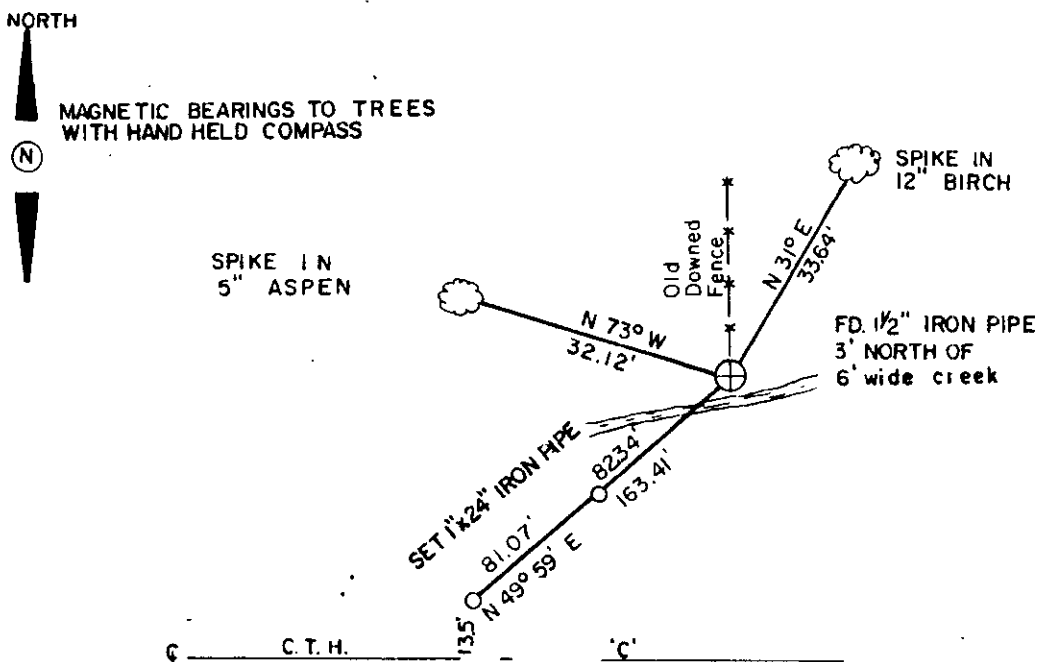

(i) I, MICHAEL J. ROMPORTL R.L.S. 1624
 (type or print name) certify that the corner location on this record was determined by me or under my direction and control and that this U.S. Public Land Survey Monument Record is correct and complete to the best of my knowledge and belief.

Michael J. Romportl December 4, 1984
 Signature Date
 GENISOT & ASSOCIATES, INC.
 RHINELANDER, WIS.

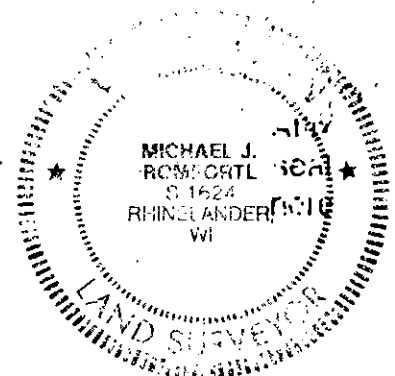

Index No. 7-21

3710262000

Record (3)(a)(b)(c)(d)(e)(f)(g)(h)(i).

U.S. PUBLIC LAND SURVEY MONUMENT RECORD

Note: This form is intended and designed to fulfill all requirements of the Wisconsin Administrative Code, Chapter A-E 7.08 U.S. Public Land Monument. An additional sheet may be added if necessary to conform with said requirements.

(a) CORNER LOCATION: Oneida County Corner I.D. No.:

East 1/4 Corner, Sec. 26 3710262000
Township 37 North
Range 10 East
Town of Stella
County of Oneida

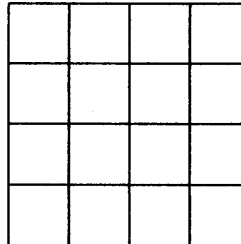

SECTION 26

(f)(g)(h) DESCRIPTION OF MONUMENT FOUND AT THIS CORNER AND IF IT WAS ACCEPTED, STATE ALL EVIDENCE (MATERIAL, TESTIMONIAL, OCCUPATIONS, PLATS, RECORDS, OTHER MONUMENTS) USED AS A BASIS FOR ESTABLISHING LOCATION. IF NOT ACCEPTED OR IF NOTHING WAS FOUND, STATE EVIDENCE USED AS BASIS FOR ESTABLISHING LOCATION. IF REESTABLISHED THROUGH LOST CORNER PROPORTIONATE METHODS, INDICATE ALL MONUMENTS, DISTANCES AND DIRECTIONS USED TO ESTABLISH. INDICATE TYPE OF MONUMENT AND SIGN POST FOUND OR SET.

DECEMBER 4, 1984 - U.S. PUBLIC LAND SURVEY MONUMENT RECORD BY MIKE ROMPORTL. SET TIES AS SHOWN ON U.S. PUBLIC LAND SURVEY MONUMENT RECORD.

JUNE 3, 2011-A.R. JONES FOUND CORNER AS DESCRIBED. CORNER OUT OF CONSTRUCTION AREA, SO TIES TO BEARING TREES NOT VERIFIED. TIE TO IRON PIPE AT S 49°59' W, 82.34 FEET FOUND AND OUT OF CONSTRUCTION AREA. TIE TO IRON PIPE AT S 49°59' W, 163.41 FEET FOUND AND IS WITHIN CONSTRUCTION AREA. NEW TIES WERE PLACED AS SHOWN BELOW. NEW TIES ARE ALL INTERVISIBLE FROM PIPE AT S 49°59' W, 82.34'

NOVEMBER 8, 2011- WITNESS CORNER AT S 49°59' W, 163.41' OBLITERATED DURING RECONSTRUCTION OF HIGHWAY C.

(c)(d)(e) PLAN VIEW OF CORNER WITH TIES TO AT LEAST 4 WITNESS MONUMENTS. IF IN DISAGREEMENT WITH PREVIOUSLY ESTABLISHED CORNER, SHOW THE DISTANCE BETWEEN THE TWO CORNERS AND ALSO INDICATE THE TIES TO THE DISPUTED CORNER.

WITNESS MONUMENT TIES:

- 1: FOUND SPIKE IN 5" ASPEN, N 73° W, 32.12'
- 2: UNVERIFIED 12" BIRCH DUE TO ELECTRIC FENCE
- 3: FOUND 5/8" BY 30" IRON ROD S 23°50'53" W, 199.61'
- 4: FOUND 1" IRON PIPE S 49°59' W, 82.34'
- 5: FOUND 5/8" BY 30" IRON ROD S 68°00'33" W, 136.23'
- 6: FOUND 5/8" BY 30" IRON ROD S 71°50'06" W, 161.92'

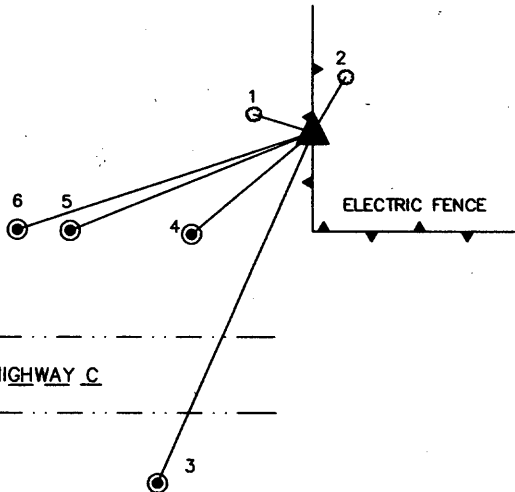

Scale: 1"=100'

NORTH BASED ON MONUMENT RECORD BY MIKE ROMPORTL, DECEMBER 4, 1984 IRON PIPE TIES, ASSUMED TO BEAR: S 49°59' W

(i) I, ANTHONY R. JONES, REGISTERED LAND SURVEYOR NO. S-2508 HEREBY CERTIFY THAT THE CORNER LOCATION ON THIS RECORD WAS DETERMINED BY ME OR UNDER MY DIRECTION AND CONTROL AND THAT THIS U.S. PUBLIC LAND SURVEY MONUMENT RECORD IS CORRECT AND COMPLETE TO THE BEST OF MY KNOWLEDGE AND BELIEF.

[Signature]
SIGNATURE
11/9/11
DATE

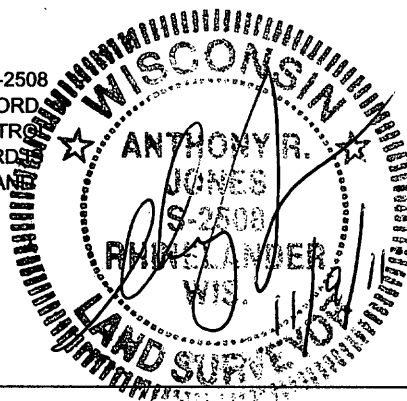

INDEX NO. T 21

3710262000