

CERTIFIED LAND CORNER RESTORATION

Index No. V-17

State of Wisconsin

County of Oneida } ss.

I, Phillip T. Hansen, do hereby certify that on the 21st day of August, 1975, I found evidence of the Section corner of Sections 26, 27, 34, and 35 Township 37 North, Range 10 East, Fourth Principal Meridian, as described hereon; and that from this evidence I established a new monument and accessories as described hereon to perpetuate the original location of this corner.

Resident witnesses:
Glen Barker
Jim Clafflin

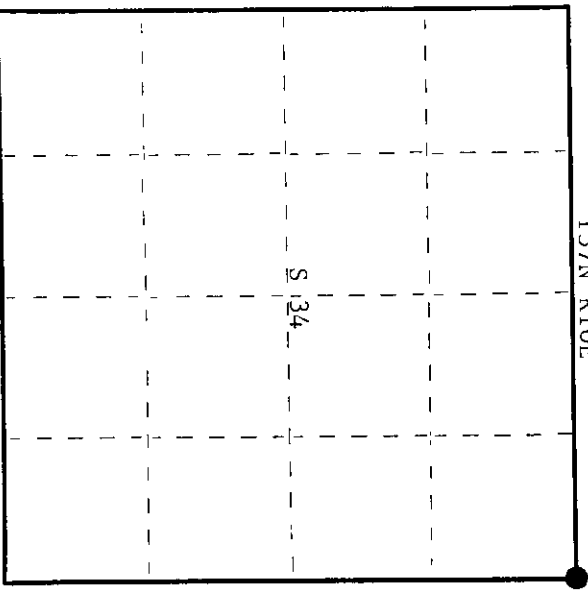
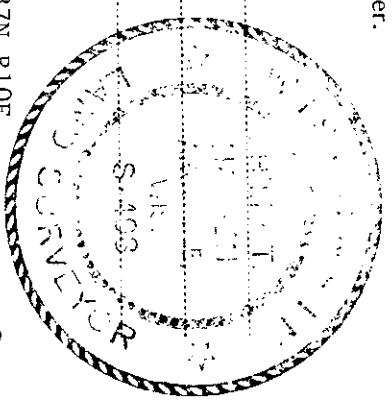

○ = Corner monument restored.

History of original corner establishment:
Original corner established by Wm. E. Dougherty, Government Deputy Surveyor, in 1863. Corner restored by D.H. Vaughan, County Surveyor. Corner re-established by H.C. Lawrence, Registered Land Surveyor, in 1958, no evidence of corner at this date. In 1946, he had visited this corner and found Vaughan's old scribed post and two white pine scribed, which agreed with Vaughan's notes. This post was in line with a road west. There was a fence line running east, 37 links north of the center line of the road west. Set 5" cedar post as witness corner 37 links east of the corner.

Description of corner evidence found:
Recovered 5" cedar post, squared and scribed S34 W.C. S35, S26, S27, in good condition. No OBT's were recovered.

Description of monument and accessories I established to perpetuate the original location of this corner.
Replaced cedar post with 2-1/2" iron pipe w/brass cap stamped - S498
NBT's: White birch 10" S64°E 52.1 links - scribed SC BT. T37N R10E
White birch 6" N41°E 80.3 links - scribed SC BT.

Sec. 27/26
34/35 W.C.
West 37 Links
CPI-1975

Dated at Rhineland, Wis., this 29th day of September, 1975.

Signature Phillip T. Hansen Title Registered Land Surveyor Registration No. S-498
(County Surveyor, Registered Land Surveyor, or other duly authorized official)

Office of Register of Deeds, County of Oneida
Instrument was filed in this office for record on the 17th day of November, 1975
at 10:08 o'clock a.m.

Signature Doris Verage Fuehn
(Register of Deeds)

By _____ Deputy

3710270000

Note:

As the majority of the following history is related to Section 26, the NW corner of S.35 and related corners will be referred to as being the SW corner of S.26 and so on.

- 1863- W.E. Dougherty set post for corner to sections 26, 27, 34 and 35.
- 1906- D.H. Vaughan found the section corner from the original B.T.'s, set a new post and made two new B.T.s - W. pine 18 S83°E 14lks; W. Pine 18 S10°W 10lks.
- 1929- H.C. Hall recovered the corner as perpetuated by Vaughan, set a 1-3/4" iron pipe in the old stake hole and retied Vaughan's 1906 B.T.'s (now stumps) - S85°E, 9.3' and S15-1/2°W, 6.6'. He also noted - "Ledge of rocks noted by U.S. deputy consists of about 3 boulders". He then marked a "cross" on a 3' x 5' boulder at S46°E, 60.7'
- 1973- Herbert Moore set P.K. nail in centerline of town road on extension of fence line running east and a 2" iron pipe E'y, 20.7' on same fence as a witness. He notes, he did not find Hall's boulder or the W. pine stump 9.3' West.
- 1975- Philip T. Hansen (C.P.L.) recovered a 5" cedar post, squared and scribed, he believed to be a witness post set by H.C. Lawrence. He replaced the wood post with a 2-1/2" brass-capped iron pipe noting it to be 37 links East of the section corner in the road.
- 1992- Todd J. Loftus, in surveying the South line of Sec. 26, recovered Hall's boulder near the SW corner of S.26 and reset the corner based on Hall's record distance from the boulder and from the SE corner of S.26. He set an unstamped capped aluminum monument and Loftus' records show he tied it to an 8" Birch, N61°E, 25.19'; Moore's witness pipe, S75°E, 9.52'; and Hansen's witness pipe, S24°E, 30.43'.
- 1998- Glen Barker (C.P.L.) accepted Loftus' section corner for the NW corner for their sub-division of Section 35.
- 1999- I, Keith A. Zorn, in surveying the N1/2 of the NW1/4 have reset the NW cor. of S.35 based on my belief that Hall incorrectly apportioned error into his measurement of the South line of S.26.

As part of Hall's 1929 survey, he was charged with subdividing Section 26. In closing his traverse he found 0.005 ch excess in the N'ing and 0.069 ch excess in the E'ing. He noted - "Conclude we gained about 0.05 on South Line 26 (between 50.00 & 70.00)"; the area of 50.00 & 70.00 ch.s being in the East 1/2 of the South line of S.26. He measured 81.769 ch(5396.75') along his original random and due to difficult terrain and traverse conditions he believed error to be in the E'y end of his traverse of the south line.

I set the NW corner of S.35 on a true bearing at Hall's record bearing and distance from his boulder. From this point to the NE cor of S.35 I measured 5396.29' (81.762 ch).

When he placed the error into this line, he set it up at 81.72 ch and set the S1/4 on line at 40.86 ch (2696.76'). This point falls very close to the South end of an old barbed wire fence I believe to be on Hall's N-S 1/4 line.

Also, Hall traversed from the SW corner to the W1/4 of S.26 and measured 2686.86'. From my section corner location to the W1/4, I measured 2685.55'.

I believe Hall's closure error was somewhere else in his traverse and he incorrectly placed it in the South line of S.26. I believe this corner to be a perpetuation of Hall's and the original location of the NW corner of Section 35 and restored it as shown on the reverse.

