

# U.S. PUBLIC LAND SURVEY MONUMENT LOCATION RECORD

Recorders Data

CORNER: NW Section SECTION: 33 TOWNSHIP 37 NORTH RANGE 10 EAST/WEST

FOR M.C. CORNER INDICATE: NAME OF WATERWAY N/A SECTION LINE N/A

(CITY)(VILLAGE)(TOWN) OF: Stella COUNTY OF: Oneida

Description of monument found or placed and all other evidence used as the basis for monument location; including monuments and related measurements required if the corner location was reestablished by lost corner proportionate methods. Also indicate name of the original surveyor, original survey date, the corner monument, bearing trees, witness or other reference monuments established, including measured bearing and distance ties, from available records.

Found and accepted a standard and undisturbed 2" dia. iron pipe with stamped brass cap by 1953 BLM Resurvey flush with existing grade. I placed a double layer ring of 6" dia. +/- rocks around the monument as a protective cairn and set a standard white poly marker 'T' post 23" East and 26" West. The corner falls within a grassy triangular area at the junction of existing dirt roadways to the North, East and South, surrounded by cleared/cultivated fields with no bearing trees evidenced or existing for referencing purposes. The corner is accessible by vehicle from Deer Horn Road about 1/2 mile East. In 1863, Daugherty/GLO set a wood post as the original corner and marked OBTs, a 10" Py S66°E 15 lks and a 12" Pw N38°W 28 lks, which are all now obliterated. In 1914, Vaughn found a wood post at corner by Dorr and noted the NW Pw OBT as a stump and the SE Py OBT as a burned 8' high stub, but noted no new BTs. In 1953, Crawford/BLM during a resurvey, found and accepted a 4" square x 24" long cedar post, rotted off at grade, with a 1" dia. iron pipe along side of post and replaced both at the corner location with a standard 2" dia. by 30" long iron pipe monument with stamped BLM brass cap 4" above grade, but noted no existing BTs or new references as none were available. In 1977, W. Bandow notes a 2 1/2" BLM iron pipe at this corner per his Plat of Survey filed as C-331 in Oneida County survey records. In 1977, Rein notes he found a 2" iron pipe with BLM brass cap at corner per his County Plat of Paradise Acres filed in Oneida County records. This recovery completed October 19, 1998; there were no witnesses.

This corner location considered ideal for GPS control station purposes as canopy clear.

Plan view map of monument location with bearing and distance ties to a minimum of four(4) described witness or reference monuments of concrete, natural stone, iron, live bearing trees or equivalent material. If applicable, also show a minimum of two(2) bearing and distance ties to any other monument found and not accepted; including the bearing and distance from the accepted corner monument.

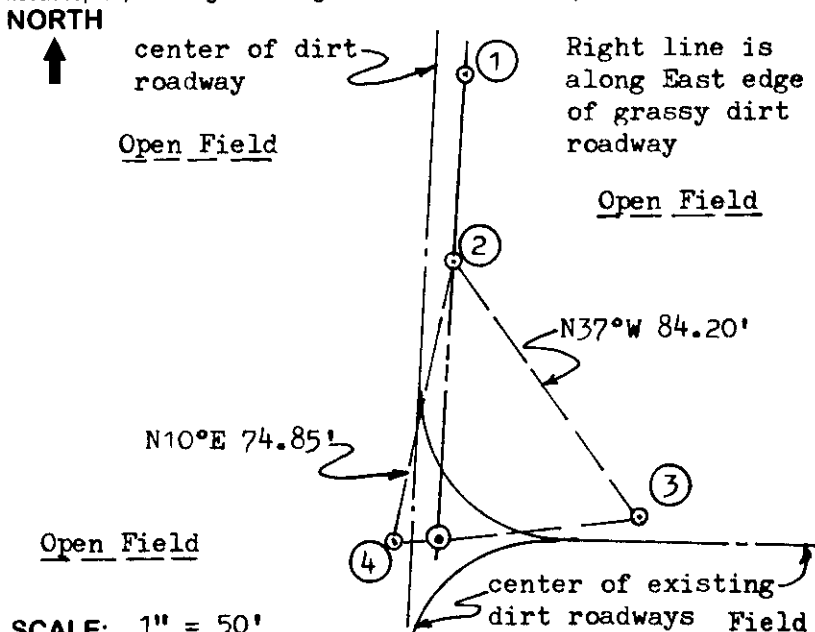

### WITNESS MONUMENT TIES:

- ① 1" dia. by 24" long iron pipe set with standard yellow poly cap stamped Reference Mark flush with existing grade N03°E 120.60'.
- ② Same iron pipe monument set N03°E 73.05'.
- ③ Same iron pipe monument set N84°E 52.70'.
- ④ Same iron pipe monument set S86°W 11.12'.

Note: Witness monuments at 1 and 2 were set on a right line with transit--through corner center.

SCALE: 1" = 50'

Unless otherwise indicated, all bearing tree ties are to a .25" dia. by 2.5" long PK nail with a 1.25" dia. steel washer driven into unblazed right face and a .25" dia. by 2.5" long PK nail with a 2" dia. steel washer stamped 'BT' is also driven into unblazed face of bearing tree at DBH; the basis for measured bearings is magnetic to nearest degree and all tie distances are horizontal measure to nearest 1/100th feet.

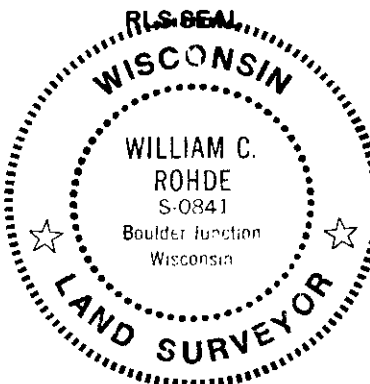

### PROFESSIONAL LAND SURVEYOR CERTIFICATION:

I, William C. Rohde, hereby certify that I am a duly licensed Professional Land Surveyor in the State of Wisconsin, that this USPLS monument location was determined by me or under my direction and control and that this U.S. Public Land Survey Monument Location Record is true and correct to the best of my knowledge and belief.

*William C. Rohde* Date: 02-10-99  
Signature

		33	

INDEX NO.

This form is intended to fulfill requirements of Chapter A-E 7.08 (3)(a)(b)(c)(d)(e)(f)(g)(h)(i) U.S. Public Land Survey Monument Location Record, Wisconsin Administrative Code. Use reverse side for geodetic location data and/or continuation purposes.

SECTION DIAGRAM LOCATION MAP

INDEX NO. V9

3710 290000