

This form is intended to fulfill the requirements of Chapter A-E 7.08 (3)(a) thru (i) U.S. Public Land Survey Monument Location Record, Wisconsin Administrative Code. Use the reverse side of form for continuation.

**U.S. PUBLIC LAND SURVEY MONUMENT LOCATION**

Recorders Data

USPLS CORNER: WEST 1/4 SECTION: 32 TOWNSHIP: 37 NORTH RANGE: 10 EAST

NAME OF WATERWAY FOR M.C. CORNER : N/A SECTION LINE: N/A

(CITY)(VILLAGE)(TOWN) OF: STELLA COUNTY OF: ONEIDA

Description of monument found or placed and all other evidence used as the basis for monument location; including monuments and related measurements required if the corner location was reestablished by lost corner proportionate methods. Also indicate name of original surveyor, original survey date and the corner monument, bearing trees, witness or other reference monuments established; including measured bearing and distance ties, from available records.

Found and accepted an old rusted 1.5" dia. iron pipe monument with plain coupling at top and flush with grade in an open grassy roadside area at this corner location, which I pulled and reset with a standard 2" dia. by 30" long aluminum pipe monument with stamped Oneida County cap flush with grade and I left the old iron pipe flat on grade nearby. The corner falls about 35 feet north of the centerline of an East/West gravelled roadway curve and about 30 feet south of the south edge of a brushy wooded area North of the corner.

In August 1863, William E. Daugherty/GLO set a wood post as the original corner and marked OBTs: A 12" Bw S87°E 34 links and an 8" Bw N32°W 31 links; all of which are now obliterated.

In August 1975, Harold W. Behm/RLS 1221 of Wilderness Surveying, Inc Woodruff, Wisconsin notes a 2" iron pipe with a 3" plumbers cap(coupling) found and accepted in place at this corner location per Plat of Survey filed as C-315 in Oneida County survey records.

In November 1977, James D. Rein/RLS1234 of Wilderness Surveying, Inc. Woodruff, Wisconsin also notes a 2" dia. iron pipe with plumbers cap(coupling) at this corner location per county plat of Paradise Acres filed in Oneida County records.

This recovery completed July 6, 2000; there were no direct witnesses other than vehicle drive-bys.

Plan view map of monument location with bearing and distance ties to a minimum of four(4) described witness or reference monuments of concrete, natural stone, iron, live bearing trees or equivalent material. If applicable, also show a minimum of two(2) bearing and distance ties to any other monument found and not accepted; including the bearing and distance from the accepted monument.

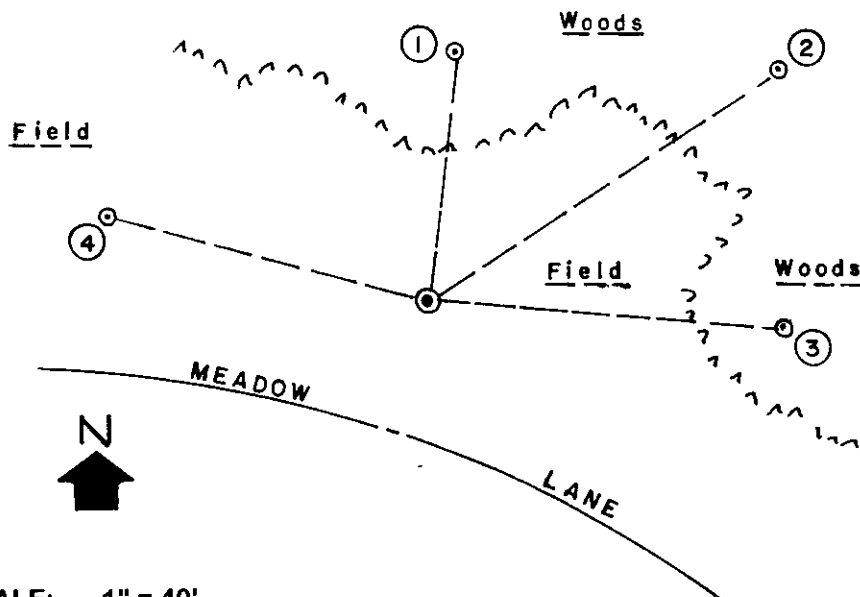

**WITNESS MONUMENT TIES:**

- ① New BT SE 8" Or of two N06°E 51.62'.
- ② New BT NW 8" Bw of two N56°E 87.75'.
- ③ New BT 5" Or S86°E 74.60'.
- ④ Old 3/4" dia. iron pipe found with uncapped top flush N75°W 68.75' (68.56' recorded) at Curve Point No. 1 per Paradise Acres Plat.

Standard white poly 'T' marker post set 6" South of the corner monument.

SCALE: 1" = 40'

Unless otherwise indicated, all bearing tree ties are to a .25" dia. by 2.5" long PK nail with a 1.25" dia. steel washer driven into unblazed right face and a .25" dia. by 2.5" long PK nail with a 2" dia. steel washer stamped BT is also driven into unblazed face of bearing tree at DBH; the basis for measured bearings is by compass to nearest degree and all tie distances are measured horizontal by steel tape corrected to nearest 1/100th feet at standard temperature of 68° F.

RLS SEAL:

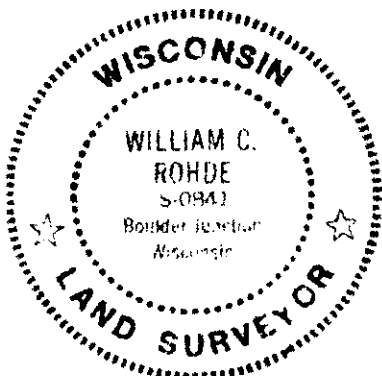

**LAND SURVEYOR CERTIFICATE:**

I, William C. Rohde, hereby certify that I am duly licensed as a Professional Land Surveyor in the State of Wisconsin; that this USPLS monument location was determined by me and/or under my direct supervision and control; and that this U.S. Public Land Survey Monument Location Record is true and correct to the best of my knowledge and belief.

Signed: *William C. Rohde*  
William C. Rohde RLS 841

Date Signed: January 31, 2001

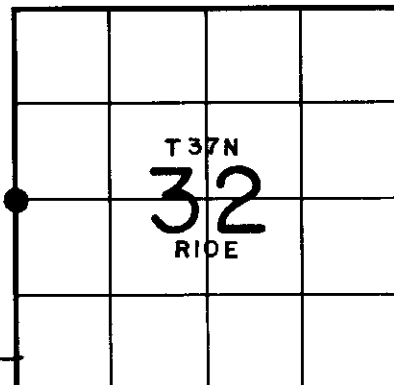

SECTION LOCATION MAP

INDEX NO. \_\_\_\_\_

3710312000