

CERTIFIED LAND CORNER RESTORATION

Index No. **A 18**

State of Wisconsin

County of Oneida } ss.

I, Philip T. Hansen, do hereby certify that on the 21st day of August 1975, I found evidence of the W-1/16 corner of Sections 2 and 35 Township 36 and 37 North, Range 10 East, Fourth Principal Meridian, as described hereon; and that from this evidence I established a new monument and accessories as described hereon to perpetuate the original location of this corner.

Resident witnesses:

Glen Barker

Jim Clafflin

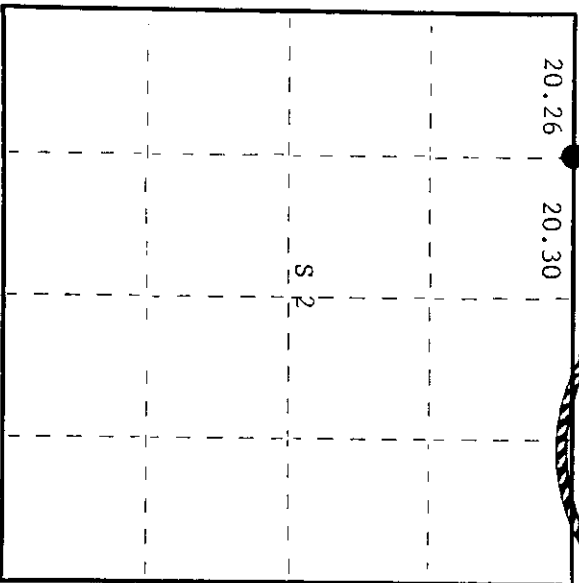
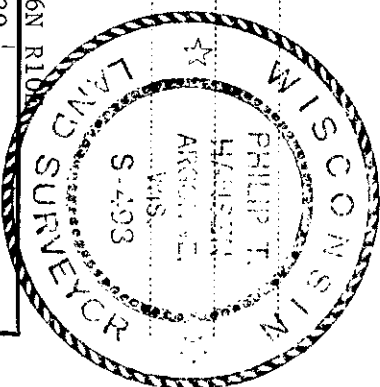

○ = Corner monument restored.

History of original corner establishment:

Corner established by D.H. Vaughan, County Surveyor, in 1906. He set a brake staff, with wheel attached, buried in the road. Corner recovered by H.C. Lawrence, Registered Land Surveyor, in 1950. With the aid of a Mr. Rasmussen, he found the staff and wheel attached still intact, buried in the road. This agrees with fence line running south at 20.26 chains east of Section Corner. Marked NBT's: Lone white pine 20" S18-1/2°E, 60 links. Highline pole 36-10 2W4 - S43-1/2°W, 41 links.

Description of corner evidence found:

Recovered 1" shaft buried in the center line of East-West road as set by D.H. Vaughan.

Recovered OBT's: White pine 20" (22") S18°30'E 60 links (67 links) - scribed S4 (mistake)

Also noted an error of 7 links on his measurement.
Highline pole #36-10 S43°30'W 41 links.

Description of monument and accessories I established to perpetuate the original location of this corner.

Set a 1-1/2" OD iron pipe with 2" brass cap for witness corner 36 links north of true corner. Stamped brass cap as follows -

S498
S36 links
T37N R10E

No additional accessories established.

W-1/16 S/35 S/2 W.C.

T36N R10E
CPI-1975

371035 0030

Dated at Rhineland, Wis., this 10th day of September, 1975.

Signature: *Philip T. Hansen* Title: Registered Land Surveyor Registration No. S-498
County Surveyor, Registered Land Surveyor, or other duly authorized official

Office of Register of Deeds, County of Oneida. I hereby certify that the within instrument was filed in this office for record on the 17th day of November 1975 at 10:00 o'clock A.M.

Bernice Bernage Kasper
(Register of Deeds)

By: Deputy