

CERTIFIED LAND CORNER RESTORATION

Index No. W-21

State of Wisconsin

County of Oneida

} ss.

I, Phillip T. Hansen, do hereby certify that on the 22nd day of February, 1978, I found evidence of the N 1/16 corner of Sections 35 & 36 Township 37, North, Range 10 East, Fourth Principal Meridian, as described hereon; and that from this evidence I established a new monument and accessories as described hereon to perpetuate the original location of this corner.

Resident witnesses:

Glen Barker

Jim Clafin

Herb Wagoner

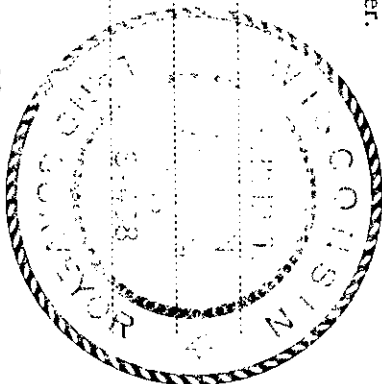

History of original corner establishment:
Corner established by H.C. Lawrence, Registered Land Surveyor, in 1949. Ran random line north from 1/4 corner between sections 35 & 36, 40.61 chains to close out 84 links west of section corner.
Set N 1/16 at 20.30½ chains and 42 links east
Set 4" cedar post and made BR's - cedar 16" N20°E, 45 links
tamarack 3" 889°E, 29 links

Description of corner evidence found:

Recovered H.C. Lawrence's 4" cedar post, squared and scribed S35 - N 1/16 - S36.
Post in poor condition.
Recovered OBTs - cedar 16" (18") N20°E, 45 links, scribed N 1/16 S36 BT.
tamarack 3" S89°E, 29 links - down and rotted, scribe marks visible, but not legible.

Description of monument and accessories I established to perpetuate the original location of this corner.

Replaced post with a 1½" o.d. iron pipe with 2" brass cap, stamped:
Projects 18" above ground.

S498

T37N R10E

N 1/16 35 + 36

CPI-1978

NBT - black spruce N28°W, 38.1 links,
scribed 1/16 BT.

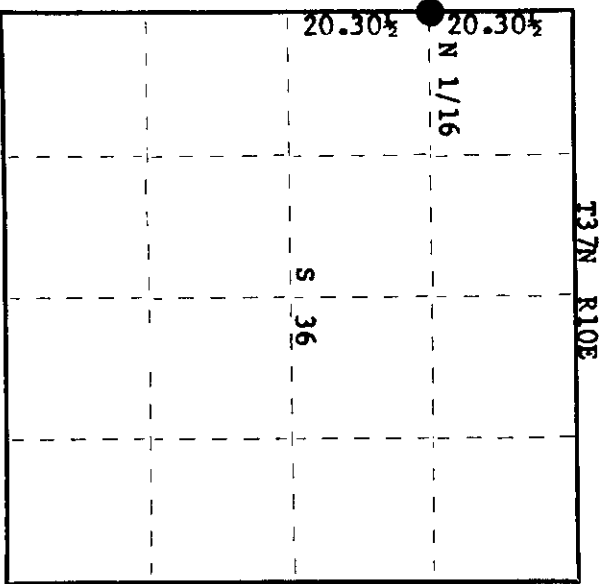

○ = Corner monument restored.

Dated at Rhineland, Wis., this 7th day of March, 1978.

Signature Phillip T. Hansen Title Registered Land Surveyor Registration No. S-498
(County Surveyor, Registered Land Surveyor, or other duly authorized official)

Office of Register of Deeds, County of Oneida
Instrument was filed in this office for record on the 13th day of March, 1978
at 2:30 o'clock P. M. I hereby certify that the within

Doris Verage Fisher
(Register of Deeds)

By: _____ Deputy