

CERTIFIED LAND CORNER RESTORATION

Index No. E-6

State of Wisconsin }
County of Oneida } ss.

History of original corner establishment:
No records of any previous survey.

I Phillip T. Hansen, do hereby certify that on the 22nd day of January, 1980, I ~~restored~~ re-established the W 1/16 corner of Section 5 & 8 Township 37, North, Range 11 East, Fourth Principal Meridian, as described hereon; and that from this evidence I established a new monument and accessories as described hereon to perpetuate the original location of this corner.

Resident witnesses:

Glen Barker
Jim Clafflin
Herb Wagoner

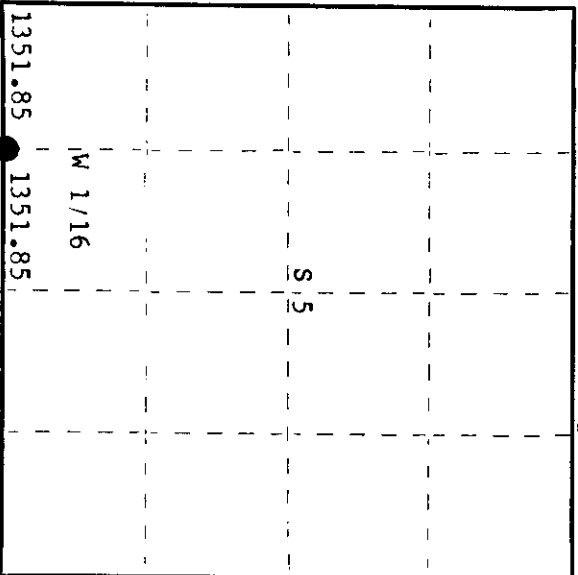
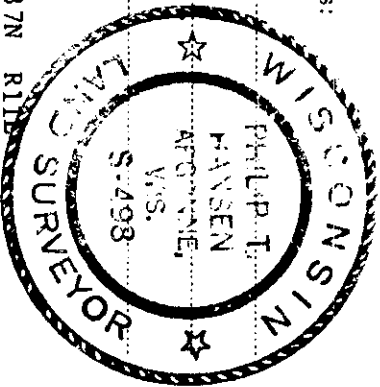

○ = Corner monument restored.

Description of corner evidence found:

Corner established by traverse and computation. Ran traverse west from 1/4 corner between Sections 5 and 8 to section corners 5, 6, 7 and 8. Computed distance is 2703.70 feet at bearing S 89° 04' 28" W. Set W 1/16 corner at 1351.85 feet Intermediate. At this location found an old squared stake and a 2-1/2" well point S 68° W 2.63 feet from our location.

Description of monument and accessories I established to perpetuate the original location of this corner.

Set a 1-1/2" iron pipe with 2" brass cap, stamped:
Set this monument at our computed position.

Monument projects 18".
Marked NPT's - Sugar 7" S29°E 69.89 feet
W. Birch 7" N52°W 39.37 feet
both scribed 1/16 BT.
S498
T37N R11E
W 1/16 S+5
CPI-1980

Dated at Rhineland, Wis., this 28th day of January, 1980.

Signature Phillip T. Hansen Title Registered Land Surveyor Registration No. S-498
(County Surveyor, Registered Land Surveyor, or other duly authorized official)

Office of Register of Deeds, County of Oneida
at 2:15 o'clock P. M. 11th day of February, 1980
I hereby certify that the within instrument was filed in this office for record on the

Doris Therese Fuchs
(Register of Deeds)

By: _____ Deputy