

CERTIFIED LAND CORNER RESTORATION

Index No. D-6

State of Wisconsin }  
County of Oneida } ss.

History of original corner establishment:  
No records of any previous survey.

I, Phillip T. Hansen, do hereby certify that on the 29th day of January, 1980, I ~~restored~~ established the SW 1/16 corner of Section 5

Township 37, North, Range 11 East, Fourth Principal Meridian, as described hereon; and that from this evidence I established a new monument and accessories as described hereon to perpetuate the original location of this corner.

Resident witnesses:

Glen Barker

Jim Clafflin

Herb Wagoner

Description of corner evidence found:  
No evidence of any corner recovered.  
Corner established by traverse and computation. The computed distance from the W 1/16 corner between section 5 and 8 to the WC 1/16 is 2879.67 feet at bearing N 5° 44' 48" W. The computed location of the SW 1/16 is 1439.83' N 5° 44' 48" W of the W 1/16 corner and 1439.84 feet, S 5° 44' 48" E of WC 1/16.

Description of monument and accessories I established to perpetuate the original location of this corner.  
Set a 1-1/2" iron pipe with 2" brass cap, projecting 18", stamped:  
Marked NBT's - Balsam 6" S54°W 3.13 feet  
Balsam 6" N26°E 20.00 feet  
both scribed 1/16 BT.  
S498  
T37N R11E  
SW 1/16 S 5  
CPI-1980

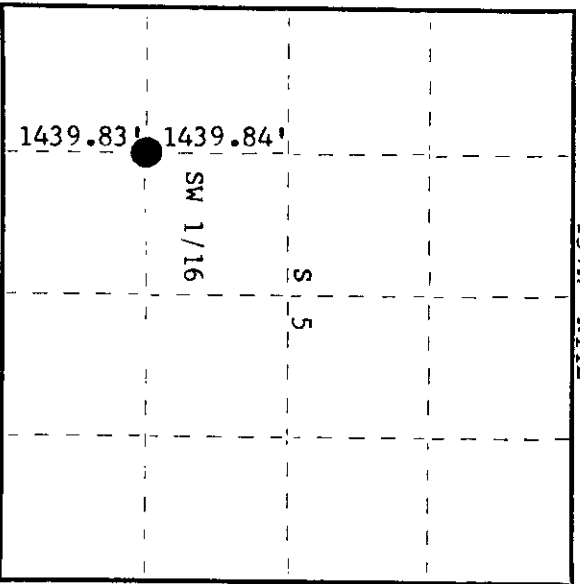

○ = Corner monument restored.

Dated at Rhineland, Wis., this 25th day of February, 1980

Signature Phillip T. Hansen Title Registered Land Surveyor Registration No. S-498  
(County Surveyor, Registered Land Surveyor, or other duly authorized official)

Office of Register of Deeds, County of Oneida, I hereby certify that the within instrument was filed in this office for record on the 16th day of March, 1980 at 9:18 o'clock A. M.

Doris Leverage Funder  
(Register of Deeds)

By: \_\_\_\_\_ Deputy

3711051030