

CERTIFIED LAND CORNER RESTORATION

Index No. C-6

State of Wisconsin

County of Oneida } ss.

History of original corner establishment:  
No records of any corner established.

I, Philip T. Hansen, do hereby certify that on the 18th day of January, 1980, I ~~renewed~~ established ~~the~~ WC 1/16 corner of Section 5, Township 37, Range 11, East, Fourth Principal Meridian, as described hereon; and that from this evidence I established a new monument and accessories as described hereon to perpetuate the original location of this corner.

Resident witnesses:  
Glen Barker  
Jim Claflin  
Herb Wagoner

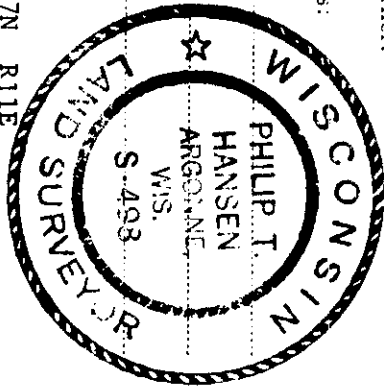

Description of corner evidence found:  
No evidence of any corner recovered. Corner established by traverse and computation. Ran traverse from W 1/4 to E 1/4 and from N 1/4 to S 1/4 to establish the C 1/4. Computed distance from W 1/4 to C 1/4 is 2651.37 feet at bearing N 89° 34' 58" E. Set WC 1/16 at 1325.69 feet intermediate.

Description of monument and accessories I established to perpetuate the original location of this corner.  
Set a 1-1/2" iron pipe with 2" brass cap, stamped: S498  
Monument projects 12". T37N R11E  
Marked NBT's - B. Spruce 6" N18°W 20.78 feet  
B. Spruce 7" S47°E 57.28 feet WC 1/16 S+5  
both scribed 1/16 BT CPI-1980

Dated at Rhineland, Wis., this 28th day of January, 1980

Signature: Philip T. Hansen Title: Registered Land Surveyor Registration No. S-498  
(County Surveyor, Registered Land Surveyor, or other duly authorized official)

Office of Register of Deeds, County of Oneida  
Instrument was filed in this office for record on the 1/14 day of February, 1980 at 2:15 o'clock P.M.

Deena Lange Tucker  
(Register of Deeds)

By: Deputy

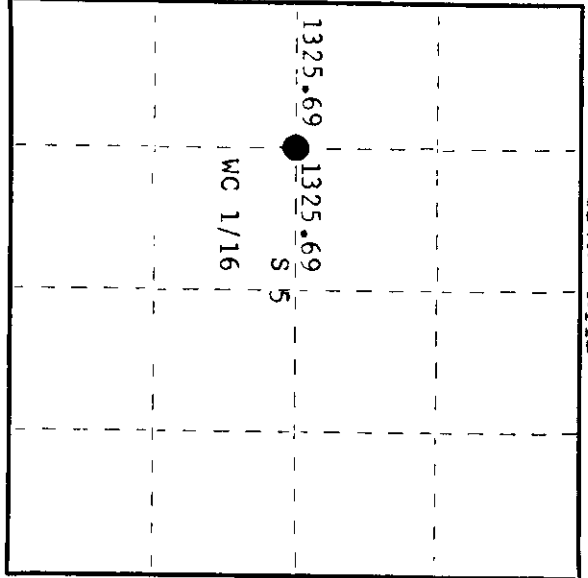

○ = Corner monument restored.

3711052030