

U.S. PUBLIC LAND SURVEY MONUMENT RECORD

Note: This form is intended and designed to fulfill all requirements of Wisconsin Administrative Code, Chapter A-E 5.02, U.S. Public Land Survey Monument Record (3) (a) (b) (c) (d) (e) (f) (g) (h) (i). An additional sheet may be added if necessary to conform with said requirements.

(a) Corner location: Township 37 North
 Range 11 East ~~West~~

Town/Village Piehl
 County Oneida

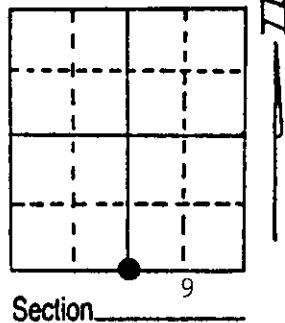

(b) (f) (g) (h) Description of monument found at this corner and if it was accepted, state all evidence (material, testimonial, occupational, plats, records, other monuments) used as a basis for accepting. If not accepted or if nothing was found, state evidence used as basis for establishing location. If reestablished through lost corner proportionate methods, indicate all monuments, distances and directions used to establish. Original corner established by Wm. E. Dougherty, Deputy Surveyor in 1859, from which aspen 12" bears N37W 21 lks and aspen 15" bears S25W 20 lks. In 1948 H.C. Lawrence recovered old cedar post. Replaced old post with a 5" x 5" scribed cedar post.

On April 13, 1987 recovered Lawrence's cedar post scribed 1/4S, S16, S9 in fair condition. No record of BT's or any that were visible. Accepted quarter corner position and replaced post with Oneida County Monument.

(See Back)

(c) (d) (e) Plan view of corner with ties to at least 4 witness monuments. If in disagreement with previously established corner, show the distances between the two corners and also indicate the ties to the disputed corner.

2-1/4" Aluminum Oneida Co. Monument

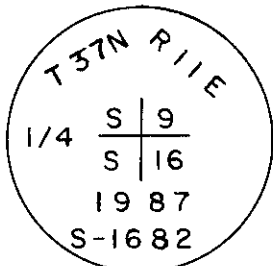

Magnet in base

REGISTER OF DEEDS OFFICE
 ONEIDA COUNTY, WIS.
FILED
 JUL 23 1987
 At 8:00 O'Clock M
 DORIS VERAGE KUEHN
 REGISTER OF DEEDS

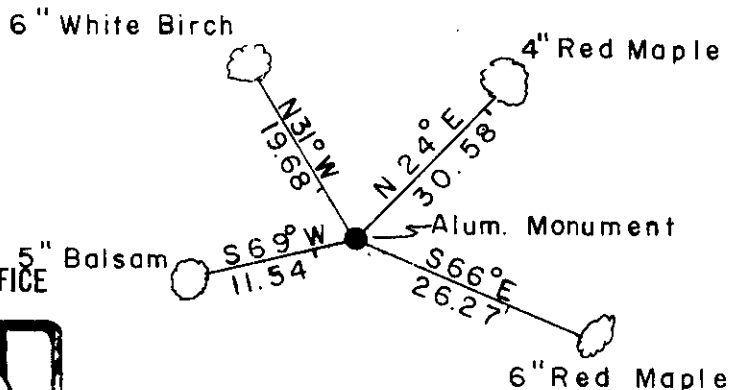

(i) I, Glen Barker
 (type or print name) certify that the corner location on this record was determined by me or under my direction and control and that this U.S. Public Land Survey Monument Record is correct and complete to the best of my knowledge and belief.

Glen Barker Signature 7/7/87 Date

Index No. 5-11

3711090020

