

U.S. PUBLIC LAND SURVEY MONUMENT RECORD

Note: This form is intended and designed to fulfill all requirements of Wisconsin Administrative Code, Chapter A-E 5.02, U.S. Public Land Survey Monument Record (3) (a) (b) (c) (d) (e) (f) (g) (h) (i). An additional sheet may be added if necessary to conform with said requirements.

(a) Corner location: Township 37 North
 Range 11 East/West

Town/City/Village Piehl
 County Oneida

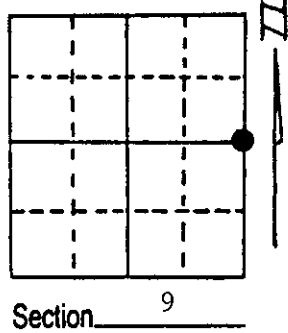

(b) (f) (g) (h) Description of monument found at this corner and if it was accepted, state all evidence (material, testimonial, occupational, plats, records, other monuments) used as a basis for accepting. If not accepted or if nothing was found, state evidence used as basis for establishing location. If reestablished through lost corner proportionate methods, indicate all monuments, distances and directions used to establish. Original corner established by Wm. E. Dougherty, Deputy Surveyor in 1859, from which spruce 9" bears S75E 15 lks and spruce 8" bears N70W 10 lks.

In 1892 James Donally recovered original 1/4 corner position. Marked NBT hemlock 10" N46E 8-1/2 lks. In 1910 J.A. Melendy recovered same, set new post. In 1935 V.A. Maine recovered same, set 2-1/2" iron pipe with brass cap.

On April 13, 1987 recovered J.A. Melendy's old 3"x3' squared and scribed post, also V.A. Maine's 2-1/2" iron pipe with brass cap. Recovered decayed stump of hemlock 10" N46E 8-1/2 lks. J.A. Melendy's survey of 1910 had a distance from 1/4 corner between sections 9 & 10 to section corner 3-4-9-10 of 2728.11'. Resurvey has 2727.61'.

Left wood post and monument as found.

(SEE BACK)

(c) (d) (e) Plan view of corner with ties to at least 4 witness monuments. If in disagreement with previously established corner, show the distances between the two corners and also indicate the ties to the disputed corner.

2-1/2" I.P. - B.C.

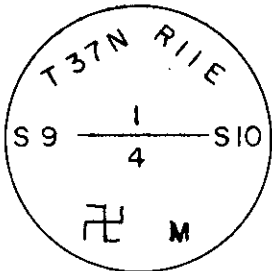

REGISTER OF DEEDS OFFICE
 ONEIDA COUNTY, WIS.
FILED
 JUL 23 1987
 At 8:00 O'Clock M
 DORIS VERAGE KUEHN
 REGISTER OF DEEDS

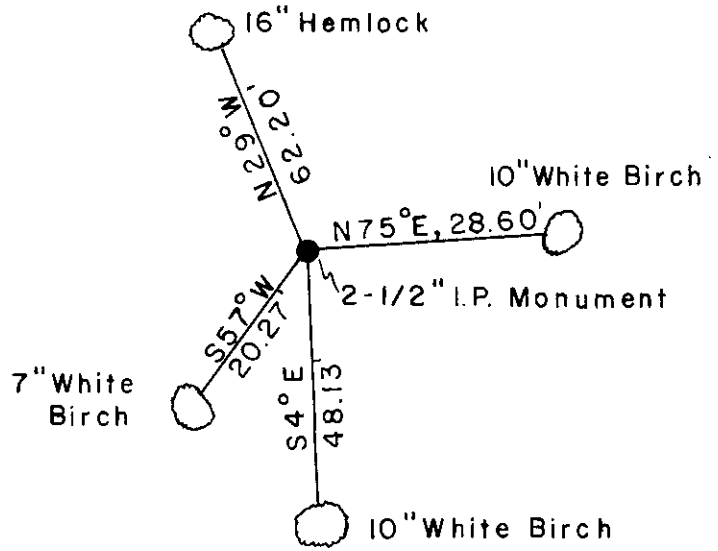

(i) I, Glen Barker
 (type or print name) certify that the corner location on this record was determined by me or under my direction and control and that this U.S. Public Land Survey Monument Record is correct and complete to the best of my knowledge and belief.

Glen Barker Signature 7/7/87 Date



3711092000

Index No. G-13

