

CERTIFIED LAND CORNER RESTORATION

Index No. E-17

State of Wisconsin

County of Oneida } ss.

I, Philip T. Hansen, do hereby certify that on the 16th day of October, 1975, I found evidence of the N 1/16 corner of Sections 10 and 11 Township 37, North, Range 11 East, Fourth Principal Meridian, as described hereon; and that from this evidence I established a new monument and accessories as described hereon to perpetuate the original location of this corner.

Resident witnesses:

Glen Barker

Jim Clafin

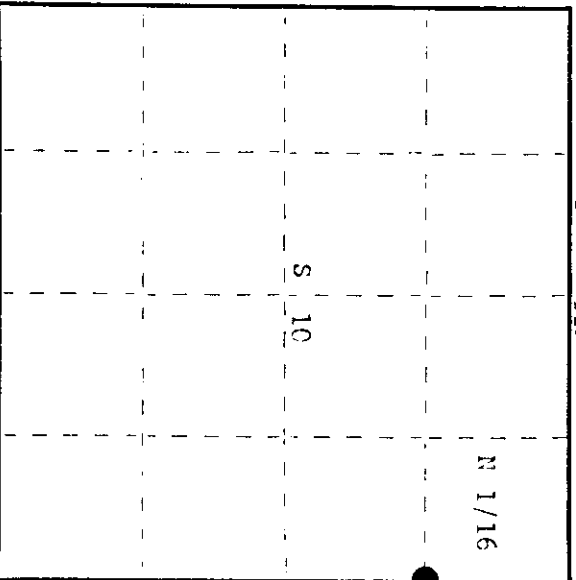
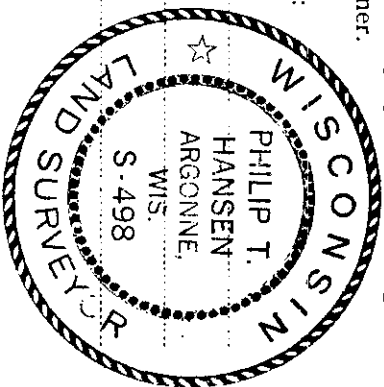

O = Corner monument restored.

CERTIFIED LAND CORNER RESTORATION

History of original corner establishment:

Original corner established by J.J. Melendy. Set cedar post and marked NBT - Birch 7" S35°E 10-1/2 links. Corner recovered by H.C. Lawrence, Registered Land Surveyor. Found Melendy's post and stump of birch 7" S35°E 10-1/2 links. Set new post.

Description of corner evidence found:

Recovered Lawrence's 4" squared cedar post, scribed N 1/16 S11, W 1/16 S10, in poor condition. No evidence of the birch BT.

Description of monument and accessories I established to perpetuate the original location of this corner.

Replaced Lawrence's 4" cedar post with 1-1/2" iron pipe with 2" brass cap, stamined: Placed the wood post beside our iron monument. Marked NBT - Cedar 9" N53°W 89 links, scribed 1/16 BT. No other trees suitable for BT.

T37N R11E
N 1/16 S10 + S11
S498

Dated at Rhinelander, Wis., this 12th day of November, 1979

Signature Philip T. Hansen Title Registered Land Surveyor Registration No. S-498
(County Surveyor, Registered Land Surveyor, or other duly authorized official)

Office of Register of Deeds, County of Oneida, I hereby certify that the within instrument was filed in this office for record on the 17th day of December, 1979 at 1:30 o'clock P.M.

Dorcas George Finkler
(Register of Deeds)

By: Deputy

3711103000

CERTIFIED LAND CORNER RESTORATION

Index No. **F-17**

State of Wisconsin } ss.
 County of Oneida }

History of original corner establishment: Original corner established by J.A. Melendy, Gagen Lumber Company surveyor, in 1910. Birch 7" S35°E 10-1/2 links.

I Philip T. Hansen, do hereby certify that on the 16th day of October, 1975, I found evidence of the N-1/16 corner of Sections 10 and 11 Township 37 North, Range 11 East, Fourth Principal Meridian, as described hereon; and that from this evidence I established a new monument and accessories as described hereon to perpetuate the original location of this corner.

Corner re-established by H.C. Lawrence, Registered Land Surveyor, in 1960, during his retracement and subdivision survey. From 1/4 corner restored between Sections 10 and 11, he ran North 49°W 43.12 chains to a point 12 links east of section corner. Set N-1/16 corner at 21.56 chains equidistant and 6 links west.

No trees close for BT's.

Description of corner evidence found: Recovered 5" cedar post, squared and scribed N-1/16 Section 10, N-1/16 S11, in fair condition.

No BT's were recovered.

Resident witnesses:

Glen Barker
 Jim Clafflin

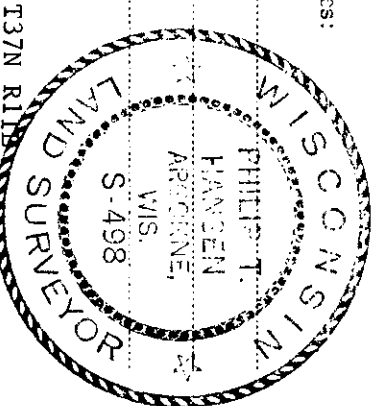

Description of monument and accessories I established to perpetuate the original location of this corner:
 Replaced 5" cedar post with 1" O.D. iron pipe w/2" brass cap stamped -

NBT - Cedar 9" N53°W 89 links scribed 1/16 BT.

No other trees near for BT's.

Post and BT's painted blue.

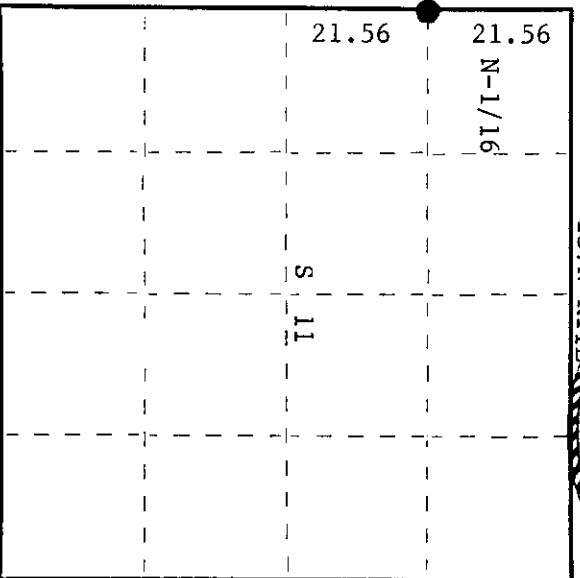
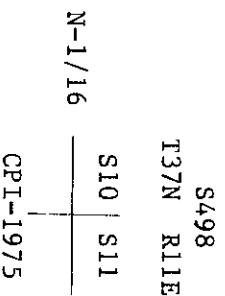

○ = Corner monument restored.

Dated at Rhinelander, Wis., this 22nd day of October, 1975

Signature *Philip T. Hansen* Title Registered Land Surveyor Registration No. S-498
 (County Surveyor, Registered Land Surveyor, or other duly authorized official)

Office of Register of Deeds, County of Oneida
 Instrument was filed in this office for record on the 5th day of December, 1975
 at 10:00 o'clock A.M.

James W. Berger
 (Register of Deeds)

By _____ Deputy

37 1103000