

CERTIFIED LAND CORNER RESTORATION

Index No. **F-18**

State of Wisconsin }
 County of Oneida } ss.

I Phillip T. Hansen, do hereby certify that on the 15th day of October, 1975, I found evidence of the NW-1/16 corner of Section 11

Township 37 North, Range 11 East, Fourth Principal Meridian,

as described hereon; and that from this evidence I established a new monument and accessories as described hereon to perpetuate the original location of this corner.

Resident witnesses:

Glen Barker

Jim Claflin

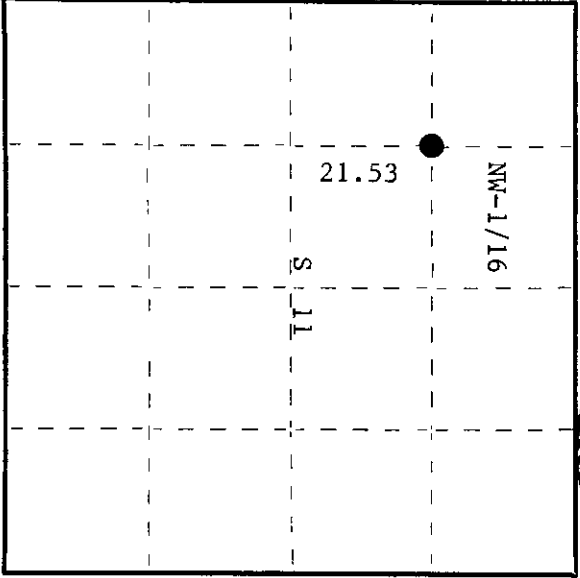
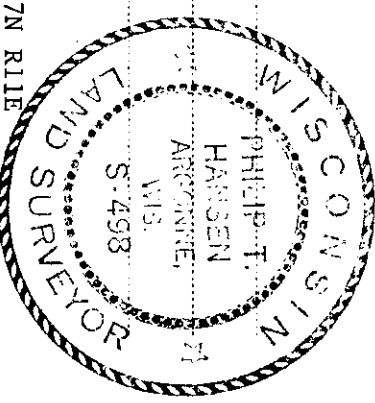

History of original corner establishment: Corner established by H.C. Lawrence, Registered Land Surveyor, in 1960, during his retracement and subdivision survey.

He ran line N4°00'W from WC-1/16 corner a distance of 43.07 chains, intersected the line between Sections 2 and 11, 1.32 chains east of W-1/16 corner. Set NW-1/16 at 21.53 chains north of WC-1/16 and 66 links west. Established white birch 7" N70°W 13 links and balsam 6" N56°E 19 links.

Description of corner evidence found: Recovered 4" cedar post, squared and scribed NW-1/16 S11, NW-1/16 S11, in poor condition.

Recovered OBT's - White birch 7" (8") N70°W 13 links scribed NW-1/16 BT.
 Balsam 6" (7") N56°E 19 links scribed S11 BT.

Description of monument and accessories I established to perpetuate the original location of this corner.
 Replaced 4" cedar post with 1" O.D. iron pipe w/2" brass cap stamped -

Post projects 18" above ground.

NBT - Cedar 7" N72°E 59.7 links scribed 1/16 BT.

Post and BT's painted blue.

S498
 T37N R11E
 NW-1/16
 S 11
 CPI-1975

Dated at Rhineland, Wis., this 22nd day of October, 1975.

Signature *Phillip T. Hansen* Title Registered Land Surveyor Registration No. S-498
 (County Surveyor, Registered Land Surveyor, or other duly authorized official)

Office of Register of Deeds, County of Oneida
 Instrument was filed in this office for record on the 5th day of December, 1975.
 at 12:10 o'clock P.M.

Arnie J. Agee, Jr.
 (Register of Deeds)

By Deputy

371113030

CERTIFIED LAND CORNER RESTORATION

Index No. 7-18

State of Wisconsin

County of Oneida } ss.

I, Phillip T. Hansen, do hereby certify that on the 15th day of October, 1975, I found evidence of the NW 1/16 corner of Section 11 Township 37, North, Range 11 East, Fourth Principal Meridian, as described hereon; and that from this evidence I established a new monument and accessories as described hereon to perpetuate the original location of this corner.

Resident witnesses:

Glen Barker

Jim Clafflin

T37N R11E

History of original corner establishment:
Original corner established by H.C. Lawrence, Registered Land Surveyor, in 1960. Ran random line North 4° W from WC 1/16, 43.07 chains to close out 1.37 chains east of Melendy's W 1/16 corner. Corrected bearing N 5° 45' W. Set NW 1/16 at 21.53 chains and 66 links west. Set new post and marked NPT's - White Birch 7" N70°W 13 links and Palsam 6" N56°E 19 links.

Description of corner evidence found:

Recovered 4" squared cedar post, scribed NW 1/16 S11, NW 1/16 S11 in poor condition.
Recovered OBT's -
White Birch 7" (8") N70°W 13 links, scribed NW 1/16 BT
Palsam 6" (7") N56°E 19 links, scribed S11 RT.

Description of monument and accessories I established to perpetuate the original location of this corner.
Replaced Lawrence's cedar post with 3/4" iron pipe with 2" brass cap, stamped:
Marked NBT - Cedar 7" N72°E 59.7 links, scribed 1/16 BT.
Monument projects 18" above ground.

T37N R11E
NW 1/16 S11
S498

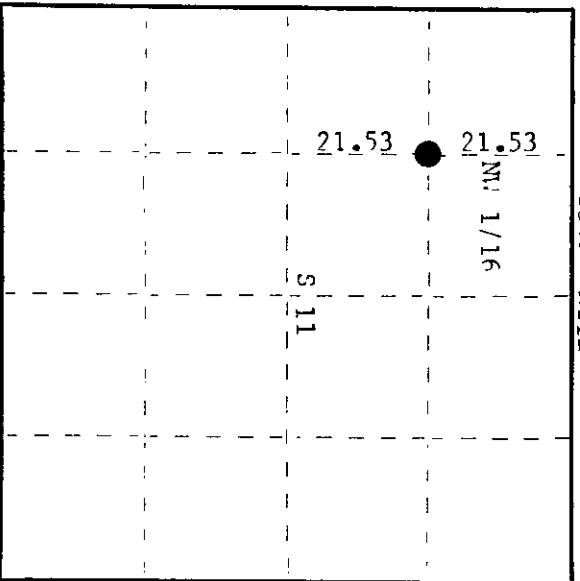

○ = Corner monument restored.

Dated at Rhineland, Wis., this 12th day of November, 1979

Signature Phillip Hansen Title Registered Land Surveyor Registration No. S-498
(County Surveyor, Registered Land Surveyor, or other duly authorized official)

Office of Register of Deeds, County of Oneida
Instrument was filed in this office for record on the 3rd day of December, 1979
at 11:50 o'clock P. M.

Donis Savage Kuehn
(Register of Deeds)

By Donis Savage Kuehn Deputy

37113030